

Center of Section 16 T.21N. R.87W

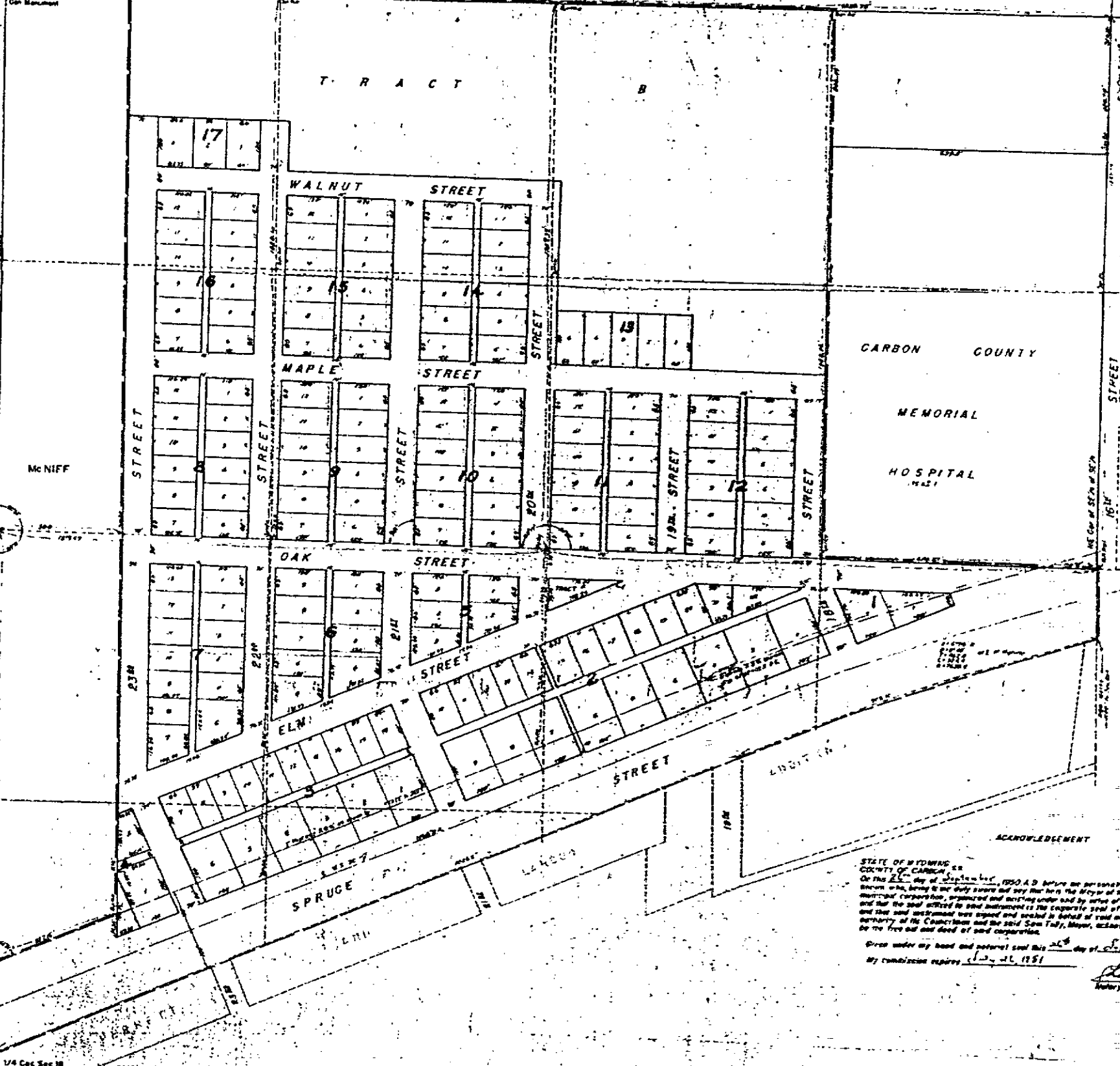

ACKNOWLEDGEMENT
STATE OF WYOMING
COUNTY OF CARBON
On this 23rd day of September, 1950 A.D. before me personally appeared Sam Tully, Mayor of the City of Rawlins, Wyoming, known to me to be the duly authorized and acting Mayor of the City of Rawlins, Wyoming, and that the seal attached to said instrument is the corporate seal of said municipal corporation and that said instrument was signed and sealed in behalf of said municipal corporation by authority of its Council and the said Sam Tully, Mayor, acknowledged said instrument to be the free act and deed of said corporation.
Given under my hand and natural seal this 23rd day of September, 1950 A.D.
My commission expires 12-31-1951
John L. Steiner
Notary Public

DEDICATION:
KNOW ALL MEN BY THESE PRESENTS, That the CITY OF RAWLINS, a Wyoming municipal corporation, the sole owner and proprietor of the real estate shown on this map and plat, and hereunto fully described here and set out, and by these presents do hereby set out and give the said real estate under the name of HAYES-HOPKINS ADDITION to the CITY OF RAWLINS, in the County of Carbon, State of Wyoming, being Block 1, Lots 1 through 3, both inclusive, Block 2, Lots 1 through 3, both inclusive, Block 3, Lots 1 through 3, both inclusive, Block 4, Lots 1 through 3, both inclusive, Block 5, Lots 1 through 3, both inclusive, Block 6, Lots 1 through 3, both inclusive, Block 7, Lots 1 through 3, both inclusive, Block 8, Lots 1 through 3, both inclusive, Block 9, Lots 1 through 3, both inclusive, Block 10, Lots 1 through 3, both inclusive, Block 11, Lots 1 through 3, both inclusive, Block 12, Lots 1 through 3, both inclusive, Block 13, Lots 1 through 3, both inclusive, Block 14, Lots 1 through 3, both inclusive, Block 15, Lots 1 through 3, both inclusive, Block 16, Lots 1 through 3, both inclusive, Block 17, Lots 1 through 3, both inclusive, Tracts A and B, and the streets and alleys included in the description hereinafter set out, and that the City of Rawlins, Wyoming, does hereby dedicate to the use of the public all streets and alleys shown on this map and plat.
The boundaries of the City of Rawlins, Wyoming, as shown on this map and plat, are described as follows: Beginning at a point that is 300 feet East from the corner of Section 16, Township 21 North, Range 87 West of the 6th P.M., along the running East and West through said Sec. 16; thence, East along said center line to the SE corner of the NE 1/4 of the SE 1/4 of said Sec. 16; thence, South along the center line of said Sec. 16 to the SE corner of the SW 1/4 of the NE 1/4 of the SE 1/4 of said Sec. 16; thence, East along the South line of said NE 1/4 of the SE 1/4 of the SE 1/4 of said Sec. 16 to a point that is 200 feet East from the SE corner of said Sec. 16; thence, South westerly a distance of 308.32 feet on a 0°46' curve and a distance of 882.5 feet bearing S 60° 27' 10" E, along the North line of the Parcel B L. Truse Ltd. 322.36 feet; thence, North along a line that is parallel to and 300 feet East of the N-S center line of said Sec. 16 to the point of beginning, containing 0.27 acres more or less, as appears on this map and plat and that the above described Addition is plotted and laid out with the due regard and in accordance with the desire of the undersigned owner and proprietor.
IN WITNESS WHEREOF, the said CITY OF RAWLINS, by authority of its Council and its Mayor, and its corporate seal to be hereunto set, and attested by Gary Chris Suttan, its Clerk, this 23rd day of September, 1950.

HAYES-HOPKINS ADDITION

TO THE CITY OF RAWLINS, WYOMING

ENGINEER'S CERTIFICATE:
I, W.M. ALAN, a Licensed Engineer in the State of Wyoming, do hereby certify that the survey of the portion of Section 16, T.21N., R.87W., shown hereon was made under my direction and that this plat is a correct delineation of said survey.
Witness my hand and seal this 23rd day of September, 1950.

RECORDERS CERTIFICATE:
STATE OF WYOMING
COUNTY OF CARBON
I hereby certify that this instrument was filed for record in my office of _____ on the _____ day of _____ A.D., 1950, and is duly recorded in Book _____, Page _____.
Instrument No. 2828
John L. Steiner
County Clerk of Carbon County, Wyoming

SEPTEMBER, 1950

SCALE - 1

