

PLAN OF RIVERSIDE, WYOMING

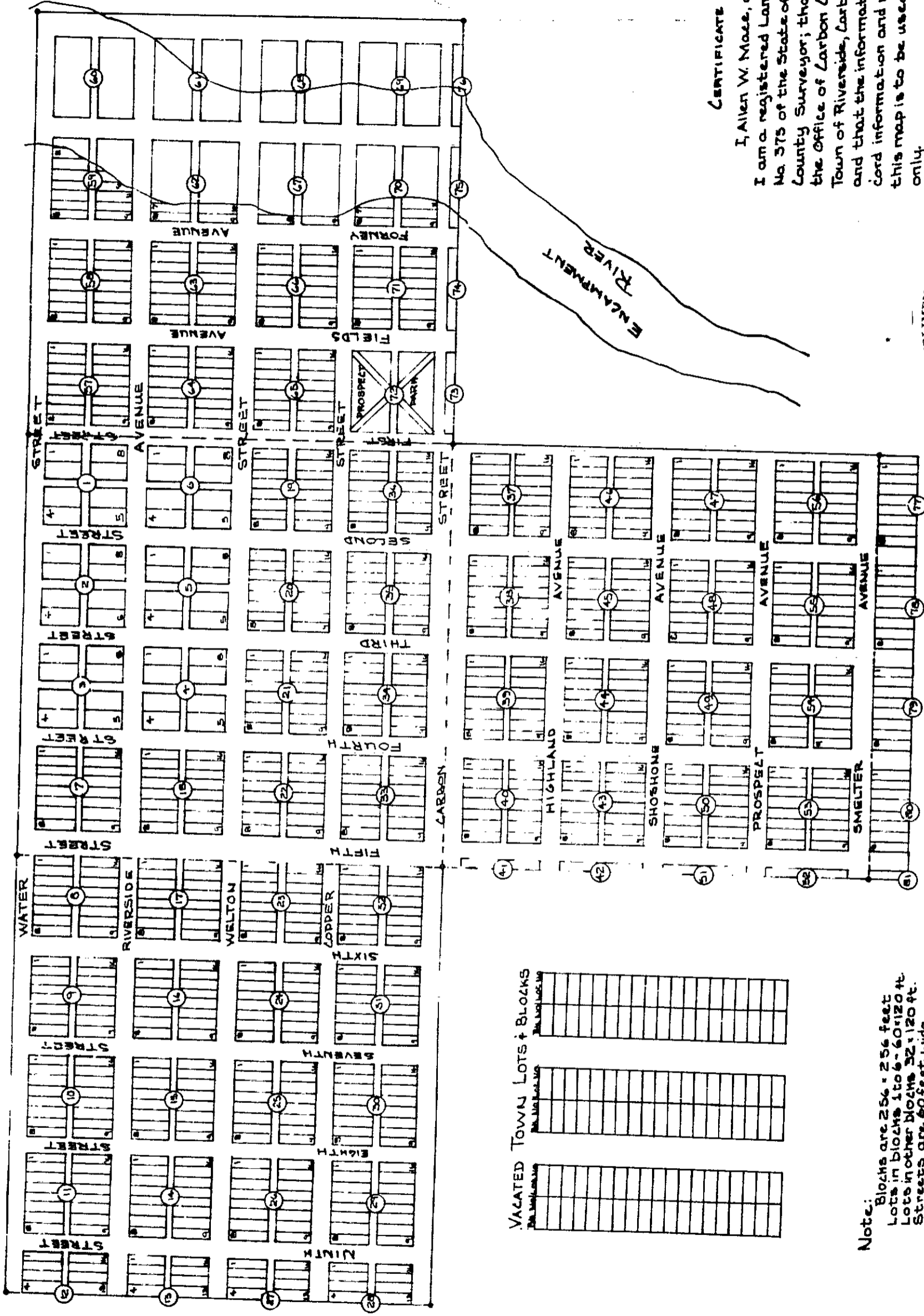

CERTIFICATE OF SURVEYOR

I, Allen W. Mace, do hereby certify that I am a registered Land Surveyor, registration No. 375 of the State of Wyo.; that I am Carbon County Surveyor; that this map was made by the Office of Carbon County Surveyor for the Town of Riverside, Carbon County, Wyoming; and that the information shown hereon is recorded information and not from a field survey. This map is to be used for cadastral purposes only.

Dated this 19th day of June, 1963.



VACATED TOWN LOTS & BLOCKS

Note: Blocks are 256 x 256 feet
 Lots in blocks 1 to 6 - 60 x 120 ft.
 Lots in other blocks 32 x 120 ft.
 Streets are 60 feet wide.
 Alley-ways are 16 feet wide.

Scale Distorted