

NORTH

CERTIFICATE OF SURVEYOR.

STATE OF SOUTH DAKOTA } SS.  
County of Pennington

I, Roy H. Cameron of 3603 Hall St, Rapid City, So. Dakota, hereby certify that this map of the original townsite of ALVA Wyoming was copied from one made by Nils Nilson of a survey he made on June 18, 1910, and from notes taken by me during an actual survey made by me on Sept. 7-9, 1956 of French Addition, of the lots vacated, of the substitute lots 11A-21A of Block I, and of lots 1, 10, 11, 12, 13 of Block II. I set hubs at the corners of the new lots laid out.

Roy H. Cameron  
Surveyor.

Wyoming Certificate No. 32.

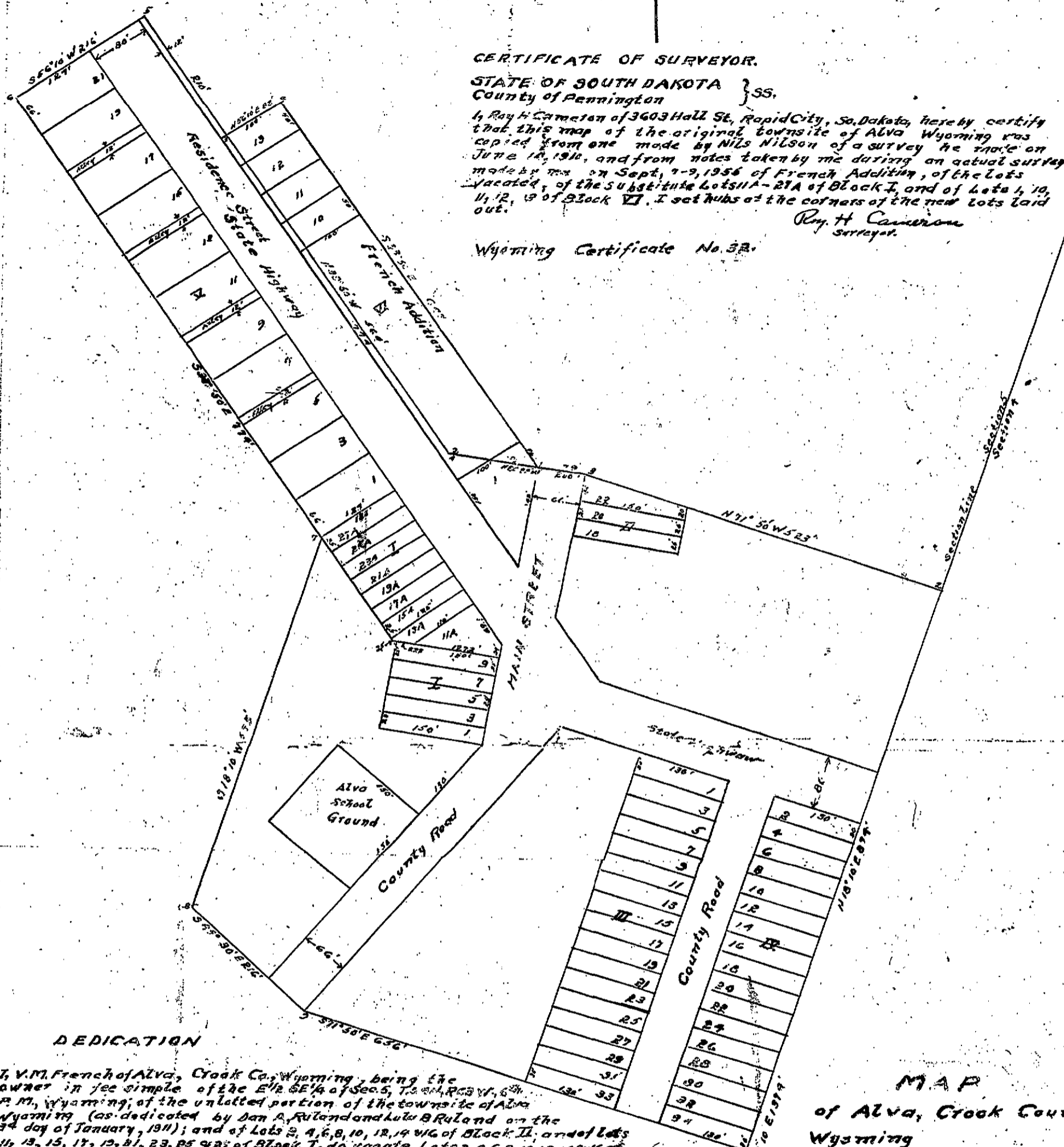

DEDICATION

I, V.M. French of Alva, Crook Co., Wyoming, being the owner in fee simple of the E 1/2 SE 1/4 of Sec. 5, T. 20 N., R. 23 W., 6th P.M., Wyoming; of the unletted portion of the townsite of Alva Wyoming (as dedicated by Dan A. Ruland and Lulu Ruland on the 34 day of January, 1911); and of Lots 2, 4, 6, 8, 10, 12, 14 W 1/2 of Block II, and of Lots 11, 13, 15, 17, 19, 21, 23, 25 1/2 of Block I, do vacate Lots 2, 4, 6, 8, 10, 12, 14 W 1/2 of Block II and Lots 11, 13, 15, 17, 19, 21, 23, 25 1/2 of Block I. I dedicate Main Street to public use. I further dedicate the following tract located in NE 1/4 SE 1/4 of Section 5 - starting at the SE corner of Sec. 5, T. 20 N., R. 23 W., 6th P.M. Wyoming 90 N 18° 10' E 1374 feet along the section line between Secs. 4 & 5 to corner No. 2 of the original townsite; thence 244° 50' W 533 feet along the original townsite line to corner No. 3 of the original townsite; thence 90 N 20° 35' W 79 feet along the original townsite boundary to corner No. 1 of French Add; running thence N 60° 35' W 121 feet along boundary line of original townsite to corner No. 2 of French Add; thence N 33° 50' W 560 feet along original townsite boundary to corner No. 3 of French Add; thence N 50° 15' E 80 feet to corner No. 4 of French Add; thence S 23° 20' E 497 feet to corner No. 1 of French Add, the starting point. Containing 2.26 acres - to be known as the French Addition to the Town of Alva. I have further caused lots 11A, 13A, 15A, 17A, 19A, 21A, 23A, 25A & 27A of Block I and Lots 1, 10, 11, 12 & 13 of Block II to be laid out. I do here by state that the above and foregoing dedication and vacation is with my free consent and in accordance with my desires as the owner of said premises.

V.M. French.  
V.M. French.

MAP  
of Alva, Crook Count  
Wysming

Showing  
Original Townsite After  
Vacation of Lots; French  
Addition and New Lots Laid  
Out.

Scale 1" = 100' February 6, 1956.

V. M. French  
to  
The Public

169976  
STATE OF WYOMING  
COUNTY OF CROOK }  
This instrument was filed for record at 9:30  
o'clock P. M., on the 7th  
day of March, A. D. 1956  
in Book of plat  
County Clerk and Recorder  
by Virginia J. Hyde  
Notary Public

THE STATE OF WYOMING }  
County of Crook } SS.  
On this 7 day of March, 1956, before me personally appeared  
V.M. French, to me known to be the person described in and who  
executed the foregoing instrument, and acknowledged that he  
executed the same as his free act and deed, including the release  
and waiver of the right of homestead.  
Given under my hand and notarial seal, the day and year first  
certificates first above written.  
Feb 13, 1956

Francis H. Hester  
County Clerk

6