

**HENDERSON ADDITION**  
**MOORCROFT CROOK Co. WYO**

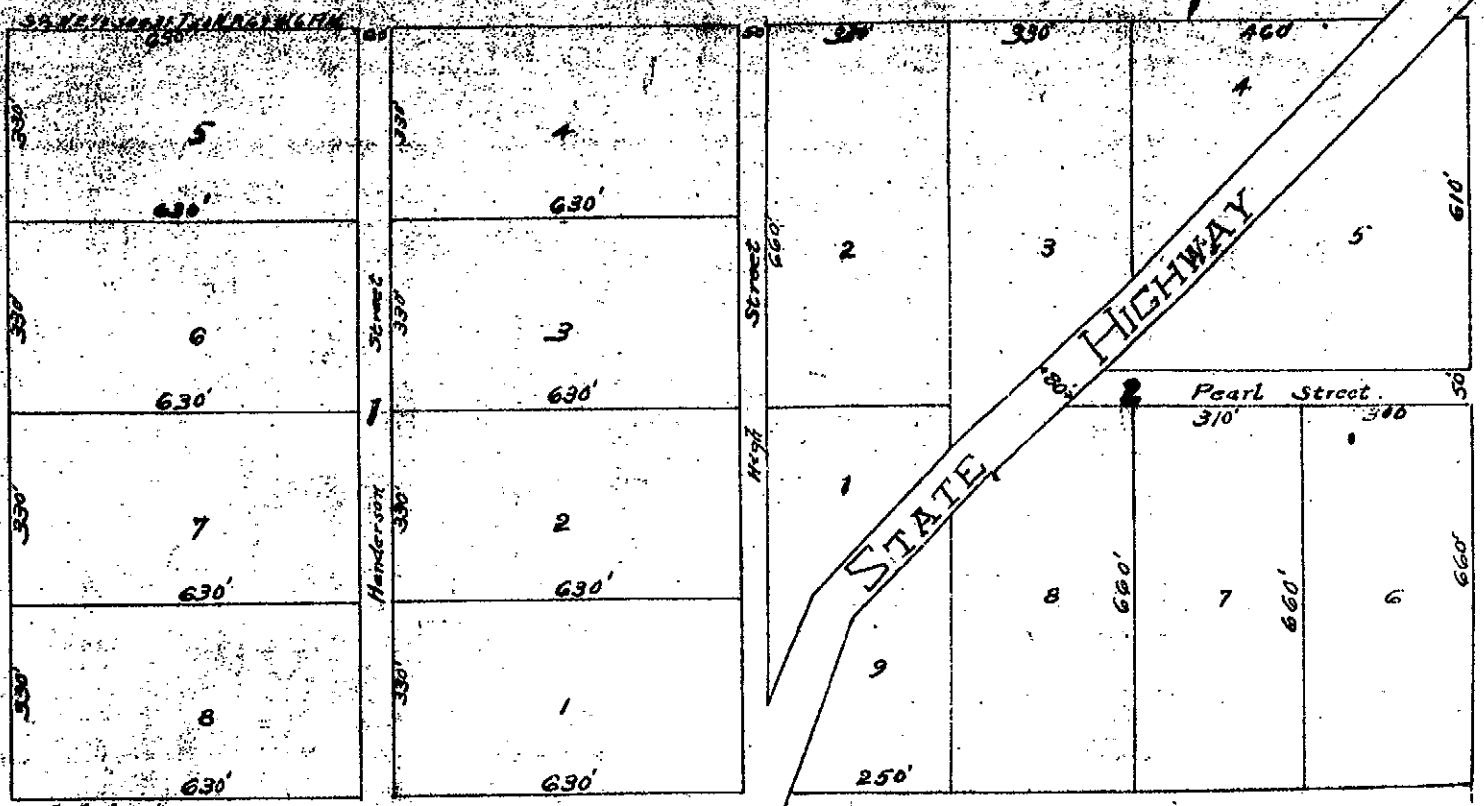

STATE of WYOMING, COUNTY OF CROOK: SS.  
 The above subdivision of the S½ of the NE¼ of section 31,  
 Twp. 50N, R. 67W, G. 11M, as it appears on this plat is with  
 the free consent and in accordance with the desires of  
 the undersigned owner and proprietor.

Acknowledged before me this 15th day of November A.D. 1920  
 James C. Henderson  
 W.F. Leslie  
 Notary Public  
 My commission expires June 27, 1924.

**\* 61769 Surveyor's Certificate.**

I, C.E. Russell, hereby certify that on the 10th day of  
 September A.D. 1920 I surveyed the Henderson Addition to  
 Moorcroft, Crook Co., Wyoming, which comprises the South  
 half of the Northeast quarter of section Thirty one (31) Township  
 Fifty (50) North of Range Sixty seven (67) West of the Sixth  
 Principal Meridian, and more particularly described as  
 follows:

Commencing at a point 2640 feet north of government  
 rock at Southeast corner of said Section Thirty-one (31) thence  
 running West at right angles 2640 feet, thence North 1320 feet,  
 thence East 2640 feet thence South 1320 feet to point of starting.  
 That the accompanying map was made from notes taken during  
 said survey drawn to a scale of 200 feet to an inch on which  
 are indicated in figures the width of streets and dimensions  
 of lots in feet, each lot and block bears its own number. That  
 oak or pine stakes are driven well into the ground at front  
 corners of each lot.

Witness my hand this 12th day of November A.D. 1920  
 C.E. Russell  
 Surveyor

Dedication of Plat of Henderson Addition  
 to the Town of Moorcroft, Crook Co., State of  
 Wyoming.  
 This certifies that James C. Henderson  
 is the owner in fee of the south half of the  
 northeast quarter (S½ of the NE¼) of Section thirty-  
 one (31) in Township fifty (50) North of Range  
 sixty seven (67) West of the Sixth (67) Principal  
 Meridian, in the County of Crook, State of  
 Wyoming, upon which the Henderson Addition to  
 the Town of Moorcroft has been surveyed and  
 located as indicated by the accompanying plat  
 and surveyor's certificate.

That said owner has caused said land to  
 be surveyed and platted as said addition  
 to said town as indicated by the said plat  
 and Surveyor's Certificate; that the streets,  
 avenues and alleys shown by said plat  
 and mentioned in the said Surveyor's Certifi-  
 cate are hereby dedicated to the public use.

IN WITNESS WHEREOF, the said James  
 C. Henderson has hereunto subscribed his  
 hand this 15th day of November, A.D. 1920.

Witness:  
 Gerald J. Traker  
 Harold R. Demarbre  
 James C. Henderson

State of Wyoming }  
 County of Crook } ss.  
 I, W.F. Leslie, a Notary  
 Public within and for the county and  
 State aforesaid, do hereby certify that James  
 Henderson, who is personally known to me

dedication, appeared before me  
 this day in person and acknowledged  
 that he signed the same as his free  
 and voluntary act and deed, and for  
 the uses and purposes therein set  
 forth.  
 Given under my hand and notarial  
 seal this 15th day of November A.D. 1920.  
 W.F. Leslie  
 Notary Public  
 My commission expires June 27, 1924.

# 61760

Moulton  
 19th  
 26  
 1924  
 E. H. Clarke

For affidavit as to Release of Homestead rights, see Book 18,  
 Page 354.  
 See Resolution No. 14-1924 - Bx 312 p. 23

417