

EAST ADDITION TORRINGTON WYOMING

State of Wyoming
County of Goshen
This instrument was filed for record on the 25th day of June A. D. 1945 at 9:45 o'clock A. M. and is duly recorded in Book _____ on page _____
[Signature]
County Clerk and Ex-Officio Register of Deeds

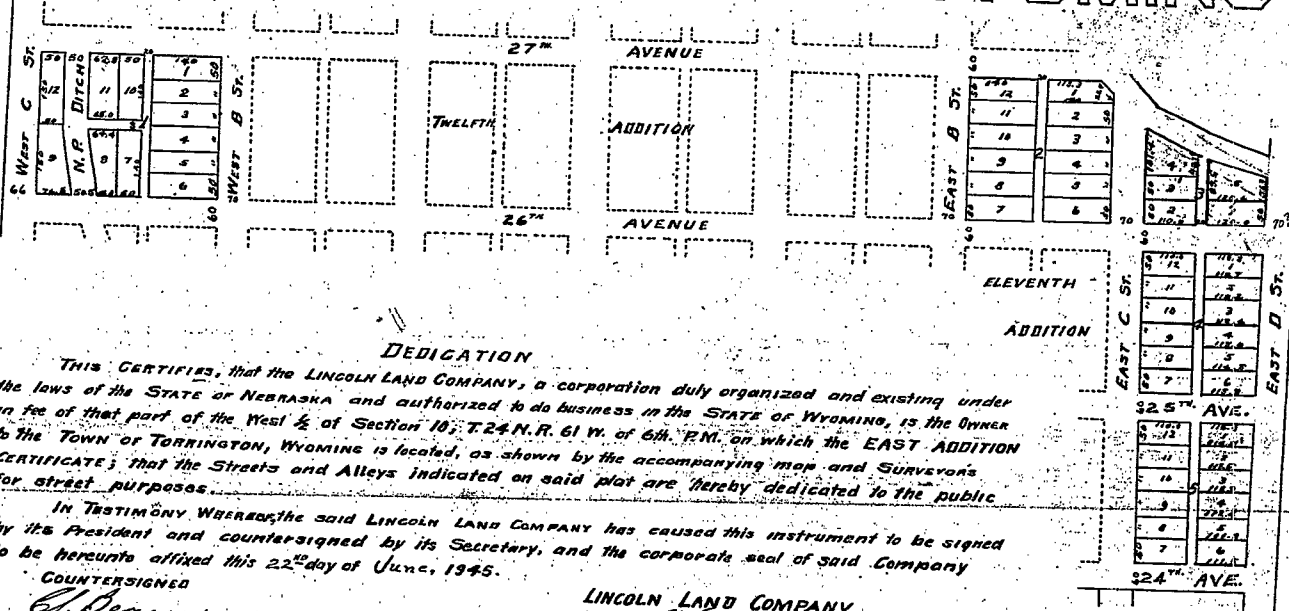

DEDICATION

This certifies that the LINCOLN LAND COMPANY, a corporation duly organized and existing under the laws of the STATE OF NEBRASKA and authorized to do business in the STATE OF WYOMING, is the owner in fee of that part of the West 1/2 of Section 10, T.24 N. R. 61 W. of 6th. R.M. on which the EAST ADDITION to the Town of Torrington, Wyoming is located, as shown by the accompanying map and Surveyor's Certificate; that the Streets and Alleys indicated on said plat are hereby dedicated to the public for street purposes.

In Testimony Whereof, the said LINCOLN LAND COMPANY has caused this instrument to be signed by its President and countersigned by its Secretary, and the corporate seal of said Company to be hereunto affixed this 22nd day of June, 1945.

COUNTERSIGNED
[Signature]
SECRETARY
[Signature]
WITNESS

LINCOLN LAND COMPANY
[Signature]
PRESIDENT

ACKNOWLEDGEMENT

State of Nebraska } ss
County of Lancaster }

On this 22nd day of June, 1945, before me personally appeared W. W. TURNER, to me personally known, who being by me duly sworn, did say that he is President of the LINCOLN LAND COMPANY, and that the seal affixed to said instrument is the Corporate Seal of said Corporation, and that said instrument was signed and sealed in behalf of said Corporation by authority of its Board of Directors, and said W. W. Turner acknowledged said instrument to be the free act and deed of said Corporation.

Witness my hand and Notarial Seal on the day and year last above written. My commission expires Apr. 17th 1947.
[Signature]
Notary Public

SURVEYOR'S CERTIFICATE

State of Wyoming } ss
County of Goshen }

I, Geo. W. Marks, of Torrington, Wyoming do hereby certify that the EAST ADDITION to the Town of Torrington, Wyoming was surveyed by me; that said Addition is located in part of the West Half of Section 10 T.24 N. R. 61 W. of 6th R.M. as shown by annexed map, which is a correct delineation of said survey, drawn to a scale of 200 ft. to the inch. The widths of the streets, avenues and alleys and the dimensions of lots are indicated in feet and decimals thereof on said plat. Each lot and block bears its own number.

[Signature]
Surveyors License No. 143