

State of Wyoming } ss.
County of Goshen }

A.B.Reeves, being first duly sworn according to law says that he is the engineer employed by the Ft.Laramie Cemetery Association to survey the Ft. Laramie Cemetery and that the map of which this affidavit is a part correctly represents the said cemetery with regard to its location, that it is further a correct representation of the lots, blocks, streets, and alleys of said cemetery:

State License No.107 /S/ A.B. Reeves
Engineer

DEDICATION
This is to certify that Fort Laramie Special Cemetery District, a Special Cemetery District duly organized and existing under the laws of the State of Wyoming, is now the owner of the lands originally contained in the Fort Laramie Cemetery as shown by the accompanying plat and surveyor's certificate; that the said owner has caused the same to be platted as part of the Fort Laramie Cemetery.

It is further certified that this is a true copy of the original plat of the Fort Laramie Cemetery which plat is referred to and incorporated into the plat of Fort Laramie Cemetery prepared by J. H. Coffman, Civil Engineer and Land Surveyor in June 1961, July 1962, and July 1968, approved by the Board of County Commissioners of Goshen County, Wyoming.

IN WITNESS WHEREOF the Fort Laramie Special Cemetery District has caused this instrument to be signed by the President and countersigned by the Secretary this 19th day of February, 1977.

FORT LARAMIE SPECIAL CEMETERY DISTRICT
By: Walter E. Enschelak President
Secretary

Subscribed and sworn to in my presence this 20th day of November 1928
My commission expires Dec. 28, 1929.

Notary Public

STATE OF WYOMING } ss.
COUNTY OF GOSHEN }

Acknowledged before me this 19th day of Feb. 1977

My Commission Expires:

Lee M. Enschelak
Notary Public

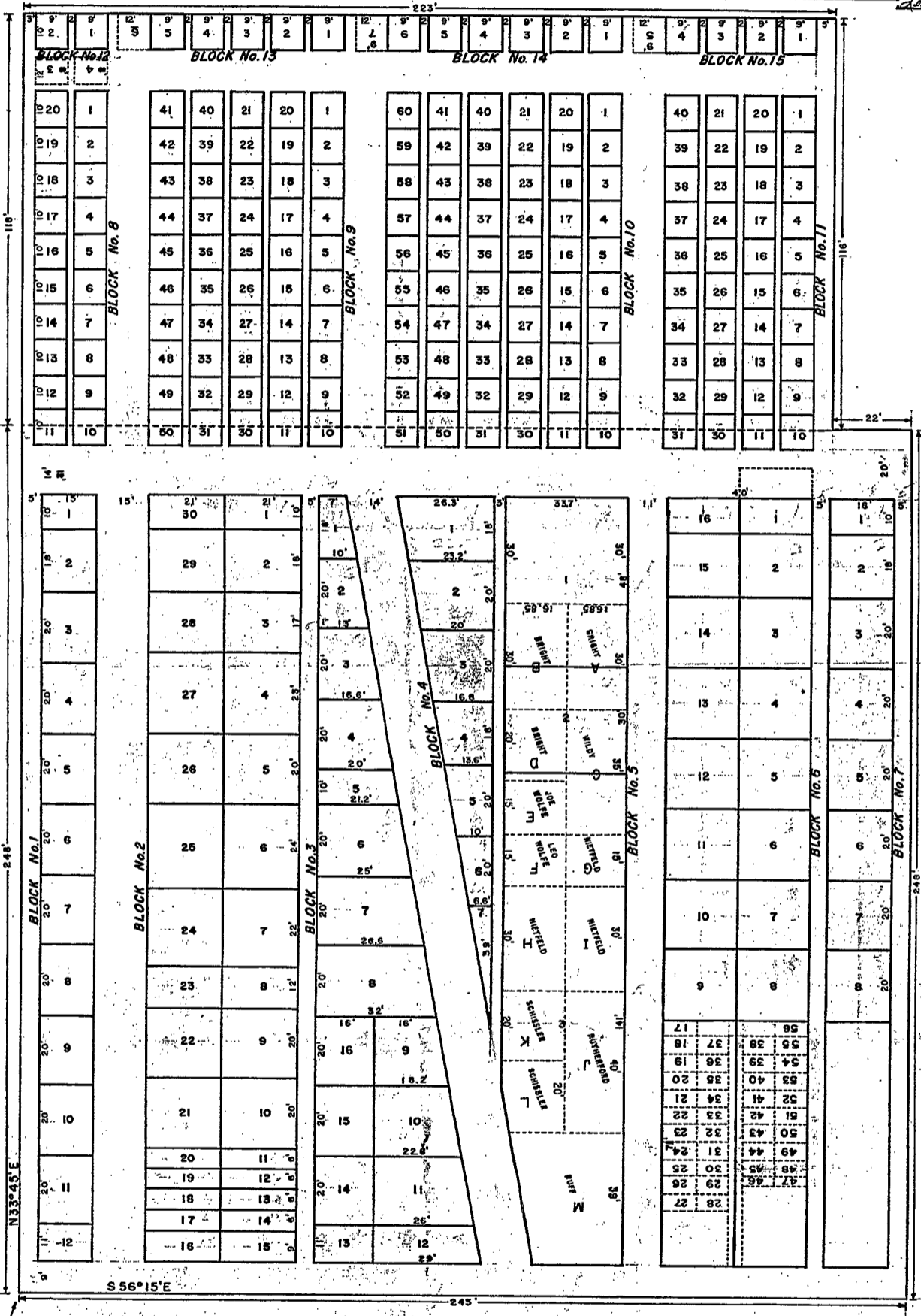

PLAT OF FT. LARAMIE CEMETERY

The duly elected Ft. Laramie Cemetery Board on June 29, 1962, handed me a linen tracing of the Original Ft. Laramie Cemetery prepared in August 1910 by Robert S. Grey, Surveyor, and a faded print showing the original Ft. Laramie Cemetery with additional Blocks and Lots (these additional Lots and Blocks I designate as the First Addition to the Ft. Laramie Cemetery) prepared in November 1928 by A.B. Reeves, Engineer-Surveyor, Wyoming License No. 107. The above mentioned Cemetery Board then instructed me to make this copy of the Reeves Plat. The print by A.B. Reeves has been marked over in ink and pencil by unknown persons and in some cases the dimensions on the Reeves print have been changed. Lots are shown in what Reeves designated as Streets, and cases are found where areas have been subdivided and given Lot numbers. These pencil and ink changes are shown on this map by dotted lines and the numbers can be read from the upper border or left border of this map.

Surveys performed under my personal supervision, indicate that the Ft. Laramie Cemetery as fenced and used does not match either the Grey or Reeves maps, which indicates that the surveys by these men were either ignored or obliterated. The results of my surveys have been reported on separate maps.

J.H. Coffman
Engineer - Surveyor Wyo. Reg. No. 529.

The foregoing Plat of Fort Laramie Cemetery is hereby approved this 19th day of February, 1977.
BOARD OF COUNTY COMMISSIONERS - GOSHEN COUNTY, WYOMING.
By: David Spawm Chairman
County Clerk

N. 1/2 Sec. 15 - 1955 - Grey - 1910 Plat - to separate corner
Reeves 1928 Plat - not entirely legible
S.W. Corner
S. 21, T. 26N., R. 64W.