

11 28 A  
 11 28 A  
 11 28 A

MAP OF THE  
**TOWN OF JAY EM**  
 GOSHEN COUNTY, WYOMING.  
 Scale 200' = 1"

ENGINEER'S CERTIFICATE

STATE OF WYOMING } 55.  
 COUNTY OF LARAMIE }

I, Albert B. Bartlett of Cheyenne, Wyo. hereby certify that this plat of Jay Em was made from field notes of an actual survey made by me on June 30th and July 1st 1919 and that the town of Jay Em is described as follows: - the portion of the SW 1/4 NE 1/4 and the SE 1/4 NW 1/4 of Section 25 T. 29 N. R. 63 W. of the 6th Principal Meridian, as shown on this map. Said survey is perpetuated on the ground by iron hubs set at black corners and at the street intersections as shown by small circles: - Area of platted portion 44.037 acres. The angles were determined from deflections from a true meridian determined by solar observations. The Streets and Avenues are at right angles with each other, running north and south, east and west.

*Albert B. Bartlett*

DEDICATION BY OWNERS

STATE OF WYOMING } 55.  
 COUNTY OF LARAMIE }

Know all men by these presents that the above and foregoing sub-division of the SW 1/4 NE 1/4 and the SE 1/4 NW 1/4 of Section 25, T. 29 N. R. 63 West of the 6th Principal Meridian as described in the foregoing Engineers certificate is made with the free and voluntary consent and in accord with the desires of the undersigned owners and proprietors, and the streets and alleys therein are hereby dedicated to the public use, said sub-division to be known as the town of Jay Em.

Jay Em Cattle Company

*W. J. Harris* Secretary By *Oliver Harris* President

STATE OF WYOMING } 55.  
 COUNTY OF LARAMIE }

I, *Oliver C. Harris* a U.S. Commissioner and for said County and State, do hereby certify that on this 23 day of *Sept* 1919 before me personally appeared *Oliver C. Harris* and *W. J. Harris* who then and there acknowledged that they executed the foregoing instrument as their free and voluntary act and deed.

Witness my hand and seal, this 23 day of *Sept* 1919.  
*Oliver C. Harris*  
 My commission expires *Jan 21, 1922* U.S. Commissioner

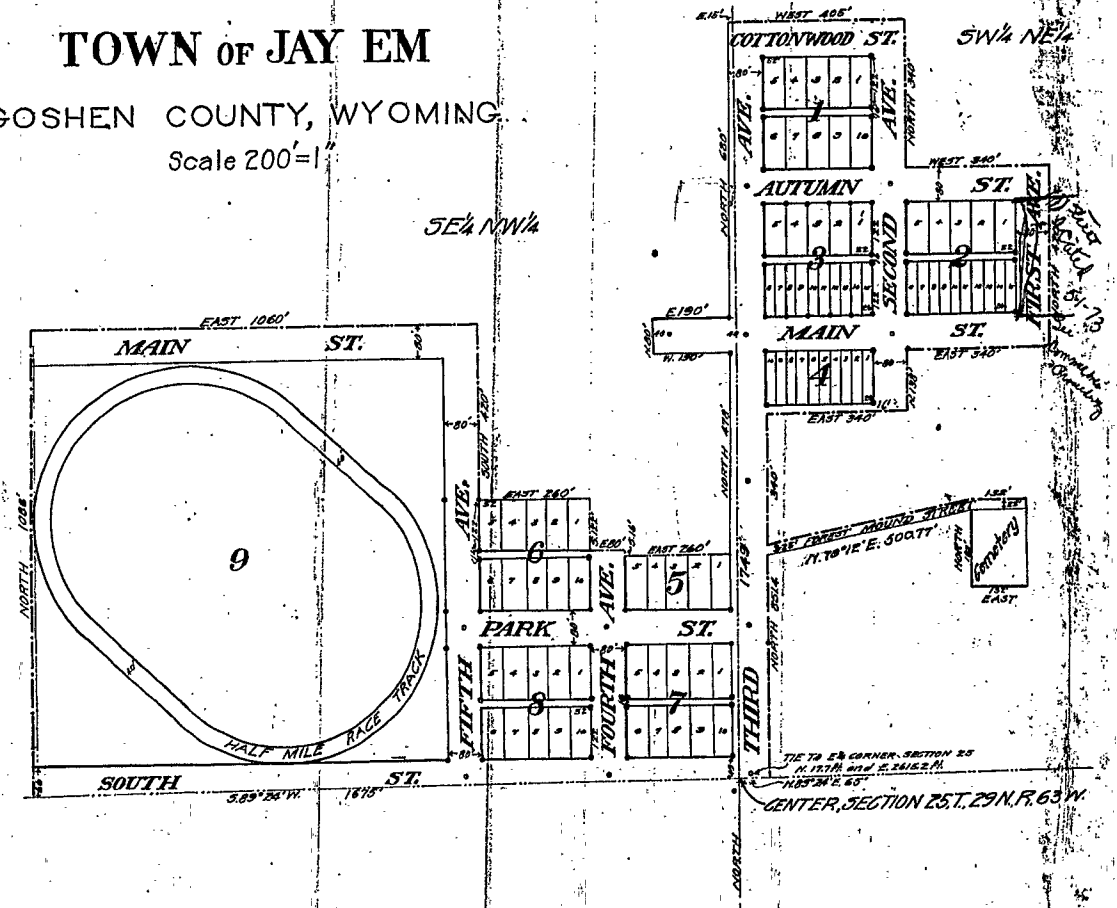

23 11 Sept 1919  
*Nellie Armstrong*  
*Mary Ann Olson*  
 Original filing on record and