

PLAN
NINETEEN TWENTY ADDITION

VALLEY VIEW CEMETERY
TORRINGTON WYOMING

SCALE 1 INCH = 40 FEET

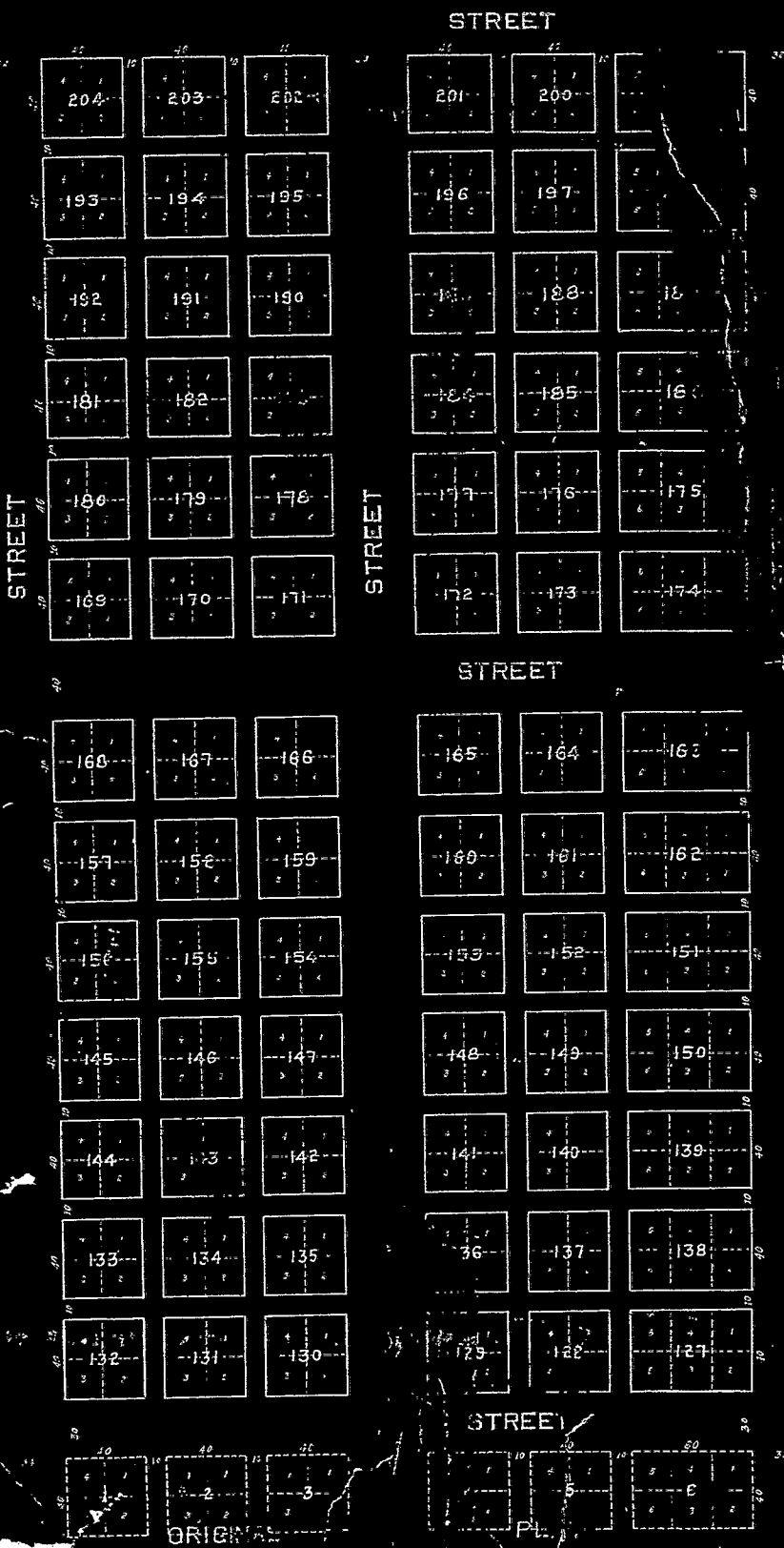

SURVEYORS CERTIFICATE

I hereby certify that, in the month of _____, 1922, I surveyed the NINETEEN TWENTY ADDITION to the VALLEY VIEW CEMETERY at Torrington Wyoming situated in the East Half of the South East Quarter of Section 3 Township 22 North Range 81 West of the 6th P.M. Goshute Co. Wyoming as shown by the annexed plat which is a correct delineation of said survey drawn to a scale of 40 feet to an inch. The streets are continuations of and parallel to those in the Original Plat. White pine stakes are driven well into the ground at the corners of each lot. The plans of streets and walks, also the dimensions of lots are indicated in feet hereof on said plat. Each Lot and Block bears its own number.

License No. 25 Surveyor