

REPLAT OF AIRPORT ADDITION TO THE

CITY OF CHEYENNE

Laramie County
Scales 1-200 August 1935.

ENGINEERS' CERTIFICATE

State of Wyoming }
County of Laramie } ss
I, Z. E. Sweeney, City Engineer, of the City of Cheyenne, Wyoming, hereby certify that this map of Airport Addition to the City of Cheyenne was made from notes taken during an actual survey made under my supervision in August 1935, and that it correctly represents the lot blocks, streets and alleys as marked on the ground by stakes set at the corners to lots, streets, streets and alleys.

Z. E. Sweeney
Engineer

Description
This Airport Addition to the City of Cheyenne, Laramie County, State of Wyoming, embraces all that portion of Section 30, T. 14 N., R. 66 W., and being more particularly described as follows:
Beginning at the 1/4 corner between Sections 30 and 31, T. 14 N., a distance of 1324 feet to a brass cap set in iron pipe; thence S 89° 50' E 1308.52 feet to a brass cap set in iron pipe; thence S 0° 37' E 1354 feet to a brass cap set in iron pipe; thence thence 1324.22 feet to the point of beginning.

Description
Areas all more by these presents, that School District No. 1 of Laramie County, owner of a portion of said Airport Addition herein published and described as an amended plat of said Airport Addition to the City of Cheyenne, does hereby dedicate the streets and ways shown hereon to the use of the public for use authorized by resolution of the Board of Trustees of School District No. 1 of Laramie County, dated 20 September 1935.

By _____
Clerk

State of Wyoming }
County of Laramie } ss
I hereby certify that on the 26th day of September A. D. 1935, before me the undersigned, a Notary Public, Board of Trustees of School District No. 1 of Laramie County, who created the within and foregoing plat and certificate, the said instrument to be their free and voluntary act and deed for the purposes mentioned in the within and foregoing plat and certificate, and that said instrument and certificate were lawfully and lawfully executed and acknowledged.

By _____
Notary Public

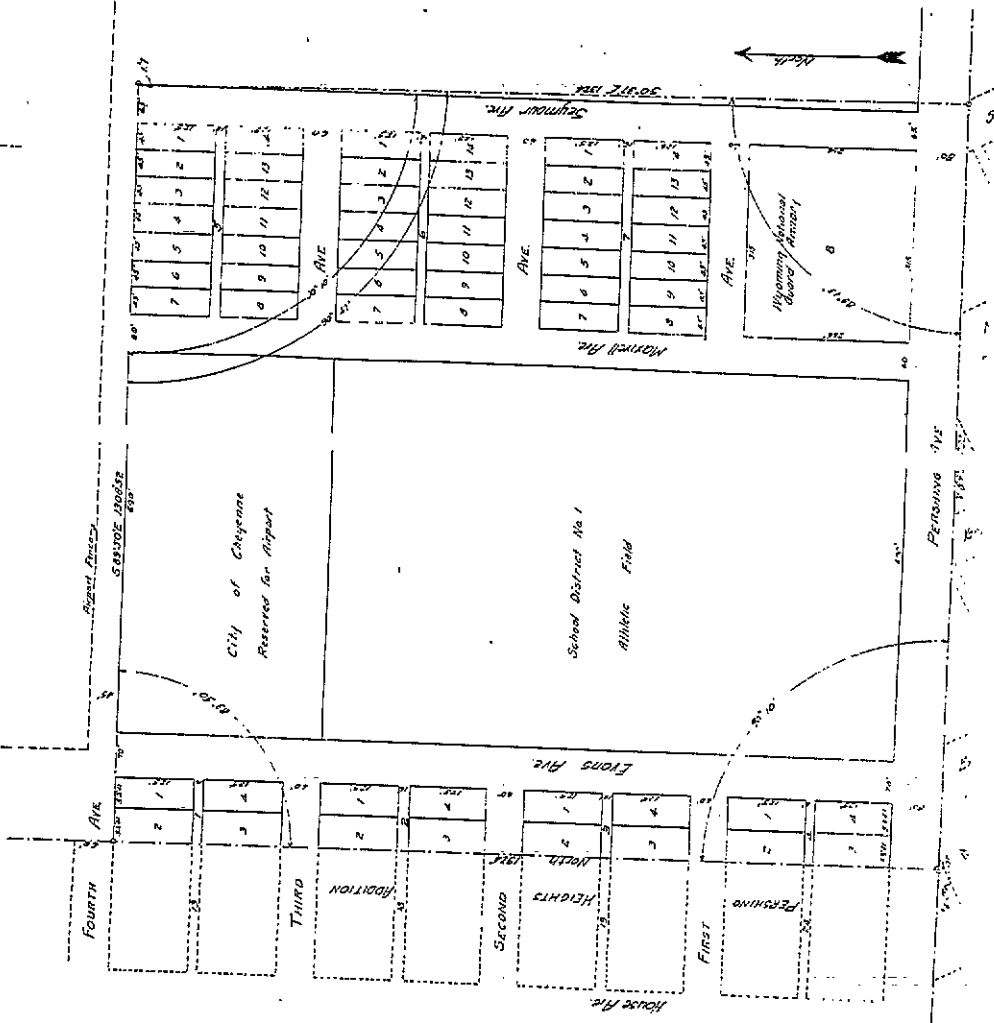

Dedication
Areas all more by these presents, that Cheyenne, owner of a portion of the Airport Addition to the City of Cheyenne, does hereby dedicate the streets and ways shown hereon to the use of the public for use authorized by resolution of the Board of Trustees of School District No. 1 of Laramie County, dated 20 September 1935.

By _____
City Clerk

Acknowledgment
State of Wyoming }
County of Laramie } ss
I hereby certify that on this 26th day of September A. D. 1935, before me the undersigned, a Notary Public, Board of Trustees of School District No. 1 of Laramie County, who created the within and foregoing plat and certificate, the said instrument to be their free and voluntary act and deed for the purposes mentioned in the within and foregoing plat and certificate, and that said instrument and certificate were lawfully and lawfully executed and acknowledged.

By _____
Notary Public in and for the State of Wyoming

By _____
My Commission expires _____

Approved by resolution of the City Council of the City of Cheyenne, Laramie County, Wyoming, this 25th day of September, A. D. 1935.
City Clerk

