

NOTE.
 THE DECLARATION OF PROTECTIVE COVENANTS FOR TRACTS 1-26 IS RECORDED IN PUBLIC RECORDS, BOOK 1424 AT PAGE 301, LARAMIE COUNTY RECORDS.

- LEGEND**
- 5/15" x 3/16" LIME BEAR WITH W/ ALUMINUM CAP STAMP "555 PCS 2500"
 - 1/2" x 3/4" LIME BEAR WITH ST. ALUMINUM CAP STAMP "555 PCS 2500"
 - 1/2" x 3/4" LIME BEAR WITH ST. ALUMINUM CAP STAMP "555 PCS 2500"
 - 1/2" x 3/4" LIME BEAR WITH ST. ALUMINUM CAP STAMP "555 PCS 2500"
 - 1/2" x 3/4" LIME BEAR WITH ST. ALUMINUM CAP STAMP "555 PCS 2500"
 - ROAD W.D.O.T. 8/4 MONUMENT
 - ROAD OLD STONE



CERTIFICATE OF SURVEYOR
 I, John A. Shea, Registered Professional Land Surveyor in the State of Wyoming, hereby state, to the best of my knowledge, information and belief, that this map was prepared from field notes taken during an actual survey, conducted by me or under my direct supervision, and that this map correctly shows the results of said survey and that the monuments found or set are as shown.

RECORD OF SURVEY FOR ANTELOPE MEADOWS 2nd FILING

BEING A PORTION OF SECTION 26 AND A PORTION OF SECTION 25, T.14N., R.64W., OF THE 6th P.M., LARAMIE COUNTY, WYOMING.
 PREPARED OCTOBER, 2002

STEEL SURVEYING SERVICES, LLC
 PROFESSIONAL LAND SURVEYORS
 102 W. 1ST ST. P.O. BOX 2073
 CHEYENNE, WYOMING 82001

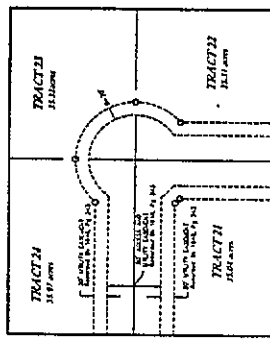

DETAIL ACCESS & UTILITY EASEMENT
 SCALE: 1" = 100'

FILING RECORD

Tract 26, Section 26, T.14N., R.64W., 6th P.M., Laramie County, Wyoming.

Survey Cabinet: 1424-301

Surveyor: John A. Shea

Date: 10/15/02

Book: 1424, Page: 301

TRACT 17
 A tract of land situated in the SW 1/4 of Section 26, Township 14 North, Range 64 West, of the 6th Principal Meridian, Laramie County, Wyoming, more particularly described as follows: Commencing at the southeast corner of said Section 26, bearing S 02°07'30" E, along the east line of said Section 26, a distance of 1181.25 feet to a monument, being a 1/2" x 3/4" lime bear with a stamped "555 PCS 2500", a distance of 1181.25 feet to the point of beginning. Containing 3628.00 acre more or less.

TRACT 18
 A tract of land situated in the SW 1/4 of Section 26, Township 14 North, Range 64 West, of the 6th Principal Meridian, Laramie County, Wyoming, more particularly described as follows: Commencing at the southeast corner of said Section 26, bearing S 02°07'30" E, along the east line of said Section 26, a distance of 1181.25 feet to a monument, being a 1/2" x 3/4" lime bear with a stamped "555 PCS 2500", a distance of 1181.25 feet to the point of beginning. Containing 3628.00 acre more or less.

TRACT 19
 A tract of land situated in the SW 1/4 of Section 26, Township 14 North, Range 64 West, of the 6th Principal Meridian, Laramie County, Wyoming, more particularly described as follows: Commencing at the southeast corner of said Section 26, bearing S 02°07'30" E, along the east line of said Section 26, a distance of 1181.25 feet to a monument, being a 1/2" x 3/4" lime bear with a stamped "555 PCS 2500", a distance of 1181.25 feet to the point of beginning. Containing 3628.00 acre more or less.

TRACT 20
 A tract of land situated in the SW 1/4 of Section 26, Township 14 North, Range 64 West, of the 6th Principal Meridian, Laramie County, Wyoming, more particularly described as follows: Commencing at the southeast corner of said Section 26, bearing S 02°07'30" E, along the east line of said Section 26, a distance of 1181.25 feet to a monument, being a 1/2" x 3/4" lime bear with a stamped "555 PCS 2500", a distance of 1181.25 feet to the point of beginning. Containing 3628.00 acre more or less.

TRACT 21
 A tract of land situated in the SW 1/4 of Section 26, Township 14 North, Range 64 West, of the 6th Principal Meridian, Laramie County, Wyoming, more particularly described as follows: Commencing at the southeast corner of said Section 26, bearing S 02°07'30" E, along the east line of said Section 26, a distance of 1181.25 feet to a monument, being a 1/2" x 3/4" lime bear with a stamped "555 PCS 2500", a distance of 1181.25 feet to the point of beginning. Containing 3628.00 acre more or less.

TRACT 22
 A tract of land situated in the SW 1/4 of Section 26, Township 14 North, Range 64 West, of the 6th Principal Meridian, Laramie County, Wyoming, more particularly described as follows: Commencing at the southeast corner of said Section 26, bearing S 02°07'30" E, along the east line of said Section 26, a distance of 1181.25 feet to a monument, being a 1/2" x 3/4" lime bear with a stamped "555 PCS 2500", a distance of 1181.25 feet to the point of beginning. Containing 3628.00 acre more or less.

TRACT 23
 A tract of land situated in the SW 1/4 of Section 26, Township 14 North, Range 64 West, of the 6th Principal Meridian, Laramie County, Wyoming, more particularly described as follows: Commencing at the southeast corner of said Section 26, bearing S 02°07'30" E, along the east line of said Section 26, a distance of 1181.25 feet to a monument, being a 1/2" x 3/4" lime bear with a stamped "555 PCS 2500", a distance of 1181.25 feet to the point of beginning. Containing 3628.00 acre more or less.

TRACT 24
 A tract of land situated in the SW 1/4 of Section 26, Township 14 North, Range 64 West, of the 6th Principal Meridian, Laramie County, Wyoming, more particularly described as follows: Commencing at the southeast corner of said Section 26, bearing S 02°07'30" E, along the east line of said Section 26, a distance of 1181.25 feet to a monument, being a 1/2" x 3/4" lime bear with a stamped "555 PCS 2500", a distance of 1181.25 feet to the point of beginning. Containing 3628.00 acre more or less.

TRACT 25
 A tract of land situated in the SW 1/4 of Section 26, Township 14 North, Range 64 West, of the 6th Principal Meridian, Laramie County, Wyoming, more particularly described as follows: Commencing at the southeast corner of said Section 26, bearing S 02°07'30" E, along the east line of said Section 26, a distance of 1181.25 feet to a monument, being a 1/2" x 3/4" lime bear with a stamped "555 PCS 2500", a distance of 1181.25 feet to the point of beginning. Containing 3628.00 acre more or less.

TRACT 26
 A tract of land situated in the SW 1/4 of Section 26, Township 14 North, Range 64 West, of the 6th Principal Meridian, Laramie County, Wyoming, more particularly described as follows: Commencing at the southeast corner of said Section 26, bearing S 02°07'30" E, along the east line of said Section 26, a distance of 1181.25 feet to a monument, being a 1/2" x 3/4" lime bear with a stamped "555 PCS 2500", a distance of 1181.25 feet to the point of beginning. Containing 3628.00 acre more or less.