



CURVE TABLE

NUMBER	DELTA ANGLE	CHORD DIRECTION	TANGENT	RADIUS	ARC LENGTH	CHORD LENGTH
C1	127.273°	S89°42'51"E	118.87	100.00	118.87	118.87
C2	21.300°	S23°43'45"E	36.00	200.00	75.10	74.86
C3	23.324°	N31°21'34"W	41.68	200.00	82.19	81.61
C4	48.381°	N64°42'54"E	80.31	200.00	158.68	154.62
C5	09.253°	N43°58'43"E	18.19	200.00	32.31	32.28
C6	49.227°	S22°42'24"E	83.60	200.00	158.37	154.27
C7	17.949°	S37°17'54"W	68.53	200.00	112.04	109.66
C8	44.295°	S87°10'29"E	81.82	200.00	155.33	151.46
C9	41.907°	S20°12'35"W	153.23	400.00	292.67	288.19
C10	78.371°	N52°42'42"E	118.87	100.00	118.87	118.87
C11	65.730°	S32°41'43"E	63.98	100.00	113.63	107.79
C12	28.423°	N50°27'07"W	53.05	200.00	103.70	102.55
C13	28.317°	N72°54'34"W	53.60	100.00	94.35	93.81
C14	50.703°	N07°10'12"W	83.62	200.00	178.12	169.58
C15	23.384°	N72°08'28"E	41.80	200.00	82.42	81.88
C16	68.200°	N44°13'09"E	243.55	250.00	358.19	348.90
C17	27.074°	N77°12'50"E	41.01	200.00	80.90	80.35
C18	74.505°	N28°12'24"E	78.50	100.00	138.81	121.52
C19	45.748°	N31°46'24"W	81.35	200.00	157.84	153.87
C20	54.423°	N27°14'36"W	103.57	200.00	191.74	183.84
C21	12.701°	S89°42'51"E	491.65	240.00	532.09	428.62
C22	10.748°	N45°10'16"W	5.33	100.00	6.65	6.65

LINE TABLE

NUMBER	DIRECTION	DISTANCE
L1	S89°10'51"E	446.23
L2	N89°10'51"W	889.47
L3	S72°58'20"E	463.95
L4	S34°29'10"E	234.04
L5	S48°58'10"E	277.07
L6	S43°10'54"E	177.53
L7	S19°20'14"E	318.42
L8	S20°12'35"W	608.71
L9	S38°18'24"W	200.98
L10	S20°12'35"W	243.05
L11	S44°50'11"E	1225.29
L12	S89°25'27"E	54.37
L13	S00°26'43"W	243.05
L14	S44°50'11"E	1225.29
L15	S89°25'27"E	54.37
L16	N00°10'04"W	862.33
L17	N41°11'28"E	378.89
L18	N41°11'28"E	378.89
L19	N85°18'23"W	182.13
L20	N00°26'43"W	536.58
L21	N35°35'25"W	260.34
L22	S89°21'59"E	1334.89
L23	S89°38'04"E	778.54
L24	N89°38'04"W	532.37
L25	S89°38'04"E	132.30
L26	S89°43'00"E	132.30
L27	N00°10'04"W	13.61
L28	N26°15'13"W	98.06
L29	N23°54'50"E	102.60
L30	N00°10'04"W	388.40
L31	N88°48'12"E	378.63
L32	N85°37'38"E	38.23
L33	N89°12'22"W	64.43
L34	N09°12'22"W	90.32
L35	N89°12'22"W	90.32
L36	N84°27'18"W	731.22
L37	N00°10'04"W	310.89
L38	N89°16'28"W	312.07

NOTE

ACCESS AND UTILITY EASEMENTS ARE FILED AND RECORDED SIMULTANEOUSLY HERewith BY SEPARATE DOCUMENT AS EXHIBIT A

OWNERS

FIRST AMERICAN TITLE INSURANCE COMPANY, A CALIFORNIA CORPORATION, TRUSTEE OF THE DIAMOND B RANCH PURCHASE TRUST DATED JUNE 9, 2005, NO. 8598

DEVELOPER

WILD WEST DEVELOPMENT COMPANY, INC., A WYOMING CORPORATION

LEGEND

- SET 3/4" X 24" LONG REBAR WITH 2 1/2" ALUMINUM CAP STAMPED "SSS PLS 2500" AND APPROPRIATE DATA
- SET 3/4" X 24" LONG REBAR WITH 3/4" ALUMINUM CAP STAMPED "STEEL SURVEYING SERVICES PLS 2500" AND APPROPRIATE DATA
- SET 3/4" X 24" LONG REBAR WITH 1 1/2" ALUMINUM CAP STAMPED "SSS PLS 2500"
- ⊙ FOUND 3/4" X 24" LONG REBAR WITH 2" ALUMINUM CAP STAMPED "SSS PLS 2500"
- ⊙ FOUND 3/4" X 24" LONG REBAR WITH 3/4" ALUMINUM CAP STAMPED "STEEL SURVEYING SERVICES PLS 2500" AND APPROPRIATE DATA
- FOUND GLO STONE
- ⊙ FOUND 3/4" BRASS CAP "CORP OF ENGINEERS"

CERTIFICATE OF SURVEYOR

I, John A. Steil, Registered Professional Land Surveyor in the State of Wyoming, hereby state, to the best of my knowledge, information and belief, that this map was prepared from field notes taken during an actual survey made by me or under my direct supervision; and that this map correctly shows the results of said survey and that the monuments found or set are as shown.



RECORD OF SURVEY FOR

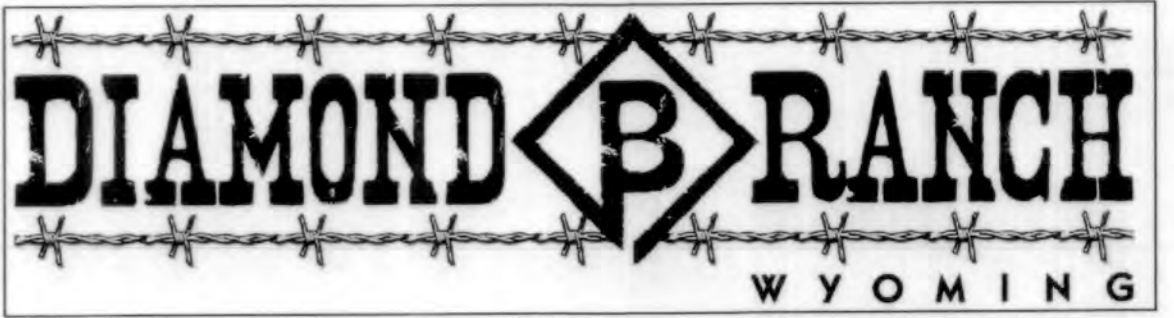

OF
ALL OF SECTIONS 17, 18, 19, 20 & 29, ALL OF SECTION 28 EXCEPT THE NE 1/4 THEREOF & A PORTION OF THE SW 1/4 OF SECTION 27, T.17N., R.64W., OF THE 6TH P.M., LARAMIE COUNTY, WYOMING.
PREPARED JULY, 2005

STEEL SURVEYING SERVICES, LLC
PROFESSIONAL LAND SURVEYORS
1102 WEST 19th STREET P.O. BOX 2073
PH(307)634-7273 CHEYENNE, WY. 82003

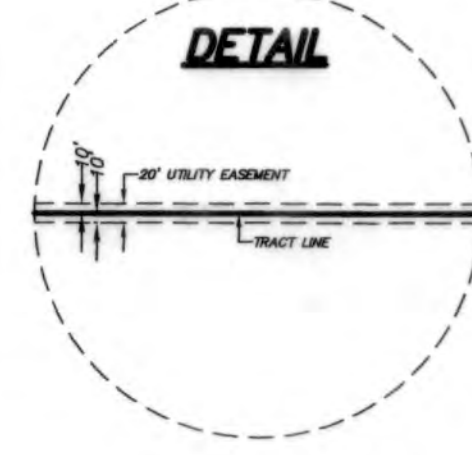

RECORDED 18/24/2005 AT 10:22 AM REC# 429162 X# 1996 PG# 274
DEBRA K. LATHROP, CLERK OF LARAMIE COUNTY, WY. PAGE 1 OF 1

FILING RECORD
Reception 429162
The State of Wyoming }
County of Laramie } SS
This instrument was filed for record at 10:22 o'clock A.M. on the 18th day of July, A.D. 2005 and duly recorded in S/C 2 at 87

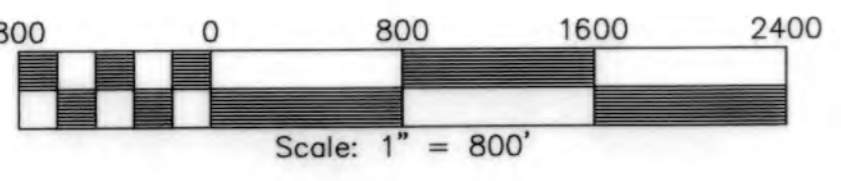

WATER SUPPLIED BY INDIVIDUAL DOMESTIC WELL
SEWAGE DISPOSAL BY INDIVIDUAL SEPTIC SYSTEM
ROAD MAINTENANCE BY RANCH OWNERS ASSOCIATION
FIRE PROTECTION TO BE PROVIDED BY FIRE DISTRICT #3

BRUEGMAN BOULEVARD (80' R/W)

16.5' CABLE LINE AND APPURTENANCE EASEMENT RECORDED BOOK 798, PAGE 185

200' X 200' ACCESS EASEMENT FOR SCHOOL BUS TURNAROUND AND POSTAL FACILITIES