

Witnesses:
We, the undersigned, being the persons named in the foregoing plat, do hereby declare that the plat of the same is a true and correct copy of the original survey as shown on file in the office of the County Clerk of Laramie County, Wyoming, and that we are duly qualified to act as witnesses in the execution of this deed.

Boise & Fisher, PE & PLS #2613
Boise & Fisher

Address Acknowledgment
I, _____, County Clerk of Laramie County, Wyoming, do hereby certify that the foregoing plat is a true and correct copy of the original survey as shown on file in the office of the County Clerk of Laramie County, Wyoming, and that I am duly qualified to act as a witness in the execution of this deed.

Boise & Fisher, PE & PLS #2613
Boise & Fisher



Witnesses:
I, _____, County Clerk of Laramie County, Wyoming, do hereby certify that the foregoing plat is a true and correct copy of the original survey as shown on file in the office of the County Clerk of Laramie County, Wyoming, and that I am duly qualified to act as a witness in the execution of this deed.

Boise & Fisher, PE & PLS #2613
Boise & Fisher

Land Description
THE S 1/2 TRACT 28 ARTESIAN TRACTS AS SHOWN ON WARRANTY DEED FOUND IN BOOK 1358 PAGE 388.

Certificate of Surveyors
State of Wyoming } ss
County of Laramie }
I, Roger H. Krum, a Licensed Land Surveyor in the State of Wyoming hereby certify that this map of the South 1/2 of Lot 28, Artesian Tracts, has been prepared from field notes of a survey performed under my supervision during the month of August in this, the Year of Our Lord 2001 and from data acquired from surveys, plat and other data on file in the offices of Laramie County agencies and that this map correctly and accurately portrays said lands as surveyed and shows the monumentation as found and/or set during said survey to the best of my knowledge and belief.

Roger H. Krum, PE & PLS #2613
12/1/01

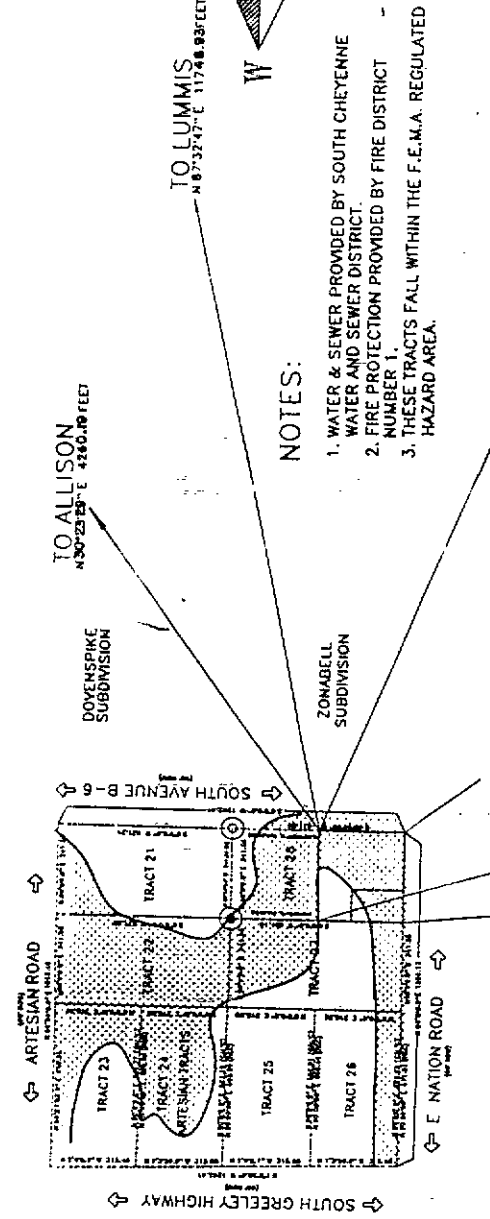

NOTES:
1. WATER & SEWER PROVIDED BY SOUTH CHEYENNE WATER AND SEWER DISTRICT.
2. FIRE PROTECTION PROVIDED BY FIRE DISTRICT NUMBER 1.
3. THESE TRACTS FALL WITHIN THE F.E.M.A. REGULATED HAZARD AREA.

LEGEND:
○ FOUND REBAR & CAP - PE#662
● 5/8" REBAR W/ 1 1/2" AL CAP
Roger H. Krum, PE & PLS #2613
○ FOUND 3/4" IRON PIPE
■ F.E.M.A. REGULATED HAZARDED AREA

CONVERSIONS
From International System of Units (SI) to American Standard One Foot = 0.30480 Meter
One Acre = 0.404687 Hectares
Note: With the approval of Public Law 94-168 as signed H.R. Law in 1976, the Metric Conversion is equated as One Foot = 1200/3937 Meter

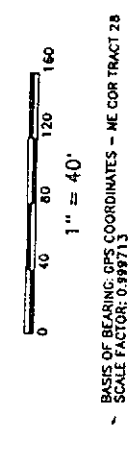

FISHER TRACTS
A REPLAT OF THE S1/2 TRACT 28 ARTESIAN TRACTS OF THE SECTION 17, T.13 N., R.66 W., LARAMIE COUNTY, WYOMING

BASIS OF BEARINGS, GPS COORDINATES - NE COR TRACT 28
SCALE FACTOR: 0.999713

WESTERN RESEARCH & DEVELOPMENT, LTD.
BOISE, IDAHO, U.S.A.
LARAMIE COUNTY, WYOMING 82001

PAGE 1 OF 1
Surveyed by: _____
Plat No. _____

This document is void and if it has been offered to a court of law, the court shall not be bound by it. The Surveyor has not been and shall not be held responsible for the accuracy of the monumentation shown on this plat. It is the responsibility of the owner to verify the monumentation shown on this plat. A copy of this plat shall be kept on file in the office of the County Clerk of Laramie County, Wyoming.

Boise & Fisher
Boise & Fisher

Boise & Fisher, PE & PLS #2613
12/1/01