

PROJECT: 2229  
 DATE: 04/01/94  
 SURVEYOR: JBA/EDD/CJ  
 DRAWN BY: BJB/ACAD  
 PROJECT: 2229  
 PHONE: (307) 632-5138  
 PHONE: (303) 395-0747

**INTERMOUNTAIN PROFESSIONAL SERVICES, INC.**

PROJECT: FINAL PLAN OF MISSILE DRIVE

Sheet 1 of 1

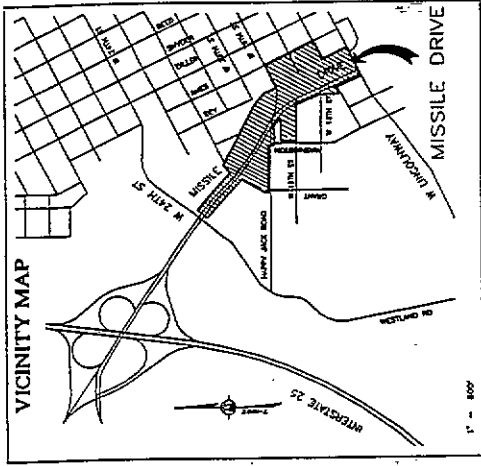

**DEDICATION**

KNOW ALL MEN BY THESE PRESENTS, THAT I, the undersigned, do hereby dedicate to the public use of the State of Wyoming, the land hereinafter described, to be known as MISSILE DRIVE, and to be located in the City of Cheyenne, Wyoming.

CITY OF CHEYENNE

*[Signature]*  
 Mayor  
*[Signature]*  
 City Clerk

**ACKNOWLEDGEMENT**

STATE OF WYOMING )  
 COUNTY OF LARAMIE )  
 I, the undersigned, do hereby acknowledge before me the execution of the foregoing instrument by the City of Cheyenne, Wyoming, and the City Clerk, and the recording of the same in the office of the County Clerk of Laramie County, Wyoming, on this 4th day of December, 1993.

BY COMMISSIONER: *[Signature]*  
 December 4, 1993

**APPROVALS**

APPROVED BY THE CHEYENNE-LARAMIE COUNTY REGIONAL PLANNING COMMISSION  
 December 1, 1993

RECORDED BY THE CITY CLERK OF CHEYENNE, WYOMING, THIS 21st DAY OF DECEMBER, 1993.  
*[Signature]*  
 City Clerk

**MISSILE DRIVE**

A PLAN OF A PORTION OF SECTION 30, T. 14 N., R. 68 W., S. 6, AND A PORTION OF SECTION 36, T. 14 N., R. 68 W., S. 6, AND A PORTION OF SECTION 6, T. 13 N., R. 68 W., S. 6, CITY OF CHEYENNE, LARAMIE COUNTY, WYOMING, BEING A RE-PLAN OF A PORTION OF THE ORIGINAL CITY OF CHEYENNE AND OF A PORTION OF CENTRAL ADDITION.

**STATEMENT OF SURVEYOR**

I, the undersigned, being duly sworn, depose and say that I am a duly licensed Surveyor in the State of Wyoming, and that I am the author of the foregoing plan, and that the same is a true and correct copy of the original plan on file in my office, and that I am not aware of any fraud or collusion in the execution of the same.

*[Signature]*  
 December 1, 1993  
 Surveyor

**SET MONUMENTS**

1. All monuments shall be set in accordance with the plan hereon.
2. All monuments shall be set in accordance with the plan hereon.
3. All monuments shall be set in accordance with the plan hereon.
4. All monuments shall be set in accordance with the plan hereon.
5. All monuments shall be set in accordance with the plan hereon.



**VACATION**

THE CITY OF CHEYENNE, WYOMING, DO HEREBY VACATE THE PORTION OF THE ORIGINAL CITY OF CHEYENNE AND OF CENTRAL ADDITION EMBRACED HEREON.

**NOTES**

- 1) EAST OF STREET, CITY OF CHEYENNE DATA BY CLOSED TRVERSE.
- 2) ALTERNATE AS SHOWN ARE ANGLES BEING FROM NORTH.
- 3) POINT MONUMENT AS SHOWN IN TABLE.
- 4) SET 3/4" x 3/4" NIPER WITH "ALUMINUM CAP" (STANDARD "NIPER" - PLS 3841)
- 5) RECORD DIMENSION FROM PLAN OF CENTRAL ADDITION.

**MONUMENTS**

FOR THE SET, UNLESS SHOWN THE METHOD GIVEN IN THE PLAN, THE MONUMENTS SHALL BE SET IN ACCORDANCE WITH THE FOLLOWING TABLE:

TYPE OF MONUMENT	DEPTH	DIAMETER	OTHER DATA
WOODEN POST	36"	2"	
IRON PIPE	36"	2"	
CONCRETE	36"	2"	
IRON PIPE	36"	2"	
CONCRETE	36"	2"	
IRON PIPE	36"	2"	
CONCRETE	36"	2"	
IRON PIPE	36"	2"	
CONCRETE	36"	2"	

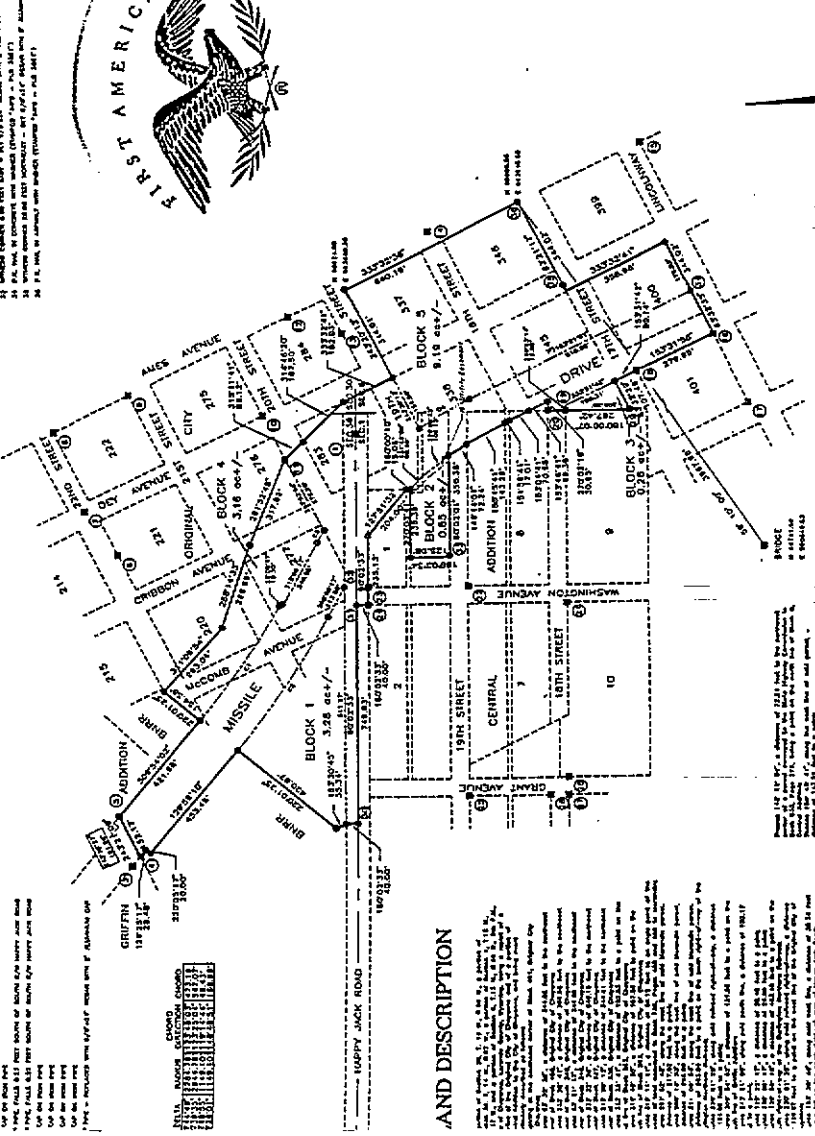

**FILING RECORD**  
 This plan was filed for record on December 1, 1993, at 10:30 A.M. in the office of the County Clerk of Laramie County, Wyoming, and is hereby certified to be a true and correct copy of the original plan on file in my office.

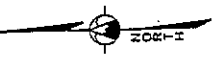

**AND DESCRIPTION**

THIS PLAN SHOWS THE ORIGINAL CITY OF CHEYENNE AND OF CENTRAL ADDITION, BEING A RE-PLAN OF A PORTION OF THE ORIGINAL CITY OF CHEYENNE AND OF A PORTION OF CENTRAL ADDITION. THE PLAN SHOWS THE LOCATION OF MISSILE DRIVE, AND THE LOCATION OF THE ORIGINAL CITY OF CHEYENNE AND OF CENTRAL ADDITION. THE PLAN SHOWS THE LOCATION OF THE ORIGINAL CITY OF CHEYENNE AND OF CENTRAL ADDITION. THE PLAN SHOWS THE LOCATION OF THE ORIGINAL CITY OF CHEYENNE AND OF CENTRAL ADDITION.