

Plan of
Bessemer
Carbon County
Wyoming

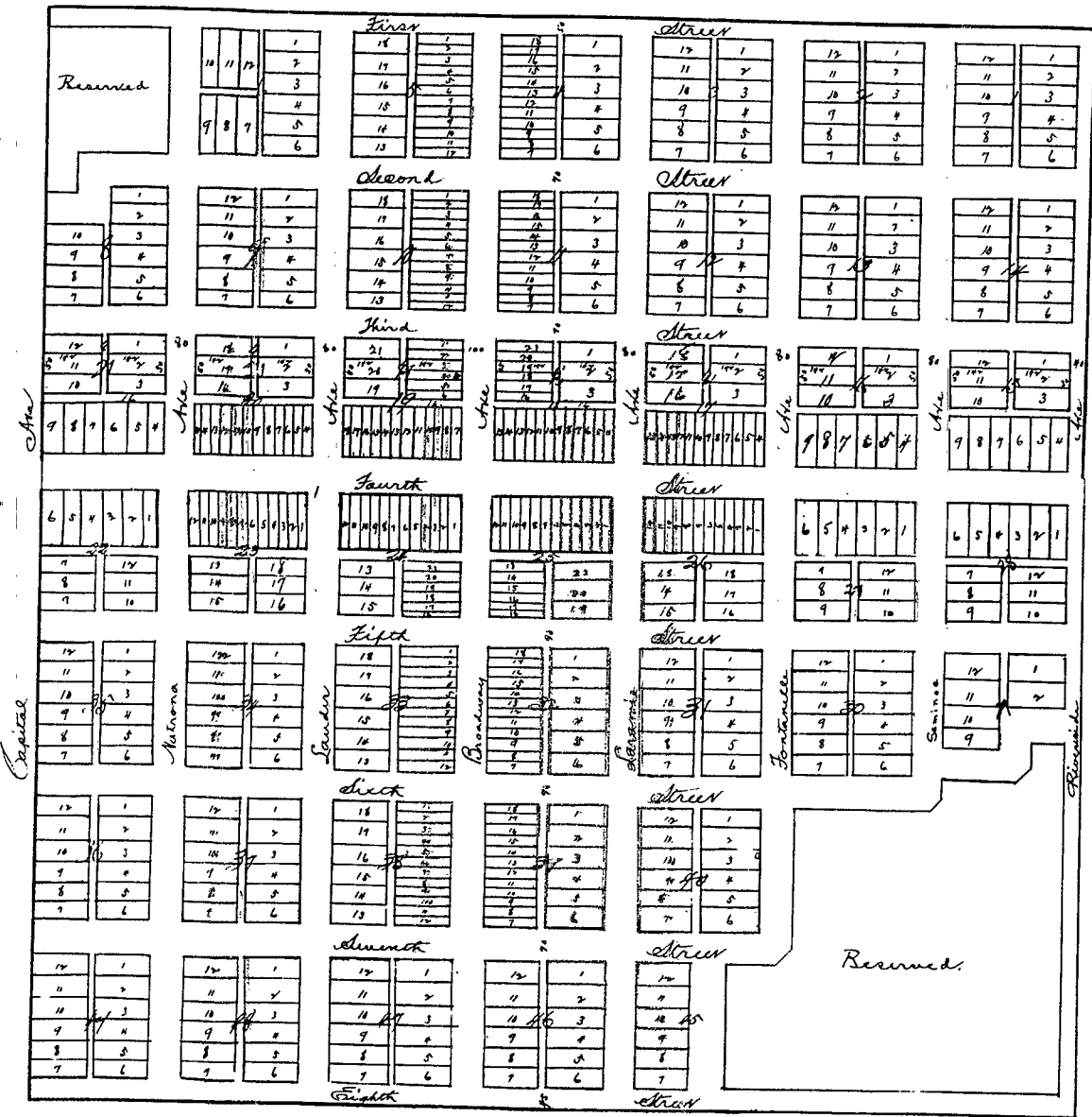

I hereby certify that in the month of March 1888
I surveyed the Town of Bessemer, located on the north
east quarter of section 4 Township 32 N Range 81
West, Carbon County, Wyoming, as is more definitely
shown by the foregoing plat which is a correct delineation
of said survey drawn to a scale drawn to a scale of
two feet to the inch. The north line of said section 4
is taken as a base line for the survey and all streets
are laid parallel with and at right angles to said
base line. Five stakes of inches long are driven at the
four corners of each lot and each lot is marked with
its own number the width of all streets and alleys
and the dimensions of all lots are marked in feet
and decimals in red figures on the plat.

Witness my hand this 23rd day
of July 1888.

J. K. Sheldon
Surveyor

Certificate of Dedication

This certifies that the Wyoming Improvement Company,
the present owners of the north east quarter of section
4 township 32 N. Range 81 West
Carbon County Wyoming upon which the town of Bessemer
is located. Their said owners have caused said land to be
surveyed and platted as shown by the foregoing
plat and described in said certificate, and
hereby dedicated to the public use.

In testimony whereof the Wyoming Improvement Company
has hereunto set its seal and caused the same to be
signed by its president and countersigned by its secre-
tary this 23rd day of July A.D. 1888.

Witness my hand and seal of said Company
this 23rd day of July 1888.
J. K. Sheldon
Secretary

State of Nebraska
Fillmore County
Be it known that on this 23rd day of July 1888
before me a notary public in and for said County personally appeared
J. K. Sheldon president of the Wyoming Improvement Company who is personally
known to me to be the identical person whose name is subscribed to
the foregoing instrument of platting and dedication as said
president and then and there acknowledged the execution
of said instrument to be the voluntary act and deed of
said Company.

Witness my hand and notarial seal this day last above written
John Mills
Notary Public

The State of Nebraska
Fillmore County
J. K. Sheldon, Clerk of the District
Court within and for said County, the same being a
Court of Records do hereby certify that the annexed instru-
ment is executed and proved, or acknowledged in
due form, according to the laws of the State of Nebraska
to entitle it to be recorded therein, also that
John Mills before whom the same was proved and
acknowledged was at the time of taking such proof or
acknowledgment a notary public in and for said County,
fully qualified and authorized to take the same
and further certify that I am well acquainted with
the handwriting of the said John Mills and truly
believe the signature to the said Certificate of acknow-
ledgment is genuine.

Witness my hand and seal of said Court
Nebraska this 23rd day of July 1888
J. K. Sheldon
Clerk

