

HIGHLAND PARK ADDITION NO. 2  
SCALE: 1" = 40'

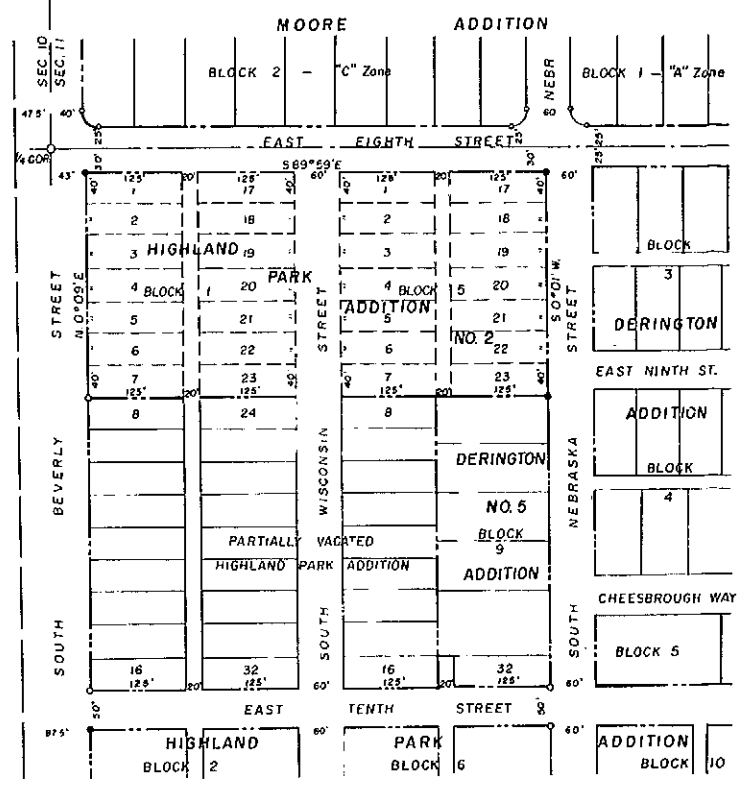
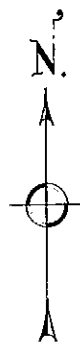

HIGHLAND PARK ADDITION NO. 2  
LOCATION MAP  
Scale 1" = 100'

CERTIFICATE OF SURVEYOR

STATE OF WYOMING  
COUNTY OF NATRONA

I, E. C. Lenhart of Casper, Wyoming do hereby certify that this plat was made from notes taken during an actual survey made by me during the month of April, 1960 and said plat correctly represents Highland Park Addition No. 2 to the City of Casper and the subdivision thereof, the same being described in the owners Certificate of Dedication and set forth by this plat. Streets and Tracts are well and accurately staked as set forth by this plat, all dimensions are expressed in feet and decimals thereof, such survey is true and correct to the best of my knowledge and belief.

E. C. LENHART, WYO REG NO 320 P.E. & L.S.

Subscribed in my presence and sworn to before this 13<sup>th</sup> day of March, 1961

My Commission expires on the 27th of May, 1962

NOTARY PUBLIC

APPROVALS

BOARD OF COUNTY COMMISSIONERS, NATRONA COUNTY, WYOMING: CITY COUNCIL, CITY OF CASPER, WYOMING

By Resolution duly passed on the 26 day of April, 1961. By Ordinance No. 10, duly passed, adopted and approved on the 13<sup>th</sup> day of March, 1961.

ATTEST: COUNTY CLERK [Signature] CHAIRMAN OF THE BOARD [Signature] NOTARY [Signature] PRESIDENT OF COUNCIL [Signature] CITY CLERK [Signature]

INSPECTED and APPROVED: COUNTY SURVEYOR [Signature] INSPECTED and APPROVED: CITY ENGINEER [Signature]

CERTIFICATE OF DEDICATION

This is to certify that The Evangelical Lutheran Church, a non-profit Minnesota corporation, is the owner and proprietor of the above named subdivision as shown on the annexed plat and which subdivision consists of vacated Lots 1 through 7 inclusive and Lots 17 through 23 inclusive of both vacated Blocks 1 and 5 of Highland Park Addition to the City of Casper, Natrona County, Wyoming, and which subdivision includes that portion of the NW 1/4 NW 1/4 SW 1/4 of Section 11 in T. 33 N., R. 79 W. of the 6th P.M. more particularly described as follows:

Beginning at the Northwest corner of said vacated Lot 1 in said vacated Block 1 of Highland Park Addition to the City of Casper, Natrona County, Wyoming, as originally platted, which corner is located S 89° 59' E, 4300 feet and S 0° 09' W, 3000 feet from the Northwest corner of said SW 1/4, Section 11, thence from the point of beginning S 89° 59' E, 601.10 feet along the north line of said vacated Blocks 1 and 5, which line is also the south line of East Eighth Street, to the Northeast corner of said vacated Block 5, thence S 0° 09' W, 278.18 feet along the easterly line of said vacated Block 5 to the Southeast corner of said vacated Lot 23 of said vacated Block 5, said corner also being the Northeast corner of Derrington No. 5 Addition, Block 9 to said City of Casper, thence West along the northerly line of said Derrington Addition and the southerly line of said vacated Lots 23 and 7 of said vacated Block 5 and said vacated Lots 23 and 7 of said vacated Block 1, 601.90 feet to the southwest corner of said vacated Lot 7 in vacated Block 1, thence N 0° 09' E, along the westerly line of said vacated Block 1, 278.21 feet to the Northwest corner of said vacated Block 1 to the point of beginning. Said Parcel contains 3.842 acres.

Said subdivision includes Tracts A and B and is known as Highland Park Addition Number 2 to the City of Casper, Natrona County, Wyoming, and in accordance with the desire of the above named owner and proprietor, The Evangelical Lutheran Church, that portion of the street as shown on the annexed plat is dedicated to the public for public use.

IN WITNESS WHEREOF, said The Evangelical Lutheran Church has caused its corporate seal to be hereunto affixed and these presents to be signed by its duly authorized officers this 13<sup>th</sup> day of March, 1961.

STATE OF MINNESOTA  
COUNTY OF HENNEPIN

On this 13<sup>th</sup> day of March, 1961, before me personally appeared Walter A. Anderson and he acknowledged to me personally known, who, being by me duly sworn, did say that he is the Chairman of the Board of Trustees of The Evangelical Lutheran Church and that the seal affixed to said instrument is the corporate seal of said corporation and that said instrument was signed and sealed on behalf of said corporation by authority of its Board of Directors and said Walter A. Anderson acknowledged said instrument to be the free act and deed of said corporation.

My commission expires on the 26<sup>th</sup> day of August, A. D., 1962.  
Given under my hand and notarial seal this 13<sup>th</sup> day of March, 1961.

NOTARY PUBLIC

PLAT OF  
HIGHLAND PARK ADDITION NO. 2  
TO THE CITY OF CASPER  
NATRONA COUNTY, WYOMING

A SUBDIVISION OF A PART OF  
THE NW 1/4 NW 1/4 SW 1/4, SECTION 11  
T. 33 N., R. 79 W. OF THE 6th P.M.  
WYOMING

BY:  
WORTHINGTON, LENHART & ASSOCIATES, INC  
200 South Lowell Street, Casper, Wyoming

