

CERTIFICATE OF DEDICATION

STATE OF WYOMING }
 COUNTY OF NATRONA }SS

THE UNDERSIGNED, EC ENTERPRISES, LLC, DO HEREBY CERTIFY THAT THEY ARE THE OWNERS AND PROPRIETORS OF THE FOLLOWING DESCRIBED PARCEL OF LAND. LOT 5, JAFER INDUSTRIAL PARK SUBDIVISION A PARCEL OF LAND SITUATE IN THE NW1/4SE1/4 OF SECTION 20, T.34N., R.79W., 6TH P.M., NATRONA COUNTY, WYOMING, BEING MORE PARTICULARLY DESCRIBED AS FOLLOWS:

COMMENCING AT THE NORTH EAST CORNER OF LOT 4 JAFER INDUSTRIAL PARK SUBDIVISION, SAID POINT ALSO BEING ON THE SOUTH BOUNDARY OF JAFER ROAD AND BEING THE POINT OF BEGINNING;

THENCE S75°32'16"E, COINCIDENT WITH THE SOUTH LINE OF SAID JAFER ROAD, A DISTANCE OF 242.55 FEET TO THE NORTHWEST CORNER OF LOT 6 JAFER INDUSTRIAL PARK SUBDIVISION;

THENCE S14°33'32"W, COINCIDENT WITH THE WEST LINE OF SAID LOT 6, A DISTANCE OF 180.17 FEET TO THE SOUTHWEST CORNER OF SAID LOT 6;

THENCE N75°24'50"W, COINCIDENT WITH THE SOUTH LINE OF SAID JAFER INDUSTRIAL PARK SUBDIVISION, A DISTANCE OF 242.32 FEET TO THE SOUTHEAST CORNER OF SAID LOT 4;

THENCE N14°33'08"E, COINCIDENT WITH THE EAST LINE OF SAID LOT 4, A DISTANCE OF 179.65 FEET TO THE POINT OF BEGINNING.

THE ABOVE DESCRIBED PARCEL CONTAINS 1.00 ACRES MORE OR LESS, AND IS SUBJECT TO ANY RIGHTS-OF-WAY AND/OR EASEMENTS, RESERVATIONS AND ENCUMBRANCES WHICH HAVE BEEN LEGALLY ACQUIRED.

THE TRACT OF LAND, AS IT APPEARS ON THIS PLAT, IS DEDICATED WITH THE FREE CONSENT AND IN ACCORDANCE WITH THE DESIRES OF THE UNDERSIGNED OWNERS AND PROPRIETORS. THE NAME OF THE SUBDIVISION SHALL BE "JAFER INDUSTRIAL PARK LOT 7 & 8" AND THE OWNERS HEREBY GRANT TO THE PUBLIC AND PRIVATE UTILITY COMPANIES AN EASEMENT AND LICENSE TO LOCATE, CONSTRUCT, USE AND MAINTAIN CONDUITS, LINES, WIRES AND PIPES, ANY OR ALL OF THEM, UNDER AND ALONG THE STRIPS OF LAND MARKED "UTILITY EASEMENT" AS SHOWN ON THIS PLAT. ALL ROADS AND STREETS AS SHOWN HEREON HAVE BEEN PREVIOUSLY DEDICATED TO THE USE OF THE PUBLIC.

EC ENTERPRISES, LLC
 P.O. BOX 2218
 CASPER, WYOMING 82602

Eric Grinstead
 ERIC GRINSTEAD - MANAGING MEMBER

Cassandra McClure
 CASSANDRA MCCLURE - MANAGING MEMBER

APPROVALS

APPROVED BY THE NATRONA COUNTY BOARD OF COMMISSIONERS THIS _____ DAY OF _____ 2021.

ATTEST: *Tracy Good* COUNTY CLERK
 My term of office expires January 3, 2023

Paul C. Bertogler BOARD CHAIRMAN

INSPECTED AND APPROVED THIS 6th DAY OF October 2021.
Eric K. Nelson COUNTY PLANNING

INSPECTED AND APPROVED THIS 5th DAY OF October 2021.
[Signature] COUNTY SURVEYOR

INSPECTED AND APPROVED THIS 1st DAY OF October 2021.
[Signature] COUNTY HEALTH DEPARTMENT

THE FOREGOING INSTRUMENT WAS ACKNOWLEDGED BEFORE ME BY ERIC GRINSTEAD AND CASSANDRA MCCLURE, MANAGING MEMBERS OF EC ENTERPRISES, LLC, THIS 16th DAY OF September 2021.

WITNESS MY HAND AND OFFICIAL SEAL.
 MY COMMISSION EXPIRES 3/9/2024

William R. Fehring
 NOTARY PUBLIC

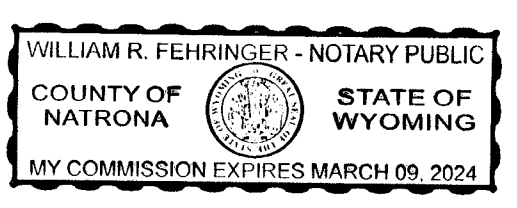

- LEGEND**
- ▲ SET BRASS CAP
 - SET MONUMENT 5/8" REBAR & ALUMINUM CAP
 - ⊙ FOUND MONUMENT AS NOTED

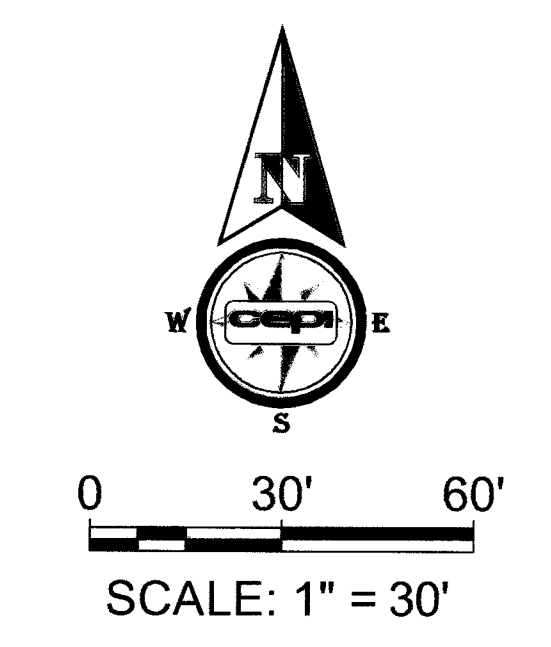

CERTIFICATE OF SURVEYOR

STATE OF WYOMING }
 COUNTY OF NATRONA }SS

I, BRADLEY D. NEUMILLER, A REGISTERED PROFESSIONAL LAND SURVEYOR, LICENSE NO. 13836, DO HEREBY CERTIFY THAT THIS PLAT WAS MADE FROM NOTES TAKEN DURING AN ACTUAL SURVEY MADE UNDER MY DIRECT SUPERVISION IN JUNE, 2021, AND THAT THIS PLAT, TO THE BEST OF MY KNOWLEDGE AND BELIEF, CORRECTLY AND ACCURATELY REPRESENTS SAID SURVEY. ALL BEING TRUE AND CORRECT TO THE BEST OF MY KNOWLEDGE AND BELIEF.

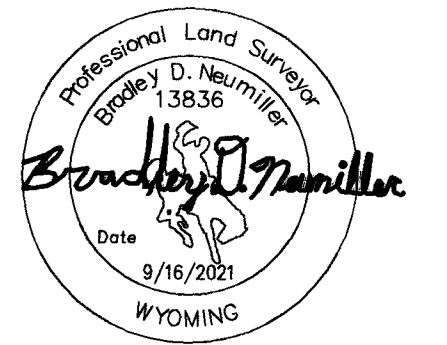

THE FOREGOING INSTRUMENT WAS ACKNOWLEDGED BEFORE ME BY BRADLEY D. NEUMILLER THIS 16th DAY OF SEPTEMBER, 2021.

WITNESS MY HAND AND OFFICIAL SEAL.
 MY COMMISSION EXPIRES 3-29-24

[Signature]
 NOTARY PUBLIC

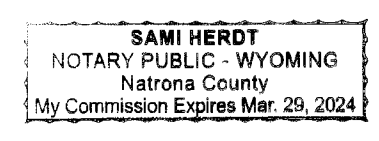

NOTES

1. ERROR OF CLOSURE EXCEEDS 1:250,000.
2. BASIS OF BEARINGS IS THE WYOMING STATE PLANE COORDINATE SYSTEM, EAST CENTRAL ZONE, NAD 1983(2011).
3. DISTANCES: U.S. SURVEY FEET/GIRD.
4. PUBLIC SEWER PROVIDED BY WARDWELL
5. PUBLIC WATER PROVIDED BY WARDWELL

VACATION AND REPLAT OF
 LOT 5
 JAFER INDUSTRIAL PARK SUBDIVISION
 AS
JAFER INDUSTRIAL PARK LOT 7 & 8

BEING A PORTION OF THE NW1/4SE1/4 OF SECTION 20,
 T.34N., R.79W., 6TH P.M.
 NATRONA COUNTY WYOMING

