

1270

227/020

PLAT OF
MANOR HEIGHTS SCHOOL ADDITION
 TO THE CITY OF CASPER
 A PORTION OF
 NW 1/4 NE 1/4, SECTION 14, T33N, R79W, 6th PM.
 NATRONA COUNTY, WYOMING

CERTIFICATE OF DEDICATION

NATRONA COUNTY SCHOOL DISTRICT No. 2, a Body Corporate, does hereby certify that the foregoing part of the NW 1/4 of Section 14, T. 33N., R. 79W. of the 6th Principal Meridian, Natrona County, Wyoming as shown on this plat is with the free consent and in accordance with our desires, the undersigned owners and proprietors of said lands, that the said part of the NW 1/4 of Section 14, shall be named and designated "MANOR HEIGHTS SCHOOL ADDITION TO THE CITY OF CASPER, NATRONA COUNTY, WYOMING".

A Metes and Bounds Description of said "MANOR HEIGHTS SCHOOL ADDITION TO THE CITY OF CASPER" follows:
 From the East 1/16 corner between Section 14 & 14 of said T. 33N., R. 79W., S. 00° 02' 14" W., a distance of 60.00 feet to the point of beginning; thence S. 00° 02' 14" W., a distance of 590.00 feet to a point; thence S. 89° 19' 30" W., a distance of 500.00 feet to a point; thence N. 00° 02' 14" E., a distance of 590.00 feet to the point of beginning; all corners of this survey being marked with a standard brass cap monument, said lands containing a total of 6.772 acres as set forth by this plat.

NATRONA COUNTY SCHOOL DISTRICT No. 2, STATE OF WYOMING, a Body Corporate:

Attest: *Mary H. Hesk* Secretary
J. R. Pender President, Board of Trustees

STATE OF WYOMING
 COUNTY OF NATRONA

I, Arlan F. Waters of Casper, Wyoming do hereby certify that this plat was prepared from notes taken during an actual survey made by me during the month of November, 1967 and that such plat correctly represents such survey and the "MANOR HEIGHTS SCHOOL ADDITION TO THE CITY OF CASPER, NATRONA COUNTY, WYOMING"; such survey as represented hereon is correct to the best of my knowledge and belief.

Wyoming Registration L.S. 325 *Arlan F. Waters*
 Arlan F. Waters

Subscribed in my presence and sworn before me the 15th day of April, 1968.
 My Commission expires May 23, 1969.

STATE OF WYOMING
 COUNTY OF NATRONA

On this 16th day of April, 1968, before me personally appeared *Mary H. Hesk* and *J. R. Pender* President and Secretary respectively of Natrona County School District No. 2, State of Wyoming, a Body Corporate, and to me personally known and who executed the foregoing instrument and acknowledged that they executed the same in accordance with a Resolution of the Board of Trustees and as the free act and deed of said Board of Trustees, and did affix hereto the seal of said Body Corporate.
 Given under my hand and official seal this 16th day of April, 1968.
 My Commission expires on the 15th day of July, 1968.

PLAT APPROVED

Plat approved by the COMMUNITY PLANNING COMMISSION of Casper, Wyoming, and forwarded to the City Council of Casper, Wyoming, this 17th day of December, 1968, with recommendation that said plat be approved.

Grant B. Jensen
 Chairman

Thomas J. Bultel
 Secretary

CITY COUNCIL, City of Casper, Wyoming
 Ordinance No. 1579-A duly passed, adopted and approved on the 18th day of August, 1969.
Harry Johnson
 Mayor

BOARD OF COUNTY COMMISSIONERS, Natrona County, Wyoming By Resolution duly passed on the ___ day of ___ 19__.

Attest: *Lois E. Peterson*
 CITY CLERK

Attest: *Tom*
 COUNTY CLERK

Inspected and Approved:
Vincent Bronski
 CITY ENGINEER

Inspected and Approved:
George R. Hughes
 COUNTY SURVEYOR

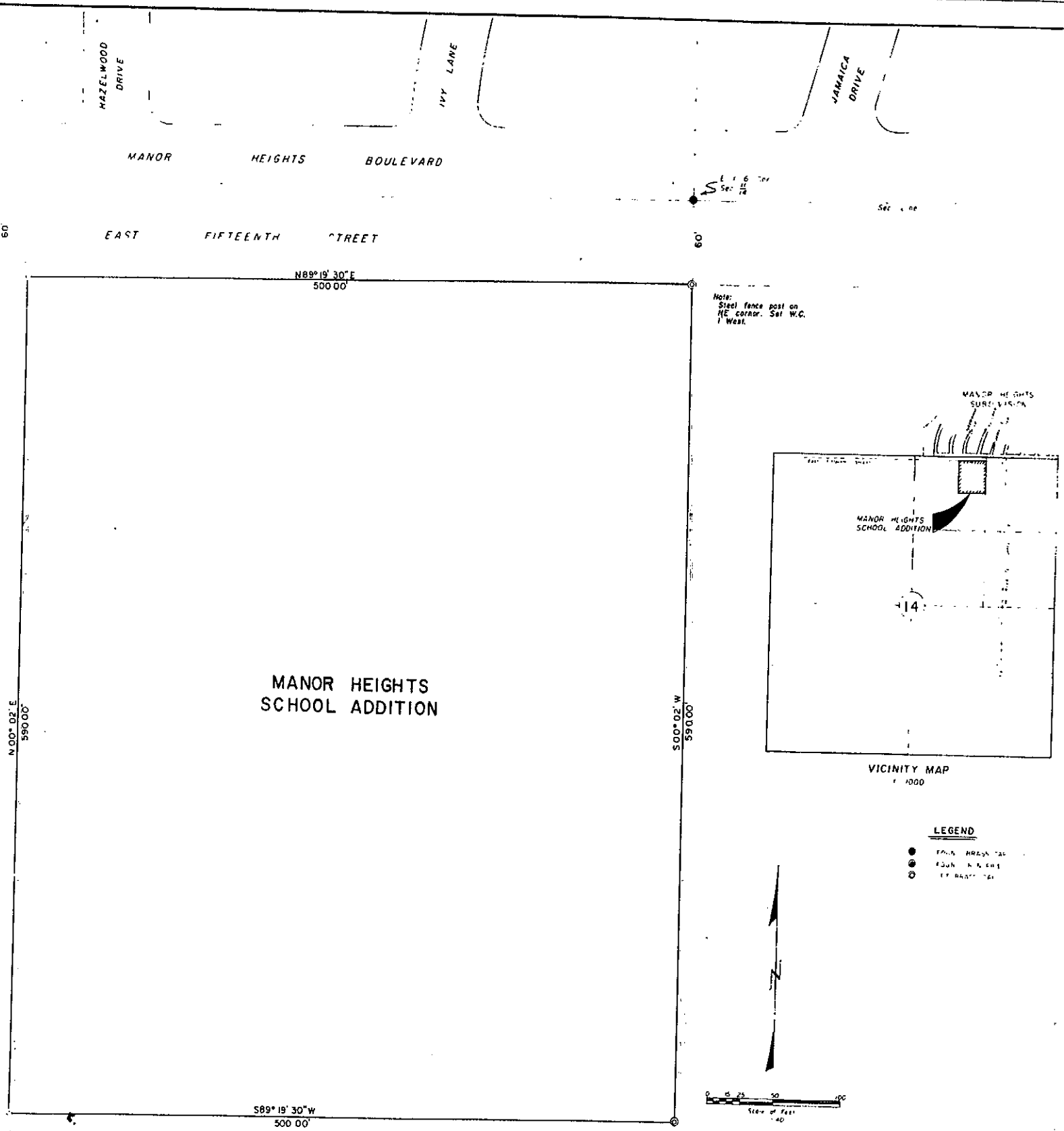

Note:
 Steel fence post on NE corner. Set W.C. 1' West.

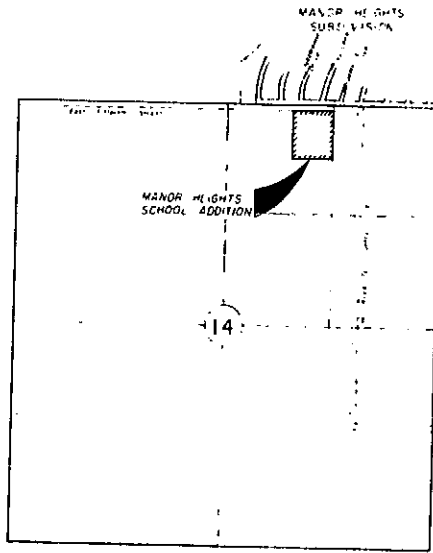

LEGEND

- TOWN BOUNDARY
- SECTION BOUNDARY
- CITY BOUNDARY

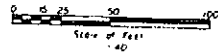

NE 1/6 Cor
 Sec 14

ATLAS REPRODUCTION

W.D. No.	File No.	Acres	Surveyed	Platted	Filed
355		6.772			