

- LEGEND**
- FOUND MONUMENT AS NOTED
  - SET ALUMINUM CAP
  - MEASURED DATA (26.02')
  - RECORD DATA

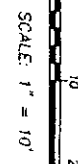

**CERTIFICATE OF SURVEYOR**  
STATE OF WYOMING }  
COUNTY OF NATRONA } SS

I, JAMES F. JONES, A REGISTERED PROFESSIONAL LAND SURVEYOR IN THE STATE OF WYOMING, LICENSE NO. 5529, HEREBY STATE THAT THIS PLAT WAS PREPARED FROM NOTES TAKEN DURING AN ACTUAL SURVEY MADE BY ME OR OTHERS UNDER MY DIRECT SUPERVISION IN THE MONTH OF JUNE, 2011, AND THAT THIS PLAT, TO THE BEST OF MY KNOWLEDGE AND BELIEF, CORRECTLY AND ACCURATELY REPRESENTS SAID SURVEY. ALL BOUNDARY PERIMETER CORNERS ARE WELL AND ACCURATELY MONUMENTED BY BRASS CAPS (OR AS NOTED) AS OF THE DATE OF THIS SURVEY AND THAT ALL LOT CORNERS SHALL BE MONUMENTED AS SHOWN UPON THIS PLAT UPON COMPLETION OF CONSTRUCTION OR WITHIN ONE YEAR OF THE DATE OF RECORDATION. ALL DIMENSIONS ARE EXPRESSED IN FEET AND DECIMALS THEREOF AND COURSES REFERRED TO THE TRUE MERIDIAN. ALL BEING TRUE AND CORRECT TO THE BEST OF MY KNOWLEDGE AND BELIEF.

THE FOREGOING INSTRUMENT WAS ACKNOWLEDGED BEFORE ME BY JAMES F. JONES THIS 21 DAY OF March, 2012.  
WITNESS MY HAND AND OFFICIAL SEAL  
MY COMMISSION EXPIRES 12/31/15



NOTARY PUBLIC

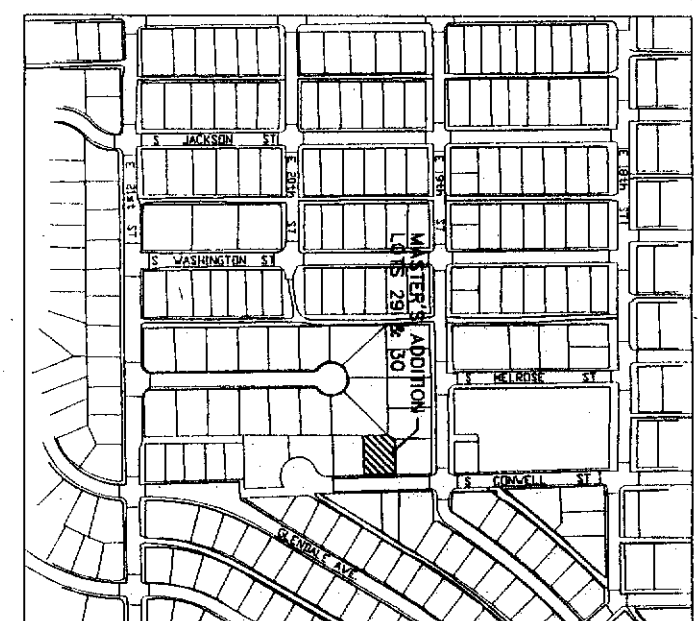

LOCATION & VICINITY MAP  
NO SCALE

**APPROVALS**

APPROVED BY THE CITY OF CASPER COMMUNITY DEVELOPMENT DIRECTOR THIS 22 DAY OF March, 2012.

INSPECTED AND APPROVED THIS 22 DAY OF March, 2012.

INSPECTED AND APPROVED THIS 22 DAY OF March, 2012.

**RECORDED**  
FILED FOR RECORD IN THE OFFICE OF THE COUNTY CLERK OF NATRONA COUNTY, WYOMING THIS 22 DAY OF MARCH, 2012.  
INSTRUMENT NO. 025502

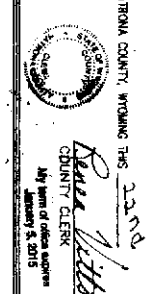

**NOTES**

1. ERROR OF CLOSURE EXCEEDS 1:50,000.
2. BASIS OF BEARINGS IS THE WYOMING STATE PLANE COORDINATE SYSTEM, EAST CENTRAL ZONE, NAD 1983/88.

**CERTIFICATE OF DEDICATION**

STATE OF WYOMING }  
COUNTY OF NATRONA } SS

THE UNDERSIGNED, BLACK POWDER PROPERTIES, LLC, DOES HEREBY CERTIFY THAT THEY ARE THE OWNER AND PROPRIETOR OF THE FOREGOING LANDS AND SUBDIVISION LOCATED IN AND BEING ALL OF LOT 22 OF THE MASTER'S ADDITION TO THE CITY OF CASPER, WYOMING, NATRONA COUNTY, WYOMING, AS DESCRIBED IN THE QUILTLAM DEED RECORDED JANUARY 31, 2011 AS INSTRUMENT NO. 903183, AND BEING MORE PARTICULARLY DESCRIBED AS FOLLOWS:

COMMENCING AT A FOUND BRASS CAP AT THE NORTHEAST CORNER OF THE ORIGINAL LOT 22, MASTER'S ADDITION, BEING THE POINT OF BEGINNING OF THE PARCEL BEING DESCRIBED AND THE POINT OF BEGINNING OF THIS LEGAL DESCRIPTION:

THENCE S01°01'16"E, ALONG THE EAST LINE OF SAID LOT 22, THE EAST LINE OF THIS PARCEL OF LAND, AND THE WEST LINE OF CONWELL STREET, 87.85 FEET TO AN ALUMINUM CAP SET THIS SURVEY AT THE SOUTHEAST CORNER OF SAID LOT 22 AND THE SOUTHEAST CORNER OF SAID PARCEL OF LAND;

THENCE N89°52'00"W, ALONG THE SOUTH LINE OF SAID LOT 22, THE SOUTH LINE OF SAID PARCEL OF LAND, AND THE NORTH LINE OF SAID LOT 29, 88.88 FEET TO THE SOUTHWEST CORNER OF SAID PARCEL OF LAND;

THENCE N00°00'10"W, ALONG THE EAST LINE OF SAID LOT 29, 43.92 FEET TO THE EAST LINE OF A 20.00 FOOT WIDE STRIP OF LAND BEING QUILTLAM TO ROGER JOEL BURNS AND DAWN RENEE BURNS AS DESCRIBED IN THE QUILTLAM DEED RECORDED AUGUST 3, 2000 AS INSTRUMENT NO. 558935, SAID SOUTHWEST CORNER BEING RETRANSCRIBED BY AN ALUMINUM CAP WITNESS CORNER SET THIS SURVEY LOCATED 2.5 FEET EAST OF SAID CORNER;

THENCE N00°00'10"W, ALONG THE WEST LINE OF THIS PARCEL OF LAND AND THE EAST LINE OF SAID BURNS PARCEL, 58.90 FEET TO AN ALUMINUM CAP SET THIS SURVEY AT THE NORTHEAST CORNER OF SAID BURNS PARCEL;

THENCE N84°59'57"W, ALONG THE WESTERN LINE OF THIS PARCEL OF LAND, AND THE EASTERN LINE OF A TRIANGULAR LAND OUTLINED TO STEVEN P. BLAESER AND JOOE S. BLAESER AS DESCRIBED IN THE QUILTLAM DEED RECORDED AUGUST 3, 2000 AS INSTRUMENT NO. 656937, 22.06 FEET TO AN ALUMINUM CAP SET THIS SURVEY AT THE MOST WESTERLY CORNER OF LAND OF THIS PARCEL OF LAND, SAID POINT BEING THE COMMON CORNER OF LOTS 9, 10 AND 22 OF THE MASTER'S ADDITION;

THENCE N26°47'49"E, ALONG THE LOT LINE COMMON TO LOTS 20 AND 22 OF THE MASTER'S ADDITION AND THE WESTERLY LINE OF THIS PARCEL OF LAND, 22.13 FEET TO A FOUND BRASS CAP AT THE NORTHWEST CORNER OF THIS PARCEL OF LAND AND THE NORTHWEST CORNER OF SAID LOT 22;

THENCE S89°47'49"E, ALONG THE NORTH LINE OF SAID LOT 22, THE NORTH LINE OF THIS PARCEL OF LAND, AND THE SOUTH LINE OF LOT 21, 97.34 FEET TO THE POINT OF BEGINNING.

THE ABOVE DESCRIBED TRACT OF LAND CONTAINS 0.19 ACRES, AND IS SUBJECT TO ANY RIGHTS-OF-WAY AND EASEMENTS, RESERVATIONS AND ENCUMBRANCES WHICH HAVE BEEN LEGALLY ACQUIRED.

THE PARCEL OF LAND AS IT APPEARS ON THIS PLAT IS DEDICATED WITH THE FREE CONSENT AND IN ACCORDANCE WITH THE DESIRES OF THE UNDERSIGNED OWNER AND PROPRIETOR, THE NAME OF THE SUBDIVISION SHALL BE "MASTER'S ADDITION, LOTS 29 & 30" AND THE OWNER HEREBY GRANTS TO THE PUBLIC AND PRIVATE UTILITY COMPANIES AN EASEMENT AND LICENSE TO LOCATE, CONSTRUCT, USE AND MAINTAIN CONDUITS, LINES, WRETS AND PIPES, ANY OR ALL OF THEM, UNDER AND ALONG THE STRIPS OF LAND MARKED "UTILITY EASEMENT" AS SHOWN PREVIOUSLY DEDICATED TO THE USE OF THE PUBLIC.

BLACK POWDER PROPERTIES, LLC  
BROWN LONGREN, MANAGING MEMBER

THE FOREGOING INSTRUMENT WAS ACKNOWLEDGED BEFORE ME BY BROWN LONGREN, MANAGING MEMBER OF BLACK POWDER PROPERTIES, LLC, OWNER THIS 21 DAY OF March, 2012.

WITNESS MY HAND AND OFFICIAL SEAL  
MY COMMISSION EXPIRES 12/31/12

MINOR BOUNDARY ADJUSTMENT PLAT  
AND VACATION OF  
LOT 22, MASTER'S ADDITION  
TO THE CITY OF CASPER, WYOMING  
AS  
**MASTERS ADDITION, LOTS 29 & 30**

TO THE CITY OF CASPER, WYOMING  
NATRONA COUNTY WYOMING  
NOVEMBER, 2011