

21/631 2/9/21

1322

Pocket 8
Folder 3

Chicago & North Western R.R.

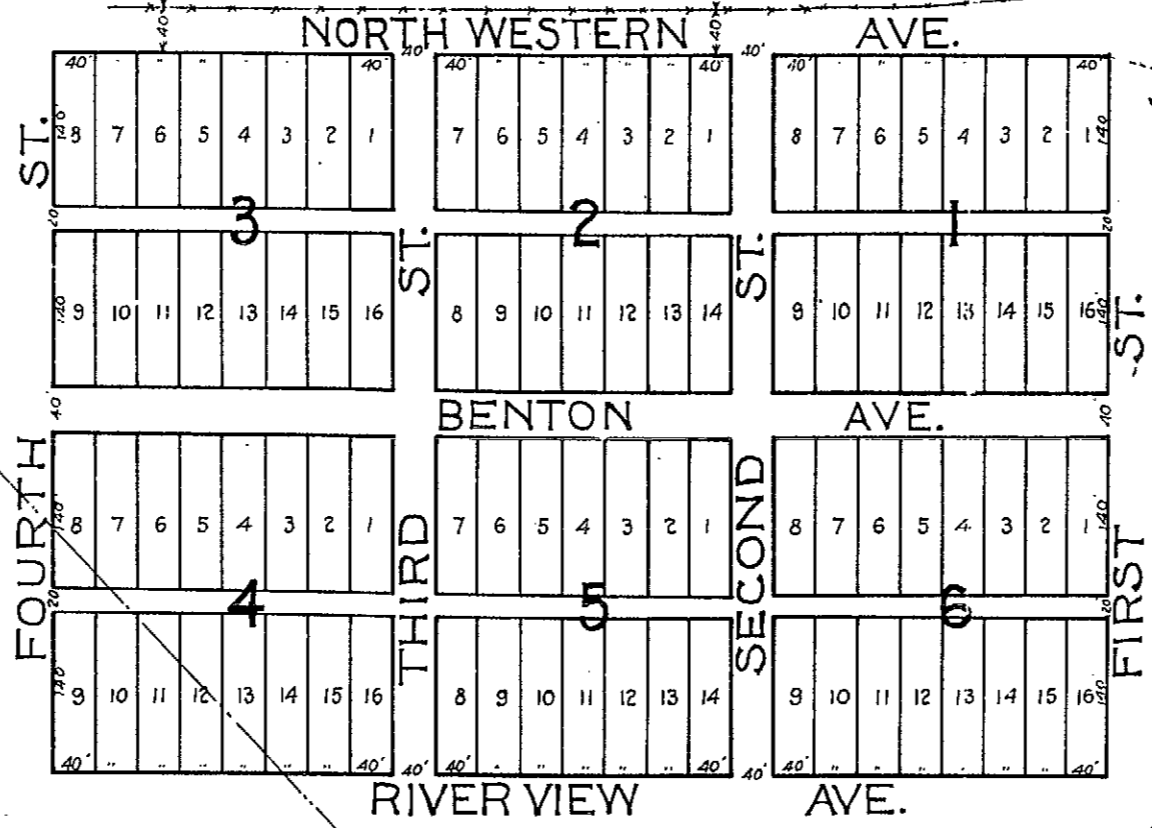

**MILLS
ADDITION
NATRONA COUNTY
WYOMING**
Scale 1 in = 100 ft.

CERTIFICATE OF ENGINEER

State of Wyoming } ss
County of Natrona }

I hereby certify that, on the 3rd to 12th day of April 1919, I surveyed and plotted the Mills Addition as shown on this Plat which is a correct delineation of said survey. All Block and Alley corners are marked by substantial stakes.

Wm. L. Baker
Engineers License No 31

SW 1/4 of NW 1/4 SEC. 7

Center of Sec. 7
Tp. 33 N. Rg. 79 W.

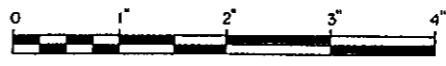

ATLAS REPRODUCTION

DEDICATION

Know all Men, by these Presents, That We, *James Miller and Homer Miller*, the owners of the tract of land described in the Certificate of Survey, and shown on this Plat, That we have caused the said tract to be surveyed and plotted, under the name of Mills Addition, as shown by this Plat and Engineer's Certificate, and that we do hereby dedicate the Streets, Avenues, and Alleys indicated on this Plat to Public Use.

James Miller _____
Homer Miller _____

State of Wyoming } ss
County of Natrona }

Be it known that on the 11th day of May, 1919, before me a Notary Public in and for said County, personally appeared *James Miller and Homer Miller*, and severally acknowledged that they were the identical persons whose names appear on the foregoing dedication and that they signed the above dedication as their free act and deed.

Wm. L. Baker
Witness my hand and Official Seal, this 11th day of May, 1919.

Wm. L. Baker Co.