

CERTIFICATE OF DEDICATION
STATE OF WYOMING
COUNTY OF NATRONA

The undersigned, the Amoco Refuse Agreement Joint Powers Board, does hereby certify that they are the Owner and Proprietor of the following parcel of land being situated in the Northern Utilities Addition No. 1, as per the plat recorded May 15, 1977 as instrument No. 210711. This parcel of land being described herein in the same plat as described in instrument numbers 817900 and 817910, and is more particularly described by metes and bounds as follows:

Commencing at a brass cap marking the northwest corner of said Section 8; Thence along the E. 1/4 of Lot 1 to the Point of Beginning of this right-of-way and a brass cap marking the southeast corner of said Section 8; Thence along the north line of the parcel and the south line of said Section 8, 100.00 feet to a brass cap set at the southeast corner of said Section 8; Thence along the west line of the 70.00 foot wide right-of-way for South Spruce Street; Thence S. 89° 42' 24" E., along the east line of the parcel and west right-of-way line, 229.42 feet to a brass cap marking the northeast corner of Lot 2 of said Northern Utilities Addition No. 1; Thence S. 0° 04' 42" E., continuing along the east line of the parcel, the east line of said Northern Utilities Addition No. 1, and the east line of the 70.00 foot wide right-of-way for West Madison Avenue and being located on the north line of the 200.00 foot wide right-of-way for West Madison Avenue and (retrieved by a brass cap) whiten corner set the survey 2.00 feet south of said corner;

Thence S. 89° 42' 24" E., along the south line of the parcel, the south line of said Lot 1, and said north right-of-way line, 288.56 feet to the southeast corner of the parcel of said Lot 1, and said point being located on the east line of the 50.00 foot wide right-of-way for South Walnut Street and referenced by a brass cap marking the southeast corner of said Lot 1; Thence N. 87° 20' 57" E., along the south line of said Street and along the south line of a parcel of land owned by Steve M. Olson, 156.18 feet to a brass cap set the survey at the southeast corner of said D'Sha parcel;

Thence N. 0° 04' 42" E., along the west line of this parcel and said north right-of-way line, 134.77 feet to the Point of Beginning;

The parcel of land as described above contains 2.48 acres, and is subject to any other rights-of-way and easements, restrictions and encumbrances which have been properly recorded.

This parcel of land, as it appears on this plat, is dedicated with the best interest and in accordance with the desire of the undersigned owner and proprietors. The survey of the same was made by the "C.O.P." No. 1, "Subdivision", and as a portion of the plat the owners hereby warrant all lines as described on the recorded plat of the Northern Utilities Addition No. 1 as shown on the plat as instrument No. 210711, and the Owners also warrant to the public and advise utility companies an understanding and license to locate, construct, use and maintain electric, gas, water, and pipes, any or all of them, under and along the strip of land marked "Utility Easement" as shown on this plat. All roads and streets shown herein have been previously dedicated to public use.

AMOCO REUSE AGREEMENT JOINT POWERS BOARD, OWNER
NEIL BENSON, CHAIRMAN
THE FOREGOING INSTRUMENT WAS ACKNOWLEDGED BEFORE ME BY NEIL BENSON, CHAIRMAN OF AMOCO REUSE AGREEMENT JOINT POWERS BOARD, OWNER THIS 21st DAY OF February, 2012.
WITNESS MY HAND AND OFFICIAL SEAL
NOTARY PUBLIC

CERTIFICATE OF SURVEYOR
STATE OF WYOMING
COUNTY OF NATRONA
I, JAMES F. JONES, A REGISTERED PROFESSIONAL LAND SURVEYOR IN THE STATE OF WYOMING, LICENSE NO. 5529, DO HEREBY STATE THAT THIS PLAT WAS PREPARED FROM NOTES TAKEN DURING AN ACTUAL SURVEY MADE BY ME OR UNDER MY DIRECT SUPERVISION IN THE MONTHS OF OCTOBER AND NOVEMBER, 2011, AND THAT THIS PLAT, TO THE BEST OF MY KNOWLEDGE AND BELIEF, CORRECTLY AND ACCURATELY REPRESENTS SAID SURVEY. ALL BOUNDARY CORNERS ARE WELL AND ACCURATELY MONUMENTED BY BRASS CAPS (OR AS NOTED) AS OF THE DATE OF THIS SURVEY AND THAT ALL LOT CORNERS HAVE BEEN MONUMENTED AS SHOWN UPON THE PLAT. ALL DIMENSIONS ARE EXPRESSED IN FEET AND DECIMALS THEREOF AND COURSES REFERRED TO THE TRUE MERIDIAN. ALL BEING TRUE AND CORRECT TO THE BEST OF MY KNOWLEDGE AND BELIEF.

THE FOREGOING INSTRUMENT WAS ACKNOWLEDGED BEFORE ME BY JAMES F. JONES THIS 22nd DAY OF February, 2012.
WITNESS MY HAND AND OFFICIAL SEAL
NOTARY PUBLIC

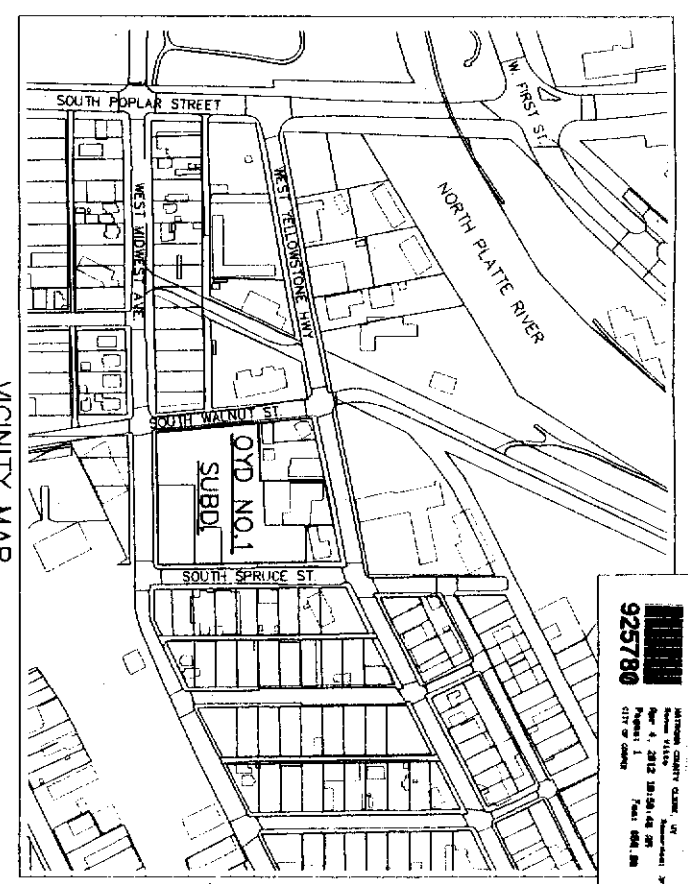

APPROVALS
APPROVED BY THE CITY OF CASPER PLANNING AND ZONING COMMISSION OF CASPER, WYOMING THIS 15th DAY OF February, 2012.
ATTEST: *[Signature]* SECRETARY
APPROVED BY THE CITY COUNCIL OF CASPER, WYOMING BY ORDINANCE NO. 7-16, DULY THIS 15th DAY OF February, 2012.
ATTEST: *[Signature]* CITY CLERK
INSPECTED AND APPROVED THIS 12th DAY OF March, 2012.
INSPECTED AND APPROVED THIS 9th DAY OF March, 2012.
CITY ENGINEER
MAYOR
CITY SURVEYOR

RECORDED
FILED FOR RECORD IN THE OFFICE OF THE COUNTY CLERK OF NATRONA COUNTY, WYOMING THIS 14th DAY OF March, 2012.
INSTRUMENT NO. 925780
By *[Signature]* County Clerk
NOTES
1. ERROR OF CLOSURE 1:1,950,000.
2. BASIS OF BEARINGS IS THE WYOMING STATE PLANE COORDINATE SYSTEM, EAST CENTRAL ZONE, NAD 1983/98, CONVERSION AT THE P.O.B. IS 08.004050.488358; COMBINED SCALE FACTOR IS 0.9999787315.
3. PUBLIC WATER AND SEWER WILL BE PROVIDED BY THE CITY OF CASPER, WYOMING.

FINAL PLAT AND VACATION OF
LOTS 1 AND 2 OF THE
NORTHERN UTILITIES ADDITION NO. 1
AND PLAT OF LAND IN A PREVIOUSLY UNPLATTED
PARCEL OF LAND IN THE W1/2NW1/4 OF
SECTION 9, T.33N., R.79W., 6TH P.M.
AS
OYD NO. 1 SUBDIVISION
AN ADDITION IN THE CITY OF CASPER
BEING A PORTION OF THE
W1/2NW1/4 OF SECTION 9
T.33N., R.79W., 6TH P.M.
NATRONA COUNTY WYOMING
OCTOBER 2, 2011

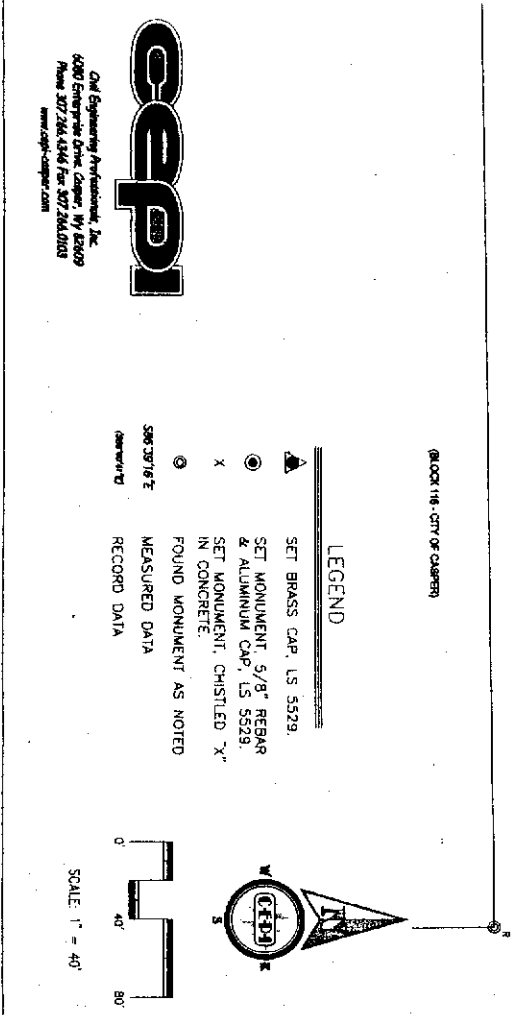

LEGEND
▲ SET BRASS CAP, LS 5529.
● SET MONUMENT, 5/8" REBAR & ALUMINUM CAP, LS 5529.
⊙ SET MONUMENT, CHISELED "X" IN CONCRETE.
⊙ FOUND MONUMENT AS NOTED
⊙ MEASURED DATA
⊙ RECORD DATA
SCALE: 1" = 40'
CASPERS ENGINEERING PROFESSIONALS, INC.
4000 Enterprise Center, Casper, WY 82409
Phone 307/266-4346 Fax 307/266-0100
www.caspers-engineering.com