

PLAT OF  
**"RIVER HEIGHTS"**  
 A SUBDIVISION OF A PORTION OF  
 THE W1/2SW1/4, SECTION 11  
 TOWNSHIP 33 NORTH, RANGE 80 WEST  
 SIXTH PRINCIPAL MERIDIAN  
 NATRONA COUNTY, WYOMING  
 PAGE 1 OF 2

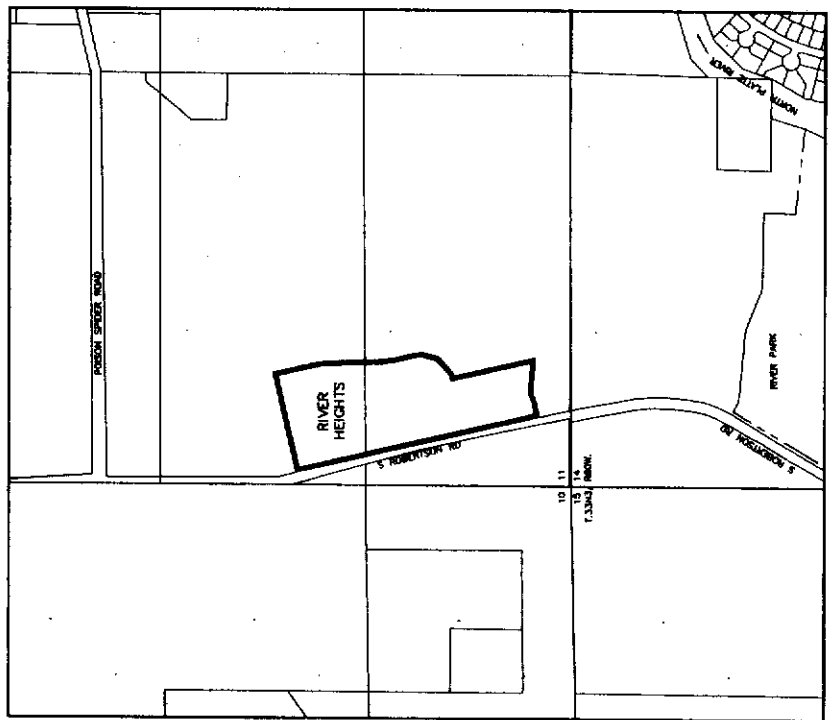

**APPROVALS**  
 APPROVED: Board of County Commissioners of Natrona County, Wyoming by Resolution passed this 28th day of May, 2013.  
 Attest: *Bill McDowell*, Board Chairman  
 APPROVED: City Council of the City of Casper, Wyoming by Resolution No. 13-1-14, duly passed, adopted and approved on the 21st day of May, 2013.  
 Attest: *Tom Clark*, City Clerk  
 APPROVED: Town Council of the Town of Mills, Wyoming by Resolution No. 13-1-14, duly passed, adopted and approved on the 21st day of May, 2013.  
 Attest: *Tom Clark*, Mayor  
 INSPECTED AND APPROVED on the 22nd day of May, 2013.  
 Attest: *Tom Clark*, County Planner  
 INSPECTED AND APPROVED on the 30th day of May, 2013.  
 Attest: *Tom Clark*, County Surveyor  
 INSPECTED AND APPROVED on the 10th day of May, 2013.  
 Attest: *Tom Clark*, County Health Department  
 Filed for Record in the Office of the County Clerk of Natrona County, Wyoming this 18th day of May, 2013.  
 Attest: *Tom Clark*, County Clerk

**CERTIFICATE OF SURVEYOR**  
 I, Steve M. Castles, of Casper, Wyoming hereby state that this plat was prepared from notes taken during actual surveys made by me or others under my direct supervision during the months of October 2012, and January through May, 2013 and that this map correctly represents said surveys. All monuments and boundaries shown on this map were measured and monumented by brass caps on the date of this map. All dimensions are expressed in feet and decimals thereof. All bearings are true and correct to the best of my knowledge and belief.  
 Wyoming Registration No. 6010 L.S.  
 Subscribed in my presence and sworn to before me by Steve M. Castles this 17th day of May, 2013.  
 My Commission Expires: June 29, 2013  
*Steve M. Castles*  
 Surveyor

**CERTIFICATE OF DEDICATION**  
 RIVER HEIGHTS DEVELOPMENT, LLC, hereby certifies that they are the owners and proprietor of the subdivision herein shown and that the same is located in Natrona County, Wyoming and being more particularly described by metes and bounds as follows:  
 Beginning at the northwesterly corner of the Parcel being described and a point in the easterly right-of-way line of Robertson Road and from said point the S7/16 corner corner to the Point of Beginning and along the northerly line of the Parcel being described N.78°31'20"E, 833.00 feet to the northwesterly corner of said Parcel; thence along the easterly line of the Parcel being described, S.13°08'40"E, 222.77 feet to a point of a curve; thence along the arc of a true curve to the right and having a radius of 1050.00 feet and through a central angle of 12°00'00", southeasterly, 219.91 feet and the chord of which bears S.7°08'40"E, 219.91 feet to the Point of Beginning; thence along the northerly line of the Parcel being described along the arc of a true curve to the right and having a radius of 600.00 feet and through a central angle of 12°00'00", southeasterly, 125.66 feet and the chord of which bears S.07°08'40"E, 125.66 feet to the point of tangency; thence, S.13°08'40"E, 117.30 feet to a point of a curve; thence along the arc of a true curve to the right and having a radius of 200.00 feet and through a central angle of 90°00'00", southeasterly, 314.16 feet and the chord of which bears S.31°31'20"W, 282.84 feet to a point; thence, S.13°08'40"E, 528.75 feet to the southeasterly corner of said Parcel; thence along the southerly line of the Parcel being described, N.86°36'06"W, 218.80 feet to the Point of Beginning; thence along the northerly line of the Parcel being described, having a radius of 100.00 feet and through a central angle of 23°22'48", southeasterly, 41.28 feet and the chord of which bears S.84°39'57"W, 41.08 feet to a point of tangency; thence, S.78°31'20"W, 100 feet to the southeasterly corner of said Parcel and a point in the easterly right-of-way line of said Robertson Road; thence along the westerly line of the Parcel being described and the easterly right-of-way line of said Robertson Road, N.13°08'40"W, 1576.99 feet to the Point of Beginning and containing 16.87 acres, more or less.  
 The subdivision of the foregoing described lands is with the free consent and in accordance with the desires of the above named owners and proprietors; the name of said subdivision shall be known as "RIVER HEIGHTS" and all streets as shown hereon are hereby dedicated to the public and the River Heights Home Owners Association and utility easements as shown hereon are hereby dedicated to the public. The River Heights Home Owners Association, construction, operation and maintenance of utility lines, conduits, ditches and drainage.

RIVER HEIGHTS DEVELOPMENT, LLC  
 421 South Center Street, Suite 201  
 Casper, WY 82601

WITNESSED AND APPROVED  
 KEITH P. TYLER, MANAGING MEMBER

**ACKNOWLEDGMENT**

State of Wyoming) SS  
 County of Natrona)  
 The foregoing instrument was acknowledged before me by Keith P. Tyler, Managing Member of River Heights Development, LLC on this 21st day of May, 2013.  
 Witness my hand and official seal:  
 My Commission Expires: June 29, 2013  
*Kevin S. Moore*  
 NOTARY PUBLIC



PLAT OF  
**"RIVER HEIGHTS"**  
 A SUBDIVISION OF PORTIONS OF  
 THE W1/2SW1/4, SECTION 11  
 TOWNSHIP 33 NORTH, RANGE 80 WEST  
 SIXTH PRINCIPAL MERIDIAN  
 NATRONA COUNTY, WYOMING  
 SCALE: 1"=50'  
 PAGE 2 OF 2

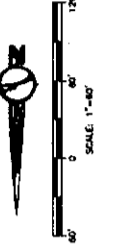

NOTE  
 ALL CURVES AT STREET INTERSECTIONS HAVE A 20 FOOT RADIUS.

- LEGEND
- RECORDED BRASS CAP CORNER
  - SET BRASS CAP
  - SUBDIVISION BOUNDARY
  - - - EASEMENT
  - MEASURED BEARING & DISTANCE

PLAT CLOSURE RATIO: IN EXCESS OF 1:100,000

DATUM:  
 GROUND DISTANCE - U.S. FOOT  
 BASIS OF BEARING - GEODETIC BASED ON GPS  
 WYOMING STATE PLANNING COORDINATE SYSTEM  
 ZONE, NAD83/86 AND ELEVATIONS REFER TO NAVD83.  
 ELEVATIONS ARE FOR REFERENCE ONLY AND ARE NOT TO BE  
 USED AS BENCHMARKS.

