

TIMBERLINE ADDITION

S. 69° 08' E. 385.62'
10' WIDE WATER & SANITARY SEWER EASEMENT

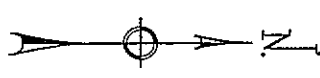

TIMBERLINE ADDITION

WIMBLEDON ADDITION

4.012 ACRES

N. 0° 52' E. 468.07'

M. 88° 16' E. 359.7' A.P. Brass Cop
N. 86° 49' E. 472.40'

ACCESS ROAD - INTERSTATE NO. 25 (88' x 88')

S. 86° 49' W. 384.27'

S. 1° 10' W. 441.00'

LINDE ADDITION

RUAN ADDITION

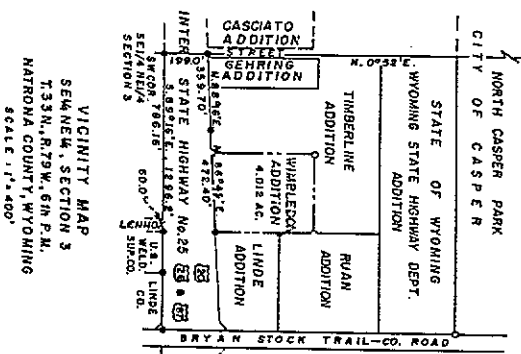

VICINITY MAP
SECTION 3
T. 33 N., R. 79 W., 6th P.M.
NATRONA COUNTY, WYOMING
SCALE: 1" = 400'

CERTIFICATE OF SURVEYOR

STATE OF WYOMING

WORTHINGTON, LENHART & ASSOC., INC.
200 South Lowell Street,
CASPER, WYOMING.
W.O. No. 7-11-D
W.O. No. 7-25-27
August 27, 1977

Submitted in my presence and sworn to before me this 21st day of September, 1977.
My Commission expires 12/31/1981

PLAT OF
"WIMBLEDON ADDITION"
TO THE CITY OF CASPER
STATE OF WYOMING
A SUBDIVISION
BEING A PORTION OF
SE 1/4 NE 1/4, SECTION 3
T. 33 N., R. 79 W. OF 6th PRINCIPAL MERIDIAN
NATRONA COUNTY, WYOMING
SCALE: 1" = 40'

CERTIFICATE OF DEDICATION

The Trustees under the Agreement and Declaration of Trust Establishing The NEBA Pension and Welfare Plan Made as of August 1, 1950 as Amended, hereby certify that the above and foregoing Subdivision, comprising a parcel being a portion of the SE 1/4 NE 1/4, Section 3, Township 33 North, Range 79 West of the 6th Principal Meridian, Natrona County, Wyoming, and being more particularly described as follows:
Beginning at the southeasterly corner of said parcel, which corner is also the southeasterly corner of the 2.28 acre Linde Addition, City of Casper, being the point of beginning as follows:
Commencing at the southwesterly corner of said SE 1/4 NE 1/4 of Section 3; Thence North 0 degrees 52 minutes East, 199 feet along the westerly line of said SE 1/4 NE 1/4 to an intersection with the northerly right of way line of U.S. Highway Interstate No. 25; Thence along said highway right of way North 88 degrees 16 minutes East, 359.70 feet to an angle point; Thence North 86 degrees 49 minutes East, 472.40 feet to an angle point, which point also marks the point of beginning and the southeasterly corner of the parcel being described; Thence from said point of beginning South 86 degrees 49 minutes West, 384.27 feet along the previously described highway right of way line to a point which marks the southwesterly corner of said parcel; Thence North 0 degrees 52 minutes East, 468.07 feet to the northwesterly corner of said parcel; Thence South 89 degrees 08 minutes East, 385.62 feet to the northeasterly corner of said parcel and a point on the westerly line of Ruan Addition, City of Casper; Thence South 1 degree 10 minutes West along the westerly line of said tract, the westerly line of said Linde Addition and the easterly line of the parcel being described, 441.00 feet to the point of beginning, containing 4.012 acres, more or less.
as appears on this plat, is with the free consent and in accordance with the desire of the undersigned owner and proprietor.

Done at Casper, Wyoming, this 14th day of December, 1977.
Tom Shalizio
TRUSTEE

STATE OF Wyoming ss.
COUNTY OF Natrona ss.
I, W. O. No. 7-25-27, Trustee on this 14th day of December, 1977.

PLAT APPROVED

Approved by the Community Planning Commission of Casper, Wyoming, this 21st day of September, 1977, and forwarded to the City Council of Casper, Wyoming with the recommendation that said plat be approved.
Chairman: [Signature]
Secretary: [Signature]

Approved by the City Council, City of Casper, Wyoming, by Resolution No. 77-67, duly passed, adopted and approved on the 21st day of September, 1977.
Mayor: [Signature]

ATTEST: [Signature] CITY CLERK
Inspected and approved on the 21st day of September, 1977.
[Signature] CITY ENGINEER
[Signature] COUNTY SURVEYOR

Filed for record in the Office of the County Clerk of Natrona County, Wyoming this 21st day of September, 1977.
Hazel Allen, Natrona County Clerk