

LEGEND

- 2" PIPE WITH BRASS CAP FOUND THIS SURVEY
- 1/2" REBAR WITH ALUMINUM CAP FOUND THIS SURVEY
- 3/4" REBAR WITH ALUMINUM CAP SET THIS SURVEY
- BOUNDARY ALLEN SUBDIVISION SECOND FILING

CERTIFICATE OF SURVEYOR

STATE OF WYOMING } ss
 COUNTY OF PARK

I, PAUL A. BLOUGH, A PROFESSIONAL LAND SURVEYOR REGISTERED IN THE STATE OF WYOMING BY REGISTRATION No. 2832, HEREBY CERTIFY:

THAT BETWEEN OCT. 27, 1992 & JULY 19, 1995, THE ALLEN SUBDIVISION, SECOND FILING SHOWN HEREON, WAS SURVEYED UNDER MY DIRECTION;

THAT THE LAND SURVEYED IS CORRECTLY DESCRIBED IN THE OWNERS CERTIFICATE OF DEDICATION, AND THE PLAT ACCURATELY SHOWS THE CORRECT LOCATION AND DIMENSIONS OF THE LOTS, EASEMENTS, STREETS AND ALLEYS OF SAID SUBDIVISION;

THAT THE REQUIREMENTS OF W.S. 26-11-101 THROUGH 26-11-110 WERE COMPLIED WITH AND MONUMENTS AND LOT CORNERS SHOWN AND DECEASED HEREON WERE ACTUALLY SET;

THAT ALL ELEMENTS OF THE SURVEY CLOSE TO AN ACCURACY OF ONE PART IN FIVE THOUSAND OR BETTER AND DIMENSIONS OF LOTS ARE GIVEN IN FEET AND DECIMALS OF A FOOT, AND ANY SURPLUS OR DEFICIENCY IS DISTRIBUTED UNIFORMLY IN PROPORTION TO THE MEASUREMENTS SHOWN ON THIS PLAT;

THAT THE NORTH LINE OF LOT 5 OF SECTION 3, T. 22 N., R. 102 W., 601 P.M., RESUBDIVISION PARK COUNTY WYO. BEARING S 89° 56' 00" E WAS USED AS THE BEARING BASE FOR ALL BEARINGS SURVEYED AND SHOWN UPON THIS PLAT.

IN WITNESS WHEREOF I HAVE SET MY HAND AND SEAL THIS 24th DAY OF FEB. 1995.

Paul A. Blough
 PAUL A. BLOUGH
 WYO. L.S. REGISTRATION No. 2832



STATE OF WYOMING } ss
 COUNTY OF PARK

THE FOREGOING CERTIFICATE WAS ACKNOWLEDGED BEFORE ME THIS 24th DAY OF FEBRUARY, 1995.

WITNESS MY HAND AND OFFICIAL SEAL Mary C. Wisnes
 NOTARY PUBLIC

CERTIFICATE OF DEDICATION

STATE OF WYOMING } ss
 COUNTY OF PARK

WE, THE UNDERSIGNED, HEREBY CERTIFY THAT WE ARE THE OWNERS AND PROPRIETORS OF LOTS 1, 2, 3 AND 4 OF THE ALLEN SUBDIVISION WITHIN THE CITY OF CODY PARK COUNTY, WYOMING.

THAT WE HAVE CAUSED SAID DESCRIBED LAND TO BE SURVEYED AND PLATTED AS SHOWN HEREON AS THE ALLEN SUBDIVISION, SECOND FILING; THAT THE SUBDIVISION AS APPEARS ON THIS PLAT IS WITH THE FREE CONSENT AND IN ACCORDANCE WITH THE DESIRES OF THE UNDERSIGNED OWNERS AND PROPRIETORS, AND THAT WE HEREBY DEDICATE AND SET APART THE STREET SHOWN HEREON TO THE USE OF THE GENERAL PUBLIC FOREVER. WE HEREBY RELEASE AND RELINQUISH ALL RIGHTS OF HOMESTEAD.

IN WITNESS WHEREOF WE HAVE HEREON SET OUR HAND THIS 20th DAY OF JANUARY, 1995.

Douglas H. Allen *Yvonne D. Allen* *Walter T. Phipps*
 DOUGLAS H. ALLEN YVONNE D. ALLEN WALTER T. PHIPPS

STATE OF WYOMING } ss
 COUNTY OF PARK

THE FOREGOING CERTIFICATE WAS ACKNOWLEDGED BEFORE ME THIS 20th DAY OF JAN, 1995.

WITNESS MY HAND AND OFFICIAL SEAL Mary C. Wisnes
 NOTARY PUBLIC

MY COMMISSION EXPIRES: SEPT. 26, 1996

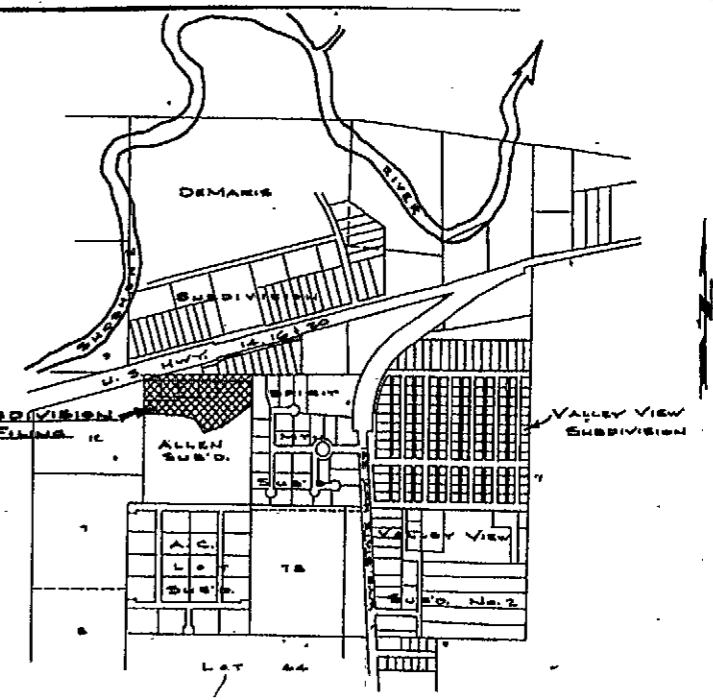
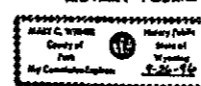

VICINITY MAP
 SCALE: 1" = 1000'

APPROVALS

CITY PLANNING AND ZONING BOARD

APPROVED THIS 12th DAY OF JANUARY, 1995 BY THE CITY PLANNING AND ZONING BOARD, CODY, WYOMING

BY CHAIRMAN: *Norman Parker*
 NORMAN PARKER

CITY COUNCIL APPROVAL

APPROVED THIS 18th DAY OF JANUARY, 1995 BY THE CITY COUNCIL OF CODY, WYOMING.

BY: *Jack T. Shuter* ATTEST: *James S. Smiley*
 JACK SHUTER - MAYOR JAMES S. SMILEY - CITY CLERK

STATE OF WYOMING } ss
 COUNTY OF PARK

THE FOREGOING APPELAL WAS ACKNOWLEDGED BEFORE ME BY JACK SHUTER, MAYOR AND JAMES S. SMILEY, CITY CLERK, THIS 24th DAY OF FEBRUARY, 1995.

WITNESS MY HAND AND OFFICIAL SEAL: Mary C. Wisnes
 NOTARY PUBLIC

MY COMMISSION EXPIRES: SEPT. 26, 1996



COUNTY CLERK'S CERTIFICATE

THIS PLAT WAS FILED FOR THE PUBLIC RECORD IN THE OFFICE OF THE CLERK, PARK COUNTY, WYOMING AT 2:08 O'CLOCK P.M. ON THE 28 DAY OF FEBRUARY, 1995, A.D., AND IS DUPLY RECORDED IN BOOK 2, PAGE No. 77.

Ralph Fantaria 3/11/95
 PARK COUNTY CLERK DEPUTY

PLAT SHOWING
ALLEN SUBDIVISION
SECOND FILING

A SUBDIVISION OF LOTS 1, 2, 3 AND 4 OF THE ALLEN SUBDIVISION WITHIN THE CITY OF CODY, WYOMING