

MOUNTAIN SHADOWS SUBDIVISION
 LOT 3 LOT 2 LOT 1

PLAN
 SCALE: 1" = 20'

Richard W. Heabler
 Notary Public

CERTIFICATE OF DEDICATION

STATE OF WYOMING } 55
 COUNTY OF PARK

WE, THE UNDERSIGNED, DO HEREBY CERTIFY AS FOLLOWS: WE ARE THE OWNERS AND PROPRIETORS OF TRACT "C" OF THE MOUNTAIN SHADOWS SUBDIVISION - SECOND FILING WITHIN LOT 74-F OF LOT 74, T. 55 N., R. 99 W. OF THE 6TH PM, CITY OF POWELL, PARK COUNTY, WYOMING, ACCORDING TO THE GOVERNMENT RESURVEY.

WE HAVE CAUSED SAID LAND TO BE FURTHER SUBDIVIDED, SURVEYED AND PLATTED AS SHOWN HEREON. THE SUBDIVISION OF SAID LAND, AS APPEARS ON THIS PLAT, IS WITH THE FREE CONSENT AND IN ACCORDANCE WITH THE DESIRES OF THE UNDERSIGNED OWNERS AND PROPRIETORS. THE SUBDIVISION SHALL BE KNOWN HEREAFTER AS DENNION SUBDIVISION NO. 3. WE HEREBY RELEASE AND RELINQUISH ALL RIGHTS OF HOMESTEAD. WE HEREBY DEDICATE AND SET APART THE UTILITY EASEMENTS SHOWN HEREON TO THE USE OF THE GENERAL PUBLIC.

IN WITNESS WHEREOF WE HAVE HERETO SET OUR HAND THIS 21ST DAY OF MARCH, 1963.

DENNION CONSTRUCTION, INC.
Daniel D. Dennion
 DANIEL D. DENNION
 PRESIDENT

ATTEST:
Lynn H. Dennion
 LYNN H. DENNION
 SECRETARY-TREASURER

STATE OF WYOMING } 55
 COUNTY OF PARK

THE FOREGOING CERTIFICATE OF DEDICATION WAS ACKNOWLEDGED BEFORE ME BY DANIEL D. DENNION, PRESIDENT, AND LYNN H. DENNION, SECRETARY-TREASURER, THIS 22ND DAY OF MARCH, 1963. WITNESS MY HAND AND OFFICIAL SEAL.

My Commission Expires 7-10-65
Anne W. Scheller
 NOTARY PUBLIC

CERTIFICATE OF SURVEYOR

STATE OF WYOMING } 55
 COUNTY OF PARK

I, DARVIN D. DIETZ, OF POWELL, WYOMING, HEREBY CERTIFY THAT BETWEEN SEPTEMBER 10, 1957 AND MARCH 8, 1963, DENNION SUBDIVISION NO. 3 WAS SURVEYED BY ME OR UNDER MY DIRECTION; THAT SAID SUBDIVISION IS CORRECTLY DESCRIBED IN THE OWNER'S CERTIFICATE OF DEDICATION ON THIS PLAT WHICH IS DRAWN TO A TOLERANCE OF 1/16" = 20 FEET. THE DIMENSIONS OF LOTS ARE GIVEN IN FEET AND DECIMALS OF A FOOT, AND ANY SURPLUS OR DEFICIENCY IS DISTRIBUTED UNFORMALLY IN PROPORTION TO THE MEASUREMENTS SHOWN ON THIS PLAT. THE EAST LINE OF MOUNTAIN SHADOWS SUBDIVISION - SECOND FILING, BEARING N 00° 02' E, WAS USED AS THE BASIS FOR ALL BEARINGS SHOWN. LOT CORNERS ARE AS SHOWN ON THIS PLAT. THE INTERIOR LOT LINES SHOWN ARE INTENDED TO PASS DIRECTLY THRU THE PARTY WALLS BETWEEN EACH UNIT OF THE TOWNHOUSE STRUCTURE. EACH LOT BEARS ITS OWN NUMBER. NOTE THAT THE SOUTH UNIT (LOTS 1 THROUGH 8) HAS NOT BEEN CONSTRUCTED YET AND IT MUST BE THE CONTRACTOR'S RESPONSIBILITY TO USE OUR LOT CORNERS TO PLACE THE WALLS PROPERLY.

WYOMING REGISTRATION NO. 596 RE. & L.S.
Darvin D. Dietz
 DARVIN D. DIETZ

LEGEND

- BOUNDARY OF DENNION SUBDIVISION NO. 3 SHOWN THUS: ————
- INTERIOR LOT LINES SHOWN THUS: - - - - -
- ADJACENT LOT LINES SHOWN THUS: - - - - -
- EXISTING TOWNHOUSE BUILDING SHOWN THUS: []
- EXISTING UTILITY EASEMENTS SHOWN THUS: []
- ORIGINAL CORNER FOUND REPLACED WITH STAMPED BRASS CAP SET THIS SURVEY SHOWN THUS: []
- 5" x 10" REBAR WITH ALUMINUM CAP SET AS PROPERTY CORNER THIS SURVEY SHOWN THUS: []
- MOUNTAIN SHADOWS SUBDIVISION CORNERS SHOWN THUS: []
- 2" x 30" GI PIPE WITH STAMPED BRASS CAP SET AS WITNESS CORNER THIS SURVEY SHOWN THUS: []
- FUTURE TOWNHOUSE & STORAGE BUILDINGS REQUIRING PROPER PLACEMENT BY CONTRACTOR SHOWN THUS: []
- 7" DISELED IN CONCRETE AS PROPERTY CORNER THIS SURVEY SHOWN THUS: []
- PRE-FILED EASEMENTS SHOWN THUS: []

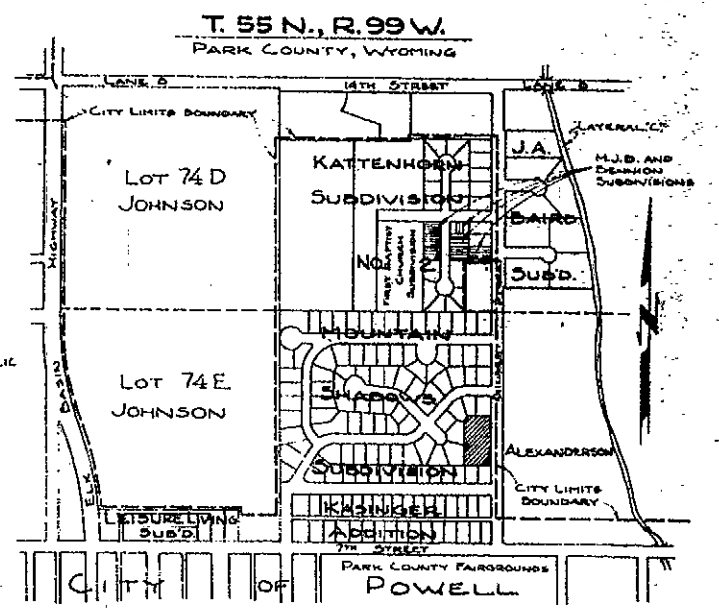

VICINITY MAP
 SCALE 1" = 500'

APPROVALS

APPROVED BY THE PLANNING AND ZONING COMMISSION OF THE CITY OF POWELL, WYOMING, THIS 21ST DAY OF MARCH, 1963.

Richard W. Heabler
 SECRETARY

Ross Buchanan
 CHAIRMAN

APPROVED THIS 21ST DAY OF MARCH, 1963, BY THE CITY COUNCIL OF POWELL, WYOMING.

BY: *Richard W. Heabler*
 RICHARD W. HEABLER - MAYOR

ATTEST: *Ross Buchanan*
 ROSS BUCHANAN - CITY CLERK

STATE OF WYOMING } 55
 COUNTY OF PARK

THE FOREGOING WAS ACKNOWLEDGED BEFORE ME BY RICHARD W. HEABLER, MAYOR, AND ROSS BUCHANAN, CITY CLERK, THIS 22ND DAY OF MARCH, 1963. WITNESS MY HAND AND OFFICIAL SEAL.

My Commission Expires 1-1-1965
Gladys R. Swaborn
 NOTARY PUBLIC

BENNION CONSTRUCTION, INC.
 POWELL, WYOMING

PLAT SHOWING
BENNION SUBDIVISION NO. 3
 A RESUBDIVISION OF
 TRACT "C" - MOUNTAIN SHADOWS SUBDIVISION (SECOND FILING)
 WITHIN
 LOT 74-F OF LOT 74, T. 55 N., R. 99 W. - SIXTH PM,
 CITY OF POWELL, PARK COUNTY, WYOMING.

GRAHAM, DIETZ & ASSOCIATES - CONSULTING ENGINEERS