

Detail Plat.
Scale: 1 Inch = 200 feet.

Certificate of Surveyor

STATE OF WYOMING } ss.
County of Park
I, William H. Greener, of Cody, Wyoming, hereby certify that during the period from the 18th of July, to the 25th of September, 1972, that the Cedar Mountain Ranchetts Subdivision No. 2, was surveyed by me, and is correctly described in the Certificate of Dedication, that the same is correctly shown on this plat which is drawn to a scale of 1 Inch to 200 feet. Dimensions are given in feet and decimals of feet, lot corners are marked as described on this plat, and in the legend. Any surplus or deficiency is distributed uniformly in proportion to the measurements shown hereon. Each lot bears its respective number.

William H. Greener
William H. Greener,
Surveyor,
Cody, Wyoming.

Wyo. Reg. No. 135, L.S.

Apparent error in last
Certificate of Dedication.

STATE OF WYOMING } ss.
County of Park
This certifies that Irvin R. Gerber, and Wilma J. Gerber, husband and wife, of Cody, Wyoming, are the owners and proprietors of a tract of land, shown on this plat as the Cedar Mountain Ranchetts Subdivision No. 2, said subdivision being described as a portion of the West Half of the East Half of Lot 56, Resurvey, formerly designated as the West Half of the Southeast Quarter of Section 19, under the Original Survey, in Township 52 North, Ranges 102 & 103 West of the Sixth Principal Meridian, in Park County, Wyoming, which tract of land may be more particularly described by metes and bounds as follows:

Beginning at a point on line 1-4, of said Lot 56, Resurvey, which point bears North 89° 58' West, at a distance of 89.3 feet, from a brass cap corner, designated as A.P. 46, and set by the U.S. Department of the Interior, Bureau of Land Management, said point also being the northeast corner of the Cedar Mountain Ranchetts Subdivision, thence bearing South 0° 06' East, along the east boundary of said subdivision, for a distance of 2640.38 feet, to the southeast corner of said subdivision, and to the south line of said Lot 56, Resurvey, thence bearing South 89° 56' East, along the south boundary of said Lot 56, Resurvey, for a distance of 917.1 feet, thence bearing North 0° 05' West, for a distance of 2640.9 feet, more or less, to the north boundary line of said Lot 56, Resurvey, thence bearing North 89° 58' West, along said north boundary line of said Lot 56, Resurvey, for a distance of 917.5 feet, more or less, to the point of beginning, said subdivision to contain 55.61 acres, more or less.

This further certifies that the owners have caused this tract of land to be surveyed and platted as the Cedar Mountain Subdivision No. 2, as shown on this plat, and on the Certificate of Surveyor, and that the roads as shown hereon, are hereby dedicated to the public use, forever. Homestead rights are hereby relinquished.

In witness whereof, the said owners have hereunto affixed their signatures on this 25th day of September 1972.

Irvin R. Gerber
Irvin R. Gerber
Wilma J. Gerber
Wilma J. Gerber.

STATE OF WYOMING } ss.
County of Park

The foregoing instrument was acknowledged before me this 25th day of September 1972.

D. K. Stott
Notary Public.

My commission expires: Nov. 4, 1975.

Saai:

Legend:-

- Lot corners marked 3/4" x 14" Iron pipe, driven to ground level, shown thus:
- Existing public survey corners found during this survey, shown thus:
- Subdivision boundaries shown thus:
- Original Survey Section Corners shown thus:

10 October
72 4:40 P
Egg
Eva E. Larson
Gladys Rickman
25th

Cedar Mountain Ranchetts Subdivision No. 2,

located in the West Half of the East Half, of Lot 56, Resurvey, also designated as the West Half of the Southeast Quarter, of Section 19, Original Survey, in Township 52 North, Ranges 102 & 103 West, of the Sixth Principal Meridian, in Park County, Wyoming.
William H. Greener, Surveyor, Cody, Wyoming.

Approval:

Approved this 4 day of October 1972, by the commissioners of Park County, Wyoming, subject to the provisions of Section 5, Park County Policy on the approval of subdivision and townsite plats, as adopted August 7th, 1962.
Alena Stutzman
by: Chairman.
Attest: *Eva E. Larson*
County Clerk.

Seal:

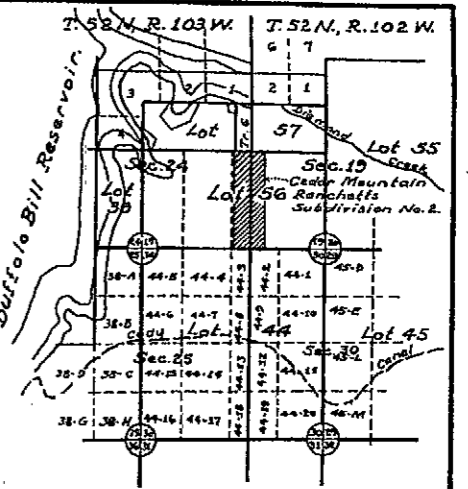

Location Plat.
Scale: 2 Inches = 1 Mile.