

Scale 1" = 30'

**CERTIFICATE OF SURVEYOR**

I, Richard E. Myrick, a professional engineer and land surveyor, registered in the State of Wyoming, by registration number 666 P.E. & L.S., hereby certify that between the dates April 1, 1986 and April 30, 1986, the Dennis Subdivision shown hereon was surveyed by me, and certify that the land surveyed is correctly described in the owner's Certificate of Dedication and that the subdivision thereof is correctly shown on this plat, and was made from an accurate survey of said property by me, and correctly shows the location and dimensions of the lots, easements, and exterior roads, of said subdivision in compliance with the Park County Subdivision Regulations; and lost or obliterated government land corner monuments were restored as required, and the requirements of W.S. 36-11-101 through 36-11-110 were complied with, and that monuments and lot corners marking this survey were actually set and the monuments are as described hereon, and that all elements of the survey close to an accuracy of one part in five-thousand or better.

In Witness Whereof I have set my hand and seal this 28th day of April, 1986 A.D.

*Richard E. Myrick*  
Richard E. Myrick PE & LS 666

State of Wyoming ) ss  
County of Park )

The foregoing Certificate was acknowledged before me by Richard E. Myrick this 28th day of April, 1986 A.D.  
Witness my hand and Official Seal

My commission expires July 16, 1989  
*Ordway R. Buelow*  
Notary Public

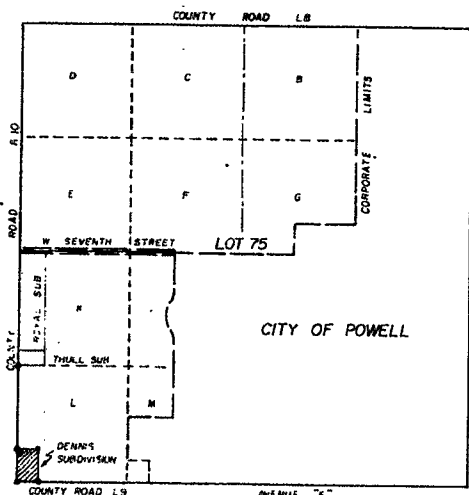
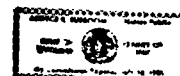

R.99W  
LOCATION MAP  
SCALE 1"=100'

**LEGEND**

CORNERS FOUND IN PLACE  
1" NO. 5 ALUMINUM CAP SET THIS SURVEY  
SUBDIVISION BOUNDARY  
EASEMENT W/ WIDTH AS INDICATED

NUMBER OF LOTS IN SUBDIVISION  
TOTAL ACREAGE IN SUBDIVISION

RECORDED BEARING (NORTH)  
ACTUAL BEARING

**CERTIFICATE OF DEDICATION**

The undersigned, do hereby certify that I am the owner of the real property described as follows: the South 5/7 feet of the West 254 feet of Farm Unit "L", being the SW 1/4 of Lot 75, resurvey, and also being the SW 1/4 SW 1/4 of Section 10, original survey, in T. 55 N., R. 99 W., 6th P.M., Park County, State of Wyoming, which may be more particularly described as follows: Beginning at the southwest corner of said Farm Unit "L", according to the Farm Unit Plat, which point is also the southwest corner of Lot 75, resurvey, and is also the southwest corner of Section 10, original survey, in T. 55 N., R. 99 W., 6th P.M., Park County, Wyoming, thence South 89° 51' East along the South boundary of said lot 75 for a distance of 254 feet, thence North parallel with the West boundary of said lot 75 for 57 feet, thence North 89° 51' West, parallel with the South boundary of said lot 75, for a distance of 254 feet to a point on the West boundary of said lot 75, thence due South along the West boundary of said lot 75 for 57 feet, to the point of beginning, said parcel of land containing 2.08 acres, more or less, of which 1.68 acres are in lots, and 0.40 acre is in public road right-of-ways; and have laid out, platted and subdivided into lots the Dennis Subdivision, in the County of Park, Wyoming, with the free consent and in accordance with the desires of the undersigned owner; and do hereby grant to Park County, Wyoming, for the public use of the right-of-ways shown hereon and the public lands shown and the utility easements so noted hereon and do further state that I hereby release and relinquish all rights of homestead.

EXECUTED THIS 30th DAY OF May, 1986 A.D.

*Barnard A. Stingley*  
Barnard A. Stingley (a single man)

State of Wyoming ) ss  
County of Park )

The foregoing Certificate of Dedication was acknowledged by Barnard A. Stingley, a single man, this 30th day of May, 1986 A.D.

Witness my hand and Official Seal

My commission expires August 16, 1989  
*Richard E. Myrick*  
Notary Public

**PLANNING AND ZONING COMMISSION CERTIFICATE**

This plat is recommended for approval by the Board of County Commissioners, Park County, Wyoming, on this 20th day of May, 1986 A.D.

Attest: *Louise Messner*  
Secretary

**COUNTY COMMISSIONERS CERTIFICATE AND SUBDIVISION PERMIT**

This plat is hereby approved and a subdivision permit issued by the Board of County Commissioners of Park County, Wyoming, this 3rd day of June, 1986 A.D., for filing and recording with the Clerk of Park County, Wyoming, and for the conveyance to the County of Park the public dedications shown hereon; subject to the provision that the County of Park will not be obligated to finance, construct, or maintain any improvements within this subdivision except as specifically agreed by the County of Park and further said that the Board of County Commissioners will not maintain roads or other improvements dedicated to the public until they are constructed and completed to the satisfaction of the Board of County Commissioners, and accepted by the proper resolution, in its complete discretion.

DATED THIS 3rd DAY OF June, 1986 A.D.

*James H. Coe*  
Chairman  
Park County Commissioners

Witness my hand and official seal of the County of Park this 3rd day of June, 1986 A.D.

ATTEST: *Marie Fontaine*  
Park County Clerk

**COUNTY CLERKS CERTIFICATE**

This plat was filed for the public record in the Office of the Clerk, Park County, Wyoming, at 1:45 o'clock P.M. on the 10th day of June, 1986 A.D. and is duly recorded in Book 1, Page Number 29.

Reception No. 229316  
*Marie Fontaine*  
Park County Clerk

By: *James H. Coe*  
Deputy

**CITY OF POWELL CERTIFICATE**

This plat is hereby approved by the City Council of the City of Powell, Wyoming, this 27th day of May, 1986 A.D.

Attest: *Harold E. Borcher*  
City Clerk Mayor

**NOTE:**

The owner of Dennis Subdivision warrants to purchasers of any lots within this subdivision that the purchasers have no rights to the natural flow of any stream or river, within or adjacent to Dennis Subdivision, and that Wyoming law does not recognize any riparian rights to the natural flow of a stream or river for persons living on the bank of the stream or river.

PLAT IN  
DENNIS SUBDIVISION  
BEING PART OF: LOT 75-L, LOT 75,  
T. 55 N., R. 99 W.  
PARK COUNTY, WYOMING

Prepared April, 1986