

SCALE: 1" = 100'

LEGEND

- SUBDIVISION BOUNDARY SHOWN THUS _____
- PROPOSED LOT LINES SHOWN THUS _____
- UTILITY EASEMENTS SHOWN THUS _____
- ADJACENT PROPERTY LINES SHOWN THUS _____
- DRASS CAP SET THIS SURVEY SHOWN THUS _____
- PROPERTY CORNERS SET THIS SURVEY (REDAR W/ALUMINUM CAP) SHOWN THUS _____
- WITNESS CORNERS SET THIS SURVEY (REDAR W/ALUMINUM CAP) SHOWN THUS _____
- WITNESS CORNER FOUND THIS SURVEY (DRASS CAP) SHOWN THUS _____
- STREET P.I. MONUMENT W/DOX SET THIS SURVEY SHOWN THUS _____
- STREET P.I. MONUMENT W/O DOXES SET THIS SURVEY SHOWN THUS _____
- STREET AND HIGHWAY CENTERLINES SHOWN THUS _____
- McMILLIN DITCH AND UTILITY EASEMENT SHOWN THUS _____

NOTE

1. DISTANCES SHOWN ON CURVED LINES ARE ARC LENGTH DISTANCES.

CERTIFICATE OF SURVEYOR

STATE OF WYOMING } 55
COUNTY OF PARK

I, DARVIN D. DIETZ OF CODY, WYOMING HEREBY CERTIFY THAT; DURING THE PERIOD FROM JANUARY 9, 1984 TO MARCH 14, 1984, THE FRANK SUBDIVISION WAS SURVEYED BY ME AND UNDER MY DIRECTION; THAT SAID SUBDIVISION IS CORRECTLY DESCRIBED IN THE OWNER'S CERTIFICATE OF DEDICATION ON THIS PLAT WHICH IS DRAWN TO A SCALE OF 1 INCH EQUALS 100 FEET. THE WIDTHS OF STREETS AND THE DIMENSIONS OF LOTS ARE GIVEN IN FEET AND DECIMALS OF A FOOT, AND ANY SURPLUS OR DEFICIENCY IS DISTRIBUTED UNIFORMLY IN PROPORTION TO THE MEASUREMENTS SHOWN ON THIS PLAT. EACH LOT BEARS ITS OWN NUMBER. ALL LOT CORNERS ARE AS SHOWN ON THIS PLAT. THE CENTERLINE OF RUNWAY 4-22, E.E. FAUST REGIONAL AIRPORT, (N. 92°13'E.) WAS USED AS A BEARING BASE FOR ALL BEARINGS SHOWN.

WYOMING REGISTRATION NO. 696 P.E. & L.S. *Darvin D. Dietz*
DARVIN D. DIETZ

APPROVAL

APPROVED THIS 2 DAY OF March, 1984 BY THE CITY COUNCIL OF CODY, WYOMING.

BY: *Dorise Miller, Jr.*
MAYOR
DORISE MILLER, JR.

ATTEST: *James S. Smiley*
CITY CLERK
JAMES S. SMILEY

STATE OF WYOMING } 55
COUNTY OF PARK

THE FOREGOING APPROVAL WAS ACKNOWLEDGED BEFORE ME BY DORISE MILLER, JR., MAYOR, AND JAMES S. SMILEY, CITY CLERK, THIS 22 DAY OF March, 1984.

WITNESS MY HAND AND OFFICIAL SEAL.
James S. Smiley
NOTARY PUBLIC

State of Wyoming } ss
County of Park }
I, _____, Notary Public,
do hereby certify that the foregoing
instrument was filed for record
on the 27 day of March, 1984,
at 1:15 o'clock P.M. in Book 986,
Page 988, of the records of Park County,
Wyoming, and that the same was
correctly recorded in Book 986,
Page 988, of the records of Park County,
Wyoming, on the 27 day of March, 1984.
James S. Smiley
215710

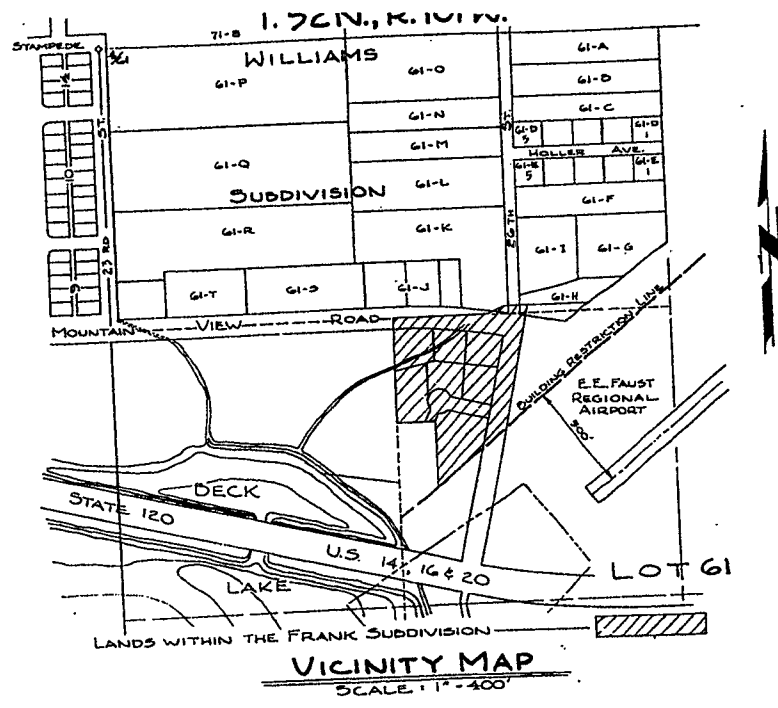

CERTIFICATE OF DEDICATION

STATE OF WYOMING } 55
COUNTY OF PARK

WE THE UNDERSIGNED, HEREBY CERTIFY THAT WE ARE THE OWNERS AND PROPRIETORS OF A PARCEL OF LAND IN THE E 1/2 NW 1/4 OF LOT 61, T. 52 N., R. 101 W. OF THE 6TH PM, CITY OF CODY, PARK COUNTY, WYOMING ACCORDING TO THE GOVERNMENT RESURVEY, SAID PARCEL BEING MORE PARTICULARLY DESCRIBED AS FOLLOWS:

BEGINNING AT THE NORTHWEST CORNER OF THE SE 1/4 NW 1/4 OF LOT 61, SAID POINT ALSO BEING ON THE SOUTH LINE OF THE WILLIAMS SUBDIVISION; THENCE N. 89°45'E. ALONG THE SOUTH LINE OF THE WILLIAMS SUBDIVISION, SAID LINE ALSO BEING THE NORTH LINE OF THE SAID SE 1/4 NW 1/4 OF LOT 61, FOR A DISTANCE OF 439.70 FEET MORE OR LESS TO AN ANGLE POINT ON THE SOUTH LINE OF SAID LOT 61-K OF THE WILLIAMS SUBDIVISION; THENCE N. 70°30'E. ALONG THE SOUTH LINE OF SAID LOT 61-K OF THE WILLIAMS SUBDIVISION FOR A DISTANCE OF 89.30 FEET MORE OR LESS TO AN ANGLE POINT ON THE SOUTH LINE OF SAID LOT 61-K OF THE WILLIAMS SUBDIVISION FOR N. 09°20'E. ALONG THE SOUTH LINE OF THE SAID WILLIAMS SUBDIVISION FOR A DISTANCE OF 126.40 FEET MORE OR LESS TO THE INTERSECTION POINT OF THE SOUTH LINE OF SAID WILLIAMS SUBDIVISION AND THE NORTHERLY PROJECTION OF THE EAST LINE OF 26TH STREET; THENCE S. 13°11'W. ALONG THE EAST LINE OF SAID 26TH STREET FOR A DISTANCE 945.30 FEET MORE OR LESS TO A POINT 500.0 FEET FROM AND AT RIGHT ANGLES TO THE E.E. FAUST REGIONAL AIRPORT RUNWAY 4-22 CENTERLINE; THENCE S. 92°13'W. ALONG A LINE 500 FEET NORTHWESTERLY OF AND PARALLEL TO SAID RUNWAY 4-22 CENTERLINE FOR A DISTANCE OF 433.80 FEET; THENCE N. 0°21'W. PARALLEL TO AND 175.0 FEET EAST OF THE WEST LINE OF SAID SE 1/4 NW 1/4 OF LOT 61 FOR A DISTANCE OF 297.30 FEET MORE OR LESS TO THE NORTHEAST CORNER OF A TRACT OF LAND DESCRIBED IN BOOK 378 AT PAGE 986, OF THE RECORDS OF PARK COUNTY, WYOMING; THENCE S. 05°45'W. PARALLEL TO AND 468.0 FEET SOUTH OF THE NORTH LINE OF SAID SE 1/4 NW 1/4 OF LOT 61, SAID POINT ALSO BEING THE NORTHWEST CORNER OF SAID TRACT OF LAND DESCRIBED IN BOOK 378 AT PAGE 986; THENCE N. 0°21'W. ALONG THE WEST LINE OF SAID SE 1/4 NW 1/4 OF LOT 61 FOR A DISTANCE OF 468.0 FEET MORE OR LESS TO THE POINT OF BEGINNING. SAID PARCEL OF LAND CONTAINS 7.68 ACRES MORE OR LESS. THE CENTERLINE OF RUNWAY 4-22 WAS USED AS THE BASE BEARING FOR THE ABOVE DESCRIBED PARCEL (N. 92°13'E.).

THAT WE HAVE CAUSED SAID DESCRIBED LAND TO BE SURVEYED AND PLATTED AS SHOWN HEREON AS THE FRANK SUBDIVISION; THAT THE SUBDIVISION AS APPEARS ON THIS PLAT IS WITH THE FREE CONSENT AND IN ACCORDANCE WITH THE DESIRES OF THE UNDERSIGNED OWNERS AND PROPRIETORS; AND THAT WE HEREBY DEDICATE AND SET APART THE STREETS SHOWN HEREON TO THE USE OF THE GENERAL PUBLIC FOREVER. WE HEREBY RELEASE AND RELINQUISH ALL RIGHTS OF HOMESTEAD.

IN WITNESS WHEREOF WE HAVE HERETO SET OUR HAND THIS 22 DAY OF March, 1984

CITY OF CODY, WYOMING
ATTEST: *James S. Smiley*
JAMES S. SMILEY, CITY CLERK

STATE OF WYOMING } 55
COUNTY OF PARK

THE FOREGOING CERTIFICATE OF DEDICATION WAS ACKNOWLEDGED BEFORE ME BY DORISE MILLER, JR., MAYOR, AND JAMES S. SMILEY, CITY CLERK, THIS 22 DAY OF March, 1984. WITNESS MY HAND AND OFFICIAL SEAL.
James S. Smiley
NOTARY PUBLIC

CITY OF CODY
CODY, WYOMING

PLAT SHOWING
THE
FRANK SUBDIVISION
WITHIN
E 1/2 NW 1/4, LOT 61
IN THE
CITY OF CODY, T. 52 N., R. 101 W.

GRAHAM, DIETZ & ASSOCIATES-CONSULTING ENGINEERS
CODY, WYOMING MARCH, 1984