

Book 9, Page 231, No. 19057

LOWRY'S Small Farms

Amended plat of Vogel's acre lots.

Town 53 north NW⁴ of NW⁴ Sec 33 Range 104 west

Hannah E Lowry owner

State of Wyoming
County of Big Horn SS.
I, C. E. Hayden, do hereby certify that the following plat is compiled from the notes of an actual survey made by me September 16, 1905. That the survey of the said tract was authorized by the owner. Witness my hand this 18th day of Sept. 1905.
C. E. Hayden
Surveyor

State of Wyoming
County of Big Horn SS.
I, Hannah E Lowry, do hereby certify that I am the owner of the above described tract of land, that I authorized the survey and plat of the same and that the accompanying plat correctly represents said survey. Witness my hand this 25th day of Sept 1905. I further certify that the sub-division of the NW⁴ of NW⁴ Sec 33 of 5th N 10th W is with my best consent according to my own signature & sworn to before me this 25th day of Sept. 1905.
H. E. Lowry
owner

My commission expires 7/25/06
H. E. Lowry

NW⁴ NW⁴ Sec. 33 53-101

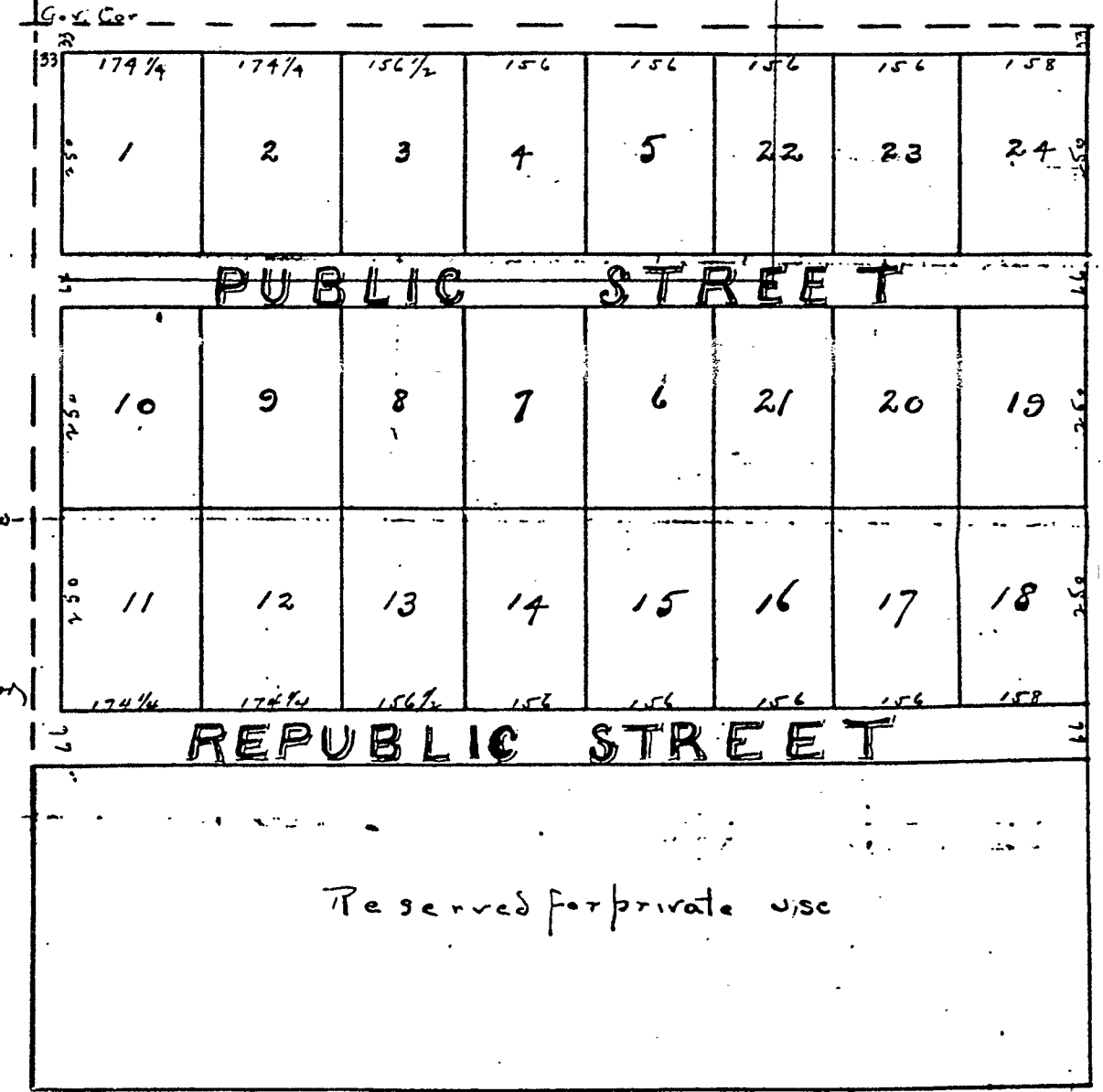

For records, see Big Horn County Transcript Book 9, Page 231 No. 19057

DB