

8 November  
7 1915 A.

Bertha M. Rousseau  
\$5.00 paid

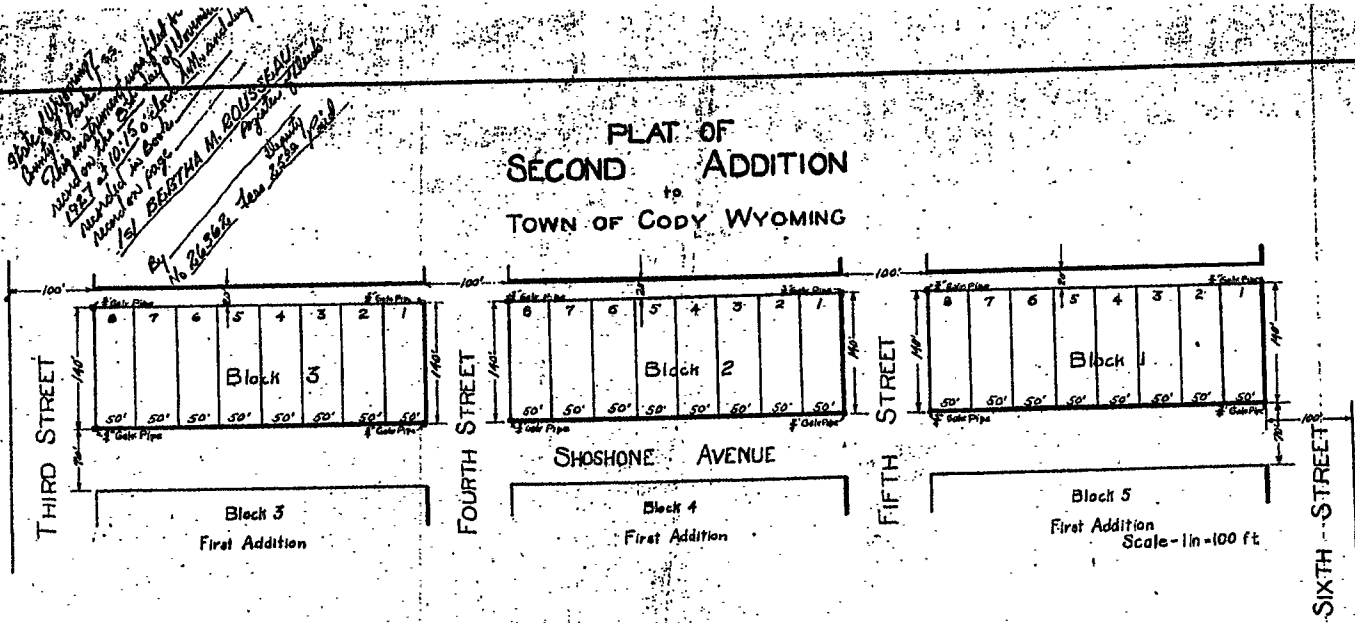

The foregoing subdivision which includes a tract of land described as follows: Being a part of the N<sup>2</sup> N<sup>2</sup> Sec 32, T. 53N, R. 101W of the 6<sup>th</sup> Principal Meridian, Original Government survey, and more particularly described as follows: Commencing at the intersection of the north line of Shoshone Avenue with the west line of 4<sup>th</sup> Street of the 1<sup>st</sup> Addition to the Town of Cody (according to the recorded plat thereof) said point of intersection being 70ft north of the east corner of Block numbered 3 of said 1<sup>st</sup> Add, thence north in the continuation of the west line of said 4<sup>th</sup> St - 140ft, thence west at right angles to the west line of said 4<sup>th</sup> St - 400ft to intersect the east line of 3<sup>rd</sup> St of said Town if said east line were produced north, thence south along said produced line - 140ft to intersect the north line of Shoshone Ave. aforesaid, thence east along said north line 400ft to the place of beginning; the same being shown on this plat as Block 3, Second Addition to the Town of Cody, as appears on this plat, is with the free consent and in accordance with the desires of the undersigned owners and proprietors.

The foregoing subdivision which includes a tract of land described as follows: Being a part of the N<sup>2</sup> N<sup>2</sup> Sec 32, T. 53N, R. 101W of the 6<sup>th</sup> P.M. Original Government survey, and more particularly described as follows: The tract of land 140ft north and south by 400ft east and west, lying directly north and across the street from Block numbered 4 of 1<sup>st</sup> Add to Town of Cody being more particularly described as follows: Commencing at the intersection of the north line of Shoshone Avenue with the west line of 5<sup>th</sup> Street of said Town, said point of intersection being 70ft north of the north-east corner of Block numbered 4 of said 1<sup>st</sup> Add, thence north in the continuation of the west line of said 5<sup>th</sup> St - 140ft, thence west at right angles to the west line of 5<sup>th</sup> St - 400ft to intersect the east line of 4<sup>th</sup> St of said Town if said east line were produced north, thence south along said produced line - 140ft to intersect the north line of Shoshone Ave. aforesaid, thence east along said north line 400ft to the place of beginning, being the same tract of land which is shown hereon as Block 2, Second Addition to the Town of Cody, and also hereby conveying the tract of land 140ft north and south by 400ft east and west, lying directly north and across the street from Block numbered 5 of the 1<sup>st</sup> Addition to the Town of Cody, being more particularly described as follows: Commencing at the intersection of the north line of Shoshone Ave. with the west line of 6<sup>th</sup> St of said Town, said point of intersection being 70ft north of the north-east corner of Block numbered 5 of said 1<sup>st</sup> Add, thence north in continuation of the west line of said 6<sup>th</sup> St - 140ft, thence west at right angles to the west line of said 6<sup>th</sup> St - 400ft to intersect the east line of 5<sup>th</sup> St of said Town, if said east line were produced north, thence south along said produced line - 140ft to intersect the north line of Shoshone Ave. aforesaid, thence east along said north line 400ft to the place of beginning, being the same tract of land which is shown hereon as Block 1, Second Addition to the Town of Cody, as appears on this plat, is with the free consent and in accordance with the desires of the undersigned owners and proprietors.

Witness  
 Lloyd Stuckey  
 Marguerite Stuckey  
 STATE OF WYOMING  
 COUNTY OF PARK  
 I, Robert, a Notary Public within and for the County and State aforesaid, do hereby certify that Lloyd Stuckey and Marguerite Stuckey, his wife, to me personally known to be the persons whose names are subscribed to the foregoing instrument, appeared before me this day in person and acknowledged that they signed, sealed and delivered the said instrument as their free and voluntary act and deed for the uses and purposes therein set forth.  
 Witness my hand and seal this 1<sup>st</sup> day of Nov. A.D. 1927.  
 My commission expires June 17, 1929. NOTARY PUBLIC

Witness  
 Howard F. Bell  
 STATE OF WYOMING  
 COUNTY OF PARK  
 Howard F. Bell, being first duly sworn according to law, deposes and says that the above map is an accurate representation of a survey made by him September 19, 20, 21, 1927 of a part of the N<sup>2</sup> N<sup>2</sup> Sec 32, T. 53N, R. 101W of the 6<sup>th</sup> P.M. Original Government survey, and that the said survey accurately embraces the lands as described in the above certificates of the owners.  
 Subscribed and sworn before me this 1<sup>st</sup> day of November, 1927.  
 My commission expires June 17, 1929. NOTARY PUBLIC

STATE OF WYOMING  
 COUNTY OF PARK  
 I, Robert, a Notary Public within and for the County and State aforesaid, do hereby certify that S.S. Kuentzel and Olive Kuentzel, his wife, to me personally known to be the persons whose names are subscribed to the foregoing instrument, appeared before me this day in person and acknowledged that they signed, sealed and delivered the said instrument as their free and voluntary act and deed for the uses and purposes therein set forth.  
 Witness my hand and seal this 1<sup>st</sup> day of Nov. A.D. 1927.  
 My commission expires June 17, 1929. NOTARY PUBLIC

STATE OF WYOMING  
 COUNTY OF PARK  
 On this 2<sup>nd</sup> day of Nov., 1927, before me, the undersigned Notary Public, personally appeared Samuel C. Parks, Jr., who being by me first duly sworn on oath according to law did depose and say that he is attorney-in-fact for Norman P. DeMauriac; that he signed, sealed and delivered the within and foregoing instrument as his free, and voluntary act and deed and the free and voluntary act and deed of the said Norman P. DeMauriac under and by virtue of a certain power of attorney duly made and executed by the said Norman P. DeMauriac on the 14<sup>th</sup> day of September, 1927.  
 In Witness Whereof I have hereunto set my hand and Notarial Seal the day and year last above written.  
 My commission expires June 17, 1929. NOTARY PUBLIC

NOTE  
 Reference is made to deeds on file in the office of the County Clerk and ex-officio Register of Deeds, Park County, Wyoming, from the Lincoln Land Company to the Public, conveying all streets and alleys shown on this plat which were not previously dedicated to the Public by said Lincoln Land Company.