

*Subdivided into  
Units 15-17 + Tot  
6, show E #2*

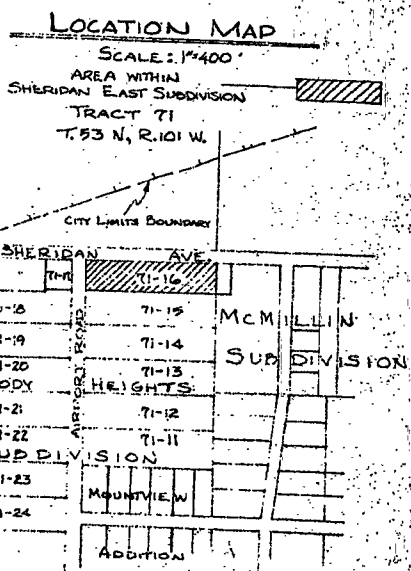

SCALE: 1"=30'

LEGEND

- SUBDIVISION BOUNDARY SHOWN THUS -----
- PROPOSED LOT LINES SHOWN THUS -----
- PROPOSED BUILDING LINES SHOWN THUS -----
- SIDEWALK EASEMENTS SHOWN THUS -----
- UTILITY EASEMENTS SHOWN THUS -----
- SURVEY MONUMENTS FOUND IN PLACE SHOWN THUS ●
- PROPERTY CORNERS FOUND IN PLACE SHOWN THUS ○
- PROPERTY CORNERS SET THIS SURVEY (REBAR W/ALUM. CAP) SHOWN THUS ○
- ORIGINAL CORNER MARKS TO BE PRESERVED GREAT DIMENSIONS SHOWN THUS ○

CERTIFICATE OF DEDICATION

STATE OF WYOMING }  
COUNTY OF PARK } SS

WE, THE UNDERSIGNED, HEREBY CERTIFY THAT WE ARE THE OWNERS AND PROPRIETORS OF TRACT 71-16 OF THE CODY HEIGHTS SUBDIVISION, LESS THAT PORTION OF AIRPORT ROAD AND SHERIDAN AVENUE THAT WERE DEDICATED TO THE PUBLIC USE ON THE ORIGINAL CODY HEIGHTS SUBDIVISION PLAT, WITHIN TRACT 71, T. 53 N., R. 101 W. OF THE 6TH PM., ACCORDING TO THE GOVERNMENT RESURVEY; CAUSED SAID DESCRIBED LAND TO BE RESUBDIVIDED, SURVEYED AND PLATTED AS SHOWN HEREON AS THE SHERIDAN EAST SUBDIVISION AND THAT THE RESUBDIVISION AS APPEARS ON THIS PLAT IS WITH THE FREE CONSENT AND IN ACCORDANCE WITH THE DESIRES OF THE UNDERSIGNED OWNERS AND PROPRIETORS.

*Russ Wiedekamp*  
RUSS WIEDEKAMP - PRES.

PARK COUNTY LAND COMPANY

*Harold Matteson*  
HAROLD MATTESON - SEC.

CERTIFICATE OF SURVEYOR

STATE OF WYOMING }  
COUNTY OF PARK } SS

I, LEE GRAHAM OF CODY, WYOMING HEREBY CERTIFY THAT DURING THE PERIOD FROM AUG. 14, 1960 TO SEPT. 29, 1961 THE SHERIDAN EAST SUBDIVISION WAS SURVEYED BY ME OR UNDER MY DIRECTION; THAT SAID RESUBDIVISION IS CORRECTLY DESCRIBED IN THE OWNER'S CERTIFICATE OF DEDICATION ON THIS PLAT WHICH IS DRAWN TO A SCALE OF 1 INCH = 30 FEET. THE DIMENSIONS OF LOTS ARE GIVEN IN FEET AND DECIMALS OF A FOOT, AND ANY SURPLUS OR DEFICIENCY IS DISTRIBUTED UNIFORMLY IN PROPORTION TO THE MEASUREMENTS SHOWN ON THIS PLAT. LOT CORNERS ARE AS SHOWN ON THIS PLAT. THE INTERIOR LOT LINES SHOWN ARE INTENDED TO PASS DIRECTLY THROUGH THE PARTY WALLS BETWEEN EACH UNIT OF THE TOWN HOUSE STRUCTURE. EACH LOT BEARS ITS OWN NUMBER.

WYOMING REGISTRATION NO. 382 RE. #LS  
*Lee Graham*  
LEE GRAHAM

STATE OF WYOMING }  
COUNTY OF PARK } SS

THE FOREGOING CERTIFICATE OF DEDICATION WAS ACKNOWLEDGED BEFORE ME BY RUSS WIEDEKAMP AND HAROLD MATTESON THIS 23<sup>RD</sup> DAY OF OCT., 1961. WITNESS MY HAND AND OFFICIAL SEAL.

MY COMMISSION EXPIRES May 29, 1962

*Lawrence D. Dietz*  
NOTARY PUBLIC

APPROVALS

APPROVED THIS 23<sup>RD</sup> DAY OF OCT. 1961, BY THE CITY COUNCIL OF CODY, WYOMING.

*Dorise Miller*  
DORISE MILLER, JR. - MAYOR

ATTEST  
*James S. Smiley*  
JAMES S. SMILEY - CITY CLERK

STATE OF WYOMING }  
COUNTY OF PARK } SS

THE FOREGOING WAS ACKNOWLEDGED BEFORE ME BY DORISE MILLER, JR. AND JAMES S. SMILEY, CITY CLERK THIS 23<sup>RD</sup> DAY OF OCTOBER, 1961. WITNESS MY HAND AND OFFICIAL SEAL.

MY COMMISSION EXPIRES May 29, 1962

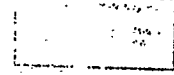

NOTARY PUBLIC

PARK COUNTY LAND COMPANY  
CODY & POWELL, WYOMING

PLAT SHOWING  
**SHERIDAN EAST SUBDIVISION**  
(FIRST FILING)

A RESUBDIVISION OF TRACT 71-16 OF THE CODY HEIGHTS SUBDIVISION  
TRACT 71, T. 53 N., R. 101 W.

GRAHAM, DIETZ & ASSOCIATES

13 October 1961  
*Lee Graham*  
1961