

Detail Map.
Scale: 1 Inch = 200 feet.

Certificate of Surveyor.

STATE OF WYOMING } ss.
County of Park.

I, William H Greaver, of Cody, Wyoming, hereby certify that this plat of the Shoshone Subdivision, was made from the notes of an actual survey made by me, on the 18th of December, 1971, on the 7th, 8th and 20th of January, 1972, and on the 25th of March, 1972, and that this plat accurately reflects the results of said survey; that said Shoshone Subdivision is described on this plat in the owners Certificate of Dedication, and that the plat is drawn to a scale of 1 Inch to 200 feet. Lot corners are marked as shown on the legend. Widths of County roads and streets, and dimensions of the lots are given in feet and decimals of feet. Any surplus or deficiency is distributed uniformly in proportion to the dimensions shown on the plat. Each lot bears its respective number.

William H. Greaver,
William H. Greaver,
Surveyor,
Cody, Wyoming.

Wyo. Reg. No. 135, L.S.

Certificate of Dedication.

STATE OF WYOMING } ss.
County of Park.

This certifies that Norman H. Johnson, and Julia E. Johnson, husband and wife, of Powell, Wyoming, are the owners and proprietors of a tract of land, described as the north 1020.0 feet of the west 652.57 feet of Lot 51-J, Lot 51, Res., T.55N, R.99W, & that Muriel E. Franklin, and Alpha F. Franklin, husband and wife, of Powell, Wyoming, are the owners and proprietors of a tract of land which consists of the remainder of the Shoshone Subdivision, as shown on this plat, said subdivision being located south of Powell, Wyoming, and which may be described as follows: - Beginning at the Northeast Corner of Lot 51-J, in Lot 51, Resurvey, in Township 55 North, Range 99 West of the Sixth Principal Meridian, in Park County, Wyoming, thence bearing due South, parallel with the east boundary of said Lot 51, Resurvey, for a distance of 2640.0 feet, thence bearing North 89°54' West, along the south boundary of Lot 51-O, for a distance of 1312.57 feet,.....

to the southwest corner of said Lot 51-O, thence bearing due North, along the West boundary of said Lots 51-O & 51-J, for a distance of 2640.0 feet, to the Northwest Corner of said Lot 51-J, thence bearing South 89°54' East, along the north boundary of said Lot 51-J, for a distance of 1312.57 feet, more or less, to the northeast corner of said Lot 51-J, and to the point of beginning, said tract of land to contain 79.547 acres, more or less.

This further certifies that the owners have caused this tract of land to be surveyed and platted as the Shoshone Subdivision, as shown on this plat and on the Certificate of Surveyor; and that the streets, as shown on this plat, are hereby dedicated to the public use, forever.

In witness whereof, the said owners have hereunto affixed their signatures, on this 29th day of March, 1972.

Norman H. Johnson
Norman H. Johnson.
Julia E. Johnson
Julia E. Johnson.

Muriel E. Franklin
Muriel E. Franklin.
Alpha F. Franklin
Alpha F. Franklin.

STATE OF WYOMING } ss.
County of Park.

The foregoing instrument was acknowledged before me, on this 29th day of March, 1972, witness my hand and official seal.

Notary Public
Notary Public.

My commission expires: 12-1-72

Legend:—

- Lot corners marked by 3/4" x 14" Iron pipe, driven to ground level, show thus:
- Subdivision boundary lines, shown thus:
- Roads and drives shown thus:

Note.

Areas given for each of the lots are calculated to exclude roads, and are shown thus: 7634 Ac.
Areas of lots including roads are shown thus: (9,132 Ac.)

Approval:

Approved this 16 day of June, 1972, by the commissioners of Park County, Wyoming, subject to the provisions of Section 5, Park County Policy on the approval of subdivision and townsite plats, as adopted August 7th, 1962.

Alvin Stutzman
by: Chairman.
Attest: Jana L. Larson
County Clerk.

Seal:

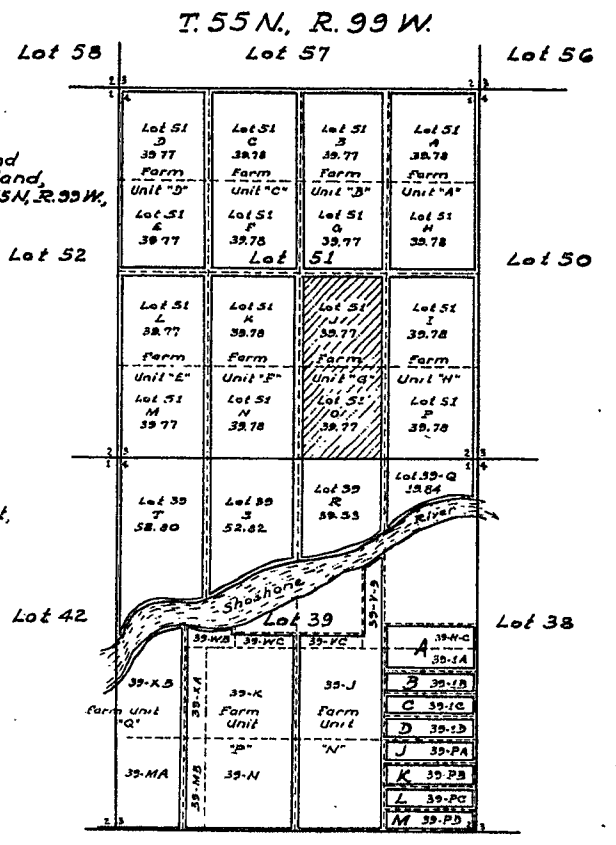

Location Map.
Scale: 1 Inch = 1320 feet.

Shoshone Subdivision.

located in
Lots 51-J & 51-O,
of
Lot 51, Resurvey,
Township 55 North, Range 99 West,
of the
Sixth Principal Meridian,
in
Park County, Wyoming.
William H. Greaver,
Surveyor,
Cody, Wyoming.

S-619.