

# VAN-TYTLER ADDITION TO THE TOWN OF GARLAND

State of Wyoming  
County of Big Horn. SS

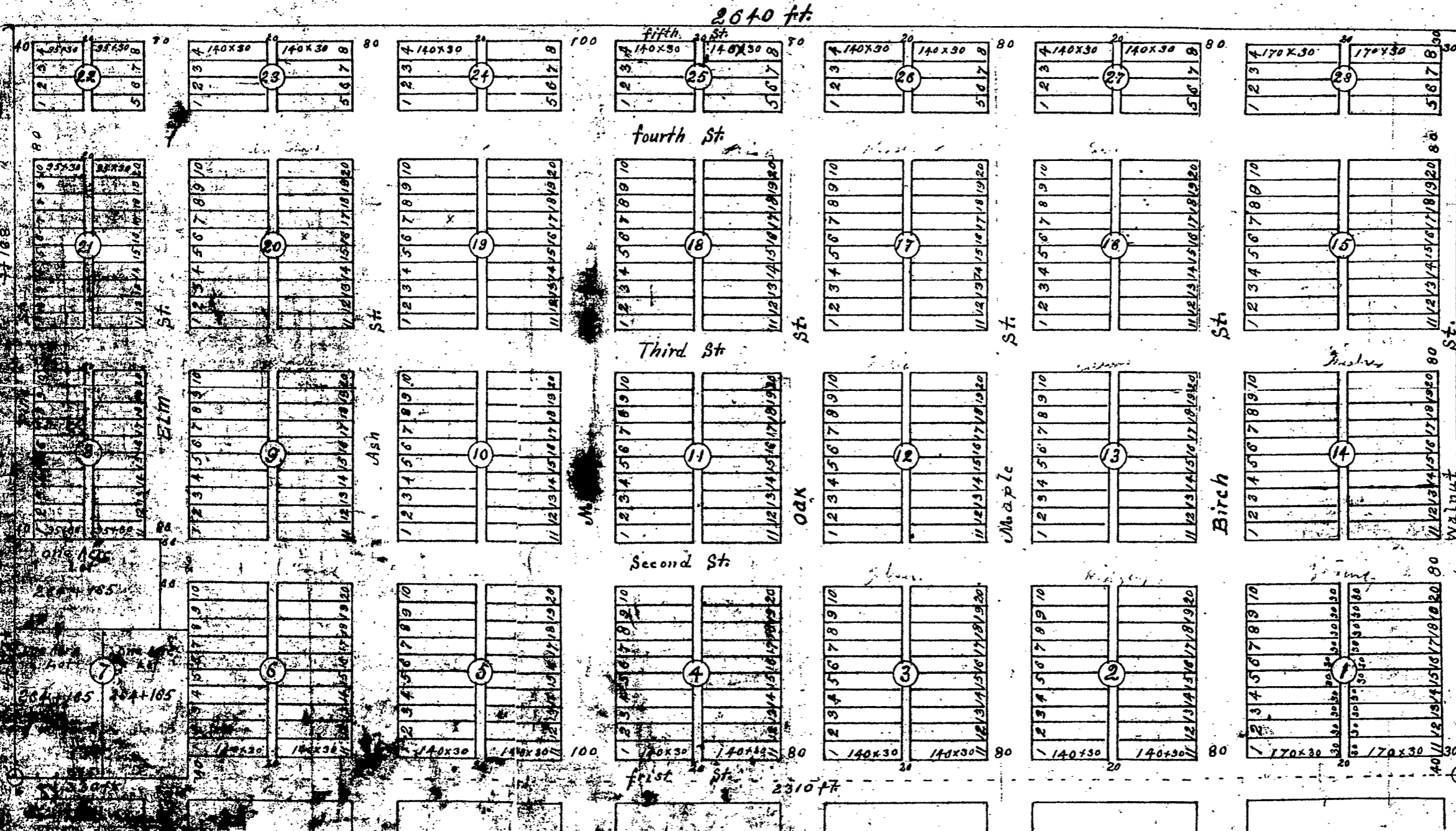

I hereby Certify that this is a true and correct Plat of the Van-Tytler addition to the Town of Garland in Big Horn County, State of Wyoming, drawn to a scale of 150 feet to one inch. That the same is situated upon and comprises all of the following described land except the acre lots in the S.W. corner of the  $1\frac{1}{2}$  SW  $\frac{1}{4}$  of Sec. 34, T. 56 N. R. 98 W. with the following notes: The streets are laid out at right angles to one another. Stakes are driven at corners of all blocks. All dimensions and distances are indicated in feet on the plat. Each block and lot bears its own number. The lots are marked at end of each lot. The width of streets and alleys are marked on plat.

Surveyed and

Witness my hand and seal this 6th day of July 1907.

Jos. H. Newell

P. D. Bryan, Wyo.

Scale 150 feet to one Inch.

N.E. corner of Garland