

### Certificate of Surveyor.

STATE OF WYOMING } ss.  
County of Park.

I, William H. Greaver, of Cody, Wyoming, hereby certify that this plat of the Wood Second Addition, within Blocks 6, 7, 8, 9 and 10 of the Wood First Addition, to the Town of Powell, Wyoming, was made from the notes of an actual survey, made by me on the 21st, 23rd, and 30th of March, 1960, and that this plat accurately reflects the results of said survey; that said subdivision is described on this plat in the owners Certificate of Dedication, and that the plat is drawn to a scale of 1 inch = 100 feet. Lot corners are marked as described on the plat. Widths of alleys and streets and dimensions of lots are given in feet. Any surplus or deficiency is distributed uniformly in proportion to the dimensions shown on the plat. Each block and lot bears its respective number.

*William H. Greaver*  
William H. Greaver,  
Surveyor.

Wyo. Reg. No. 135.

### Certificate of Dedication.

STATE OF WYOMING } ss.  
County of Park

This certifies that Norman Wood, and Ethel Wood, husband and wife, are the owners of all of this tract of land, shown on this plat as the "Wood Second Addition to the Town of Powell, Wyoming," in Lot 75-1, Township 55 North, Range 99 West of the Sixth Principal Meridian, in Park County, Wyoming, and which may be described as being the west 671.20 feet of said Lot 75-1, and may be more particularly described as follows: Beginning at the Northwest Corner of said Lot 75-1, thence South 89°51' East for 671.20 feet, to the east side of Cory Street produced North, thence South 0°02' West for 1320.3 feet, along the East side of Cory Street, to the south produced North, thence South 0°02' West for 1320.3 feet, to the point of beginning, said parcel of land to contain 20.34 acres, more or less. This further certifies that this plat amends and supercedes that part of the Wood First Addition, which lies in Blocks 6, 7, 8, 9 and 10, said amendment conforms to the plat shown hereon. This further certifies that the owners have caused this tract to be surveyed and platted as shown hereon, and as described in the Certificate of Surveyor, and that the owners do hereby dedicate to the public use, such streets, alleys, and parks as are shown on this plat. This subdivision is made with the free consent, and in accordance with the desires and wishes of the owners. Homestead rights are hereby relinquished.

In witness whereof, said owners have hereunto affixed their signatures, this 4th day of April, 1960.

*Norman Wood*  
Norman Wood.

*Ethel Wood*  
Ethel Wood.

STATE OF WYOMING } ss.  
County of Park

I, *John Metzler*, a notary public in and the county aforesaid, hereby certify that Norman Wood and Ethel Wood, personally known to me to be the persons whose names are subscribed to the foregoing Certificate of Dedication, appeared before me this day in person and acknowledged that they signed, sealed and delivered said instrument as their free and voluntary act for the uses and purposes, therein set forth.

Given under my hand and notarial seal, this 4th day of April 1960.

Approved:

Park County, Wyoming.

Board of County Commissioners, Park County, Wyoming;  
this \_\_\_\_\_ day of \_\_\_\_\_ 1960.

Attest:

*Harold Staudt*  
County Clerk.

Approved:

Town of Powell, Wyoming;

Town Council of the Town of Powell, Wyoming;  
this 2nd day of May 1960.

Attest:

*Homer C. Mann*  
Town Clerk.

My Commission expires: May 14, 1962

State of Wyoming, }  
County of Park, } ss.  
This instrument was filed for record  
on the 7 day of May  
1960, at 8:45 a.m. and  
daily recorded in Deeds  
records on page 166.

Register of Deeds  
By *W. H. Greaver*  
Deputy  
No. 98751. Fee, \$ 15.00

Plat  
of the  
Wood Second Addition,  
to the  
Town of Powell, Wyoming,

within  
Lot 75-1,  
Township 55 North, Range 99 West,  
of the  
Sixth Principal Meridian,  
in  
Park County, Wyoming.

April 1960.

Scale: 1 inch = 100 feet.

*William H. Greaver*  
Surveyor,  
Cody, Wyoming.

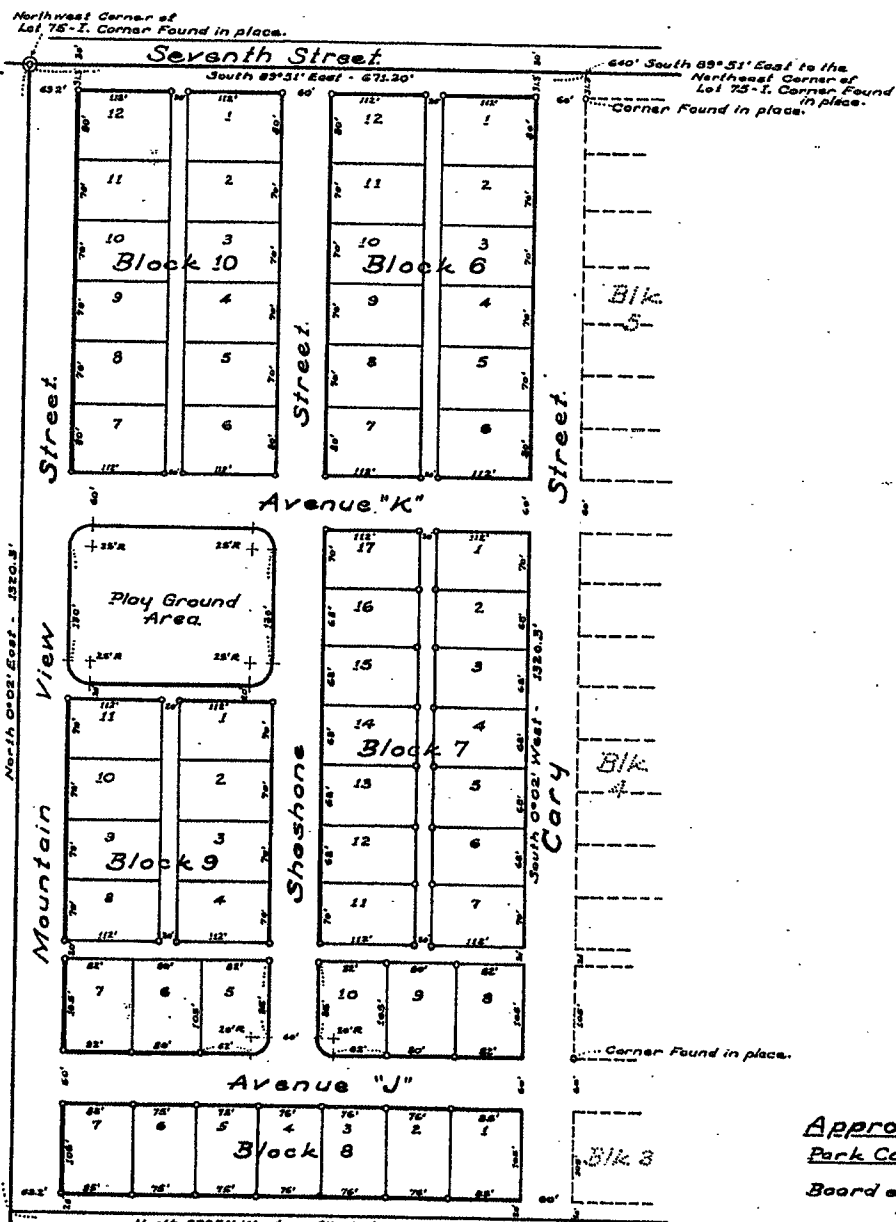

#### Legend:-

- 3/4 Iron Pipe Corners set by this survey, driven to ground level;
- Northwest Corner of Lot 75-1, found in place;
- Lot lines for Wood Second Addition shown thus:
- Lot lines for Wood First Addition shown thus:
- Dimensions given in feet and decimals of feet:

